

Part number

PHW 12565 SV



Mobile plug, PLUSO HEAVY DUTY series, 3 poles + N + PE, 6 h (red), 125 A, 380 ÷ 415 V, straight

Product description

Product type	Plug Mobile
Series	PHW...SV, PLUSO HEAVY DUTY
Connection type	Screw terminal connection
N. of poles	3 poles + N + 
Clock position	6
Specification	Straight

Technical data

Current	125 A
Voltage	380 ÷ 415 V
IP degree of protection	IP66 / IP67
Further technical details	
Weight	1.710,00 g
Operating temperature range (min, max)	-40°C ... +100°C

Material properties

Colour	RAL 7012 grey, RAL 3000 red
RoHs conformity	Compliant with exemption 6(c): copper alloy containing up to 4% lead by weight
China RoHs - EFUP	50
REACH SVHC substances	Yes Lead
SCIP number	Ca7de37f-add8-4b77-9861-279c94903ade

Approvals / Standards

Reference standard	EN 60309-1 and -2
---------------------------	-------------------

General ordering information

EAN13 code	8015747144551
-------------------	---------------

Packaging Information

Packaging length	330,00 mm
Packaging height	170,00 mm
Packaging width	230,00 mm
Packaging weight	3,83 kg
Packaging volume	12,90 dm ³
Packaging description	Carton box
Packaging quantity	2 Pcs
Packaging EAN code	8015747202923
Sub-packaging weight	1,92 kg
Sub-packaging description	Plastic packaging
Sub-packaging quantity	1 Pcs
Sub-packaging EAN barcode	8015747144735

Part number

PHW 12565 SV



Catalogue drawings

(63 / 125A) PHW ... SV

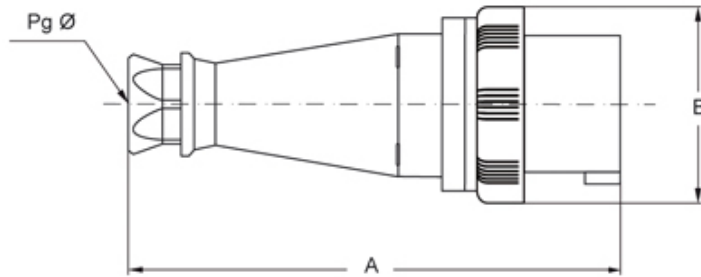

PHW...SV		A	B	Pg ø
63A	2P+⊕	264,5	112	36
	3P+⊕	264,5	112	36
	3P+N+⊕	264,5	112	36
125A	2P+⊕	310	130	2"gas
	3P+⊕	310	130	2"gas
	3P+N+⊕	310	130	2"gas

Notes

Dimensions shown in mm are not binding and may be changed without notice.

-
- Temperature range: from -40 °C to +100 °C
 - Compliant with EN 60309-1 and -2
 - Enclosure, insert and locking ring in insulating, thermoplastic, self-extinguishing material
 - PHW...SV types (IP66/IP67), entry with cable gland colour coded according to the operating voltage, RAL 9005 black enclosure, locking ring with gasket colour coded according to the operating voltage
 - Terminals with retained screws
 - Stainless steel insert fixing screws
 - Nickel-plated contacts as standard
-