

Product designation	Rotary cam switches		
Product type designation	GF10		
General characteristics			
Switching diagram	94 - Multi-step 1-2-3-4 3 poles		
N° of elements	6		
Mounting form	U - Front mounting with black handle		
Contact characteristics			
Rated insulation voltage U_i	IEC/EN	V	480
	UL/CSA	V	240
Rated impulse withstand voltage U_{imp}		kV	4
Conventional free air thermal current I_{th}	IEC/EN	A	10
	UL/CSA	A	10
Rated operational voltage		V	480
Rated operational impulse voltage		kV	4
Maximum fuse size for short-circuit protection I_n (gG)	10kA	A	16
Rated short time current I_{cw}	1s	A	250
Conductivity	10/5 mA/V		
Operational current I_e IEC/EN			
AC1/AC21A		A	10
AC15	110V	A	5
	220/230V	A	3
	380/400V	A	2
Rated operational power in AC			
Three-phase AC-3	220/230V	kW	1.5
	380/440V	kW	2.2
Single-phase AC-3	110V	kW	0.3
	220/230V	kW	0.55
	380/440V	kW	0.75
Three-phase AC23A	220/230V	kW	1.8
	380/440V	kW	3
Single-phase AC23A	110V	kW	0.7
	220/230V	kW	0.75
	380/440V	kW	1.1
Rated operational current in DC			
DC21A	48V	A	10
	60V	A	7
	110V	A	2
	220V	A	0.7

	440V	A	0.2
DC13	24V	A	3
	48V	A	3
	60V	A	2
	110V	A	1
	220V	A	0.3
	440V	A	0.1
Power dissipation		W	0.4
Mechanical features			
Terminals screw			2.5M
Tightening torque for terminals max		Nm	0.4
Conductor size			
AWG - Rigid cable	min	AWG	20
	Max	AWG	14
AWG - Flexible cable	min	AWG	20
	Max	AWG	14
Conductor size (IEC) - Flexible cable	min	mm ²	0.5
	Max	mm ²	1.5
Conductor size (IEC) - Rigid cable	min	mm ²	0.5
	Max	mm ²	1.5
Mechanical life		cycles	1x10 ⁶
UL technical data			
Motor power for direct-on-line control			
for three-phase motor	240V	HP	2
for single-phase motor	240V	HP	0.75
Ambient conditions			
Temperature			
Operating temperature	min	°C	-25
	max	°C	+55
Storage temperature	min	°C	-40
	max	°C	+70
Resistance & Protection			
Frontal IP degree			IP40
Terminals IP degree			IP20
Dimensions			

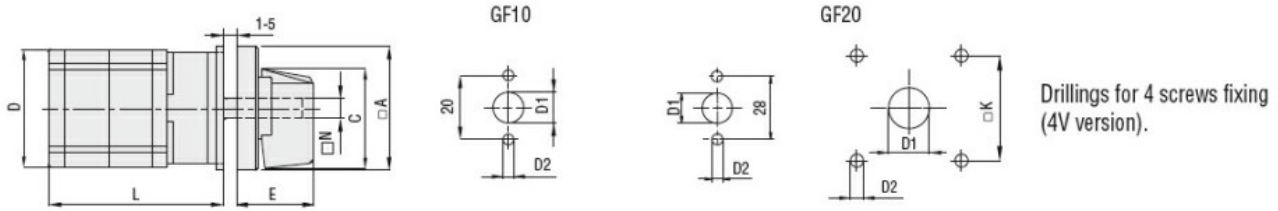

Series	Dimensions								L Number of elements											
	□A	C	D	ØD1	ØD2	E	□K	N	1	2	3	4	5	6	7	8	9	10	11	12
GF10	30	24	29	9	3.2	18.5	-	Ø5	40	52	64	76	88	100	112	124	-	-	-	-
GF20	48	39.5	36	12	5	26.5	36	□6	44	57.5	71	84.5	98	111.5	125	138.5	152	165.5	179	192.5

Wiring diagrams

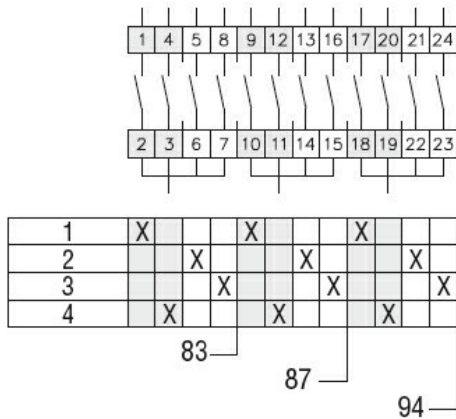

Certifications and compliance

Compliance

- CSA C22.2 n° 14
- IEC/EN/BS 60947-1
- IEC/EN/BS 60947-3
- IEC/EN/BS 60947-5-1
- UL60947-4-1

Certificates

- cULus
- EAC

ETIM classification

ETIM 8.0

EC001029 -
Selector switch,
complete