



## Metric Conductor, One-Hole, Standard Barrel with Window Lug

For Use with Class 2R Rigid Strand and Flexible Strand Class 5F and 6F Copper Conductors

### Type LCMA

- Inspection window to visually assure full conductor insertion
- Tin-plated to inhibit corrosion
- UL Listed and CSA Certified to 35 kV\*\* and temperature rated to 90°C when crimped with Panduit tools and dies
- Approved for Marine use by American Bureau of Shipping
- Meets EN61238-1:2003/IEC 61238-1:2003 Class B for 4mm<sup>2</sup>-240mm<sup>2</sup> Class 2r wire sizes
- Class 2r, Class 5f and Class 6f wire sizes and stud hole size marked on connector for selection and installation
- CE compliant sizes 4mm<sup>2</sup>-240mm<sup>2</sup> Class 2r wire sizes
- Product information marked on connector for selection and installation
- Rounded tongue for use in tight spaces
- Internally beveled wire entry for fast and easy installation

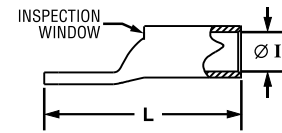
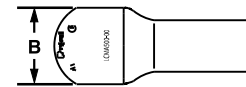
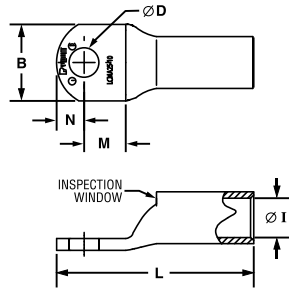

Part Number	Copper Conductor Size Class 2r (mm <sup>2</sup> )	Copper Conductor Size class 5f/6f*** (mm <sup>2</sup> )	Stud Hole Size (mm)	Figure Dimensions (mm)					Std. Pkg. Qty.
				ØI	B	M	N	L	
LCMA2.5-4-C	2.5	—	M4	2.4	8	5	4	18	100
LCMA6-5-C	4 – 6	4 – 6 <sup>^</sup>	M5	3.8	10	7.8	6.2	27.5	
LCMA6-6-C	4 – 6	4 – 6 <sup>^</sup>	M6	3.8	10.8	7.8	6.2	27.5	
LCMA6-8-C	4 – 6	4 – 6 <sup>^</sup>	M8	3.8	13	8	8	30.5	
LCMA6-10-C	6	4-6 <sup>^</sup>	M10	3.8	15	11	9	34.5	
LCMA10-5-C	10	—	M5	4.5	11	9.8	6	30.8	
LCMA10-6-C	10	—	M6	4.5	11	9.8	6	30.8	
LCMA10-8-C	10	—	M8	4.5	13	8.5	8	30.8	
LCMA10-10-C	10	—	M10	4.4	14.5	8.5	8	30.8	
LCMA10-12-C	10	—	M12	4.36	20	13	10.5	40.5	
LCMA16-5-C	16	10	M5	5.5	13	10.3	6.5	34.5	
LCMA16-6-C	16	10	M6	5.5	13	10.3	6.5	34.5	
LCMA16-8-C	16	10	M8	5.5	13	10.3	6.5	34.5	
LCMA16-10-C	16	10	M10	5.5	15	10.2	8	36.7	
LCMA25-5-C	25	16	M5	6.9	14	10	8	37	
LCMA25-6-C	25	16	M6	6.9	14	10	8	37	
LCMA25-8-C	25	16	M8	6.9	15.5	10	8	37	
LCMA25-10-C	25	16	M10	6.9	15.5	10	8	37	
LCMA35-6-C	35	25	M6	8.2	15.5	12.3	8.5	42	
LCMA35-8-C	35	25	M8	8.2	15.5	12.3	8.5	42	
LCMA35-10-C	35	25	M10	8.2	15.5	12.3	8.5	42	
LCMA35-12-C	35	25	M12	8.2	21.5	14.5	11.5	48	
LCMA50-6-L	50	35	M6	9.8	18	11.5	10	46.5	
LCMA50-8-L	50	35	M8	9.8	18	11.5	10	46.5	
LCMA50-10-L	50	35	M10	9.8	18	11.5	10	46.5	
LCMA50-12-L	50	35	M12	9.8	23	14	11	50	

Visit [www.panduit.com/tools](http://www.panduit.com/tools) for tool and die information.

\*\*Consult cable manufacturer for voltage stress relief instructions with applications greater than 2000 V.

\*\*\*Not CE compliant and not tested to EN 61238-1:2003/IEC 61238-1:2003 for terminations with metric Class 5f or Class 6f flexible stranded conductor.

<sup>^</sup>Class 5f conductor only

Continued on next page

B1

**Metric Conductor, One-Hole, Standard Barrel with Window Lug (continued)**

B2

Part Number	Copper Conductor Size Class 2r (mm <sup>2</sup> )	Copper Conductor Size class 5f/6f*** (mm <sup>2</sup> )	Stud Hole Size (mm)	Figure Dimensions (mm)					Std. Pkg. Qty.
				ØI	B	M	N	L	
LCMA70-6-L	70	50	M6	11.5	20.8	14.5	11.5	53.5	50
LCMA70-8-L	70	50	M8	11.5	20.8	14.5	11.5	53.5	
LCMA70-10-L	70	50	M10	11.5	20.8	14.5	11.5	53.5	
LCMA70-12-L	70	50	M12	11.5	20.8	14.5	11.5	53.5	
LCMA95-6-L	95	70	M6	13.5	24.5	15	13.5	60.5	
LCMA95-8-L	95	70	M8	13.5	24.5	15	13.5	60.5	
LCMA95-10-L	95	70	M10	13.5	24.5	15	13.5	60.5	
LCMA95-12-L	95	70	M12	13.5	24.5	15	13.5	60.5	
LCMA95-16-L	95	70	M16	13.5	24.5	15	13.5	60.5	
LCMA120-8-L	120	95	M8	15.2	27.5	15.5	14.5	65	
LCMA120-10-L	120	95	M10	15.2	27.5	15.5	14.5	65	
LCMA120-12-L	120	95	M12	15.2	27.5	15.5	14.5	65	
LCMA120-14-L	120	95	M14	15.2	27.5	15.5	14.5	65	
LCMA120-16-L	120	95	M16	15.2	27.5	15.5	14.5	65	
LCMA150-8-X	150	120	M8	16.5	30.5	18	16.5	70.5	10
LCMA150-10-X	150	120	M10	16.5	30.5	18	16.5	70.5	
LCMA150-12-X	150	120	M12	16.5	30.5	18	16.5	70.5	
LCMA150-16-X	150	120	M16	16.5	30.5	18	16.5	70.5	
LCMA150-20-X	150	120	M20	16.5	30.5	22	16.5	74	
LCMA185-8-X	185	150	M8	18.6	33.5	16.5	17.5	72.5	
LCMA185-10-X	185	150	M10	18.6	33.5	16.5	17.5	72.5	
LCMA185-12-X	185	150	M12	18.6	33.5	16.5	17.5	72.5	
LCMA185-16-X	185	150	M16	18.6	33.5	16.5	17.5	72.5	
LCMA185-20-X	185	150	M20	18.6	33.5	21	17.5	77	
LCMA240-10-X	240	185	M10	20.8	37.5	21	19.5	86.5	
LCMA240-12-X	240	185	M12	20.8	37.5	21	19.5	86.5	
LCMA240-16-X	240	185	M16	20.8	37.5	21	19.5	86.5	
LCMA240-20-X	240	185	M20	20.8	37.5	21	19.5	86.5	
LCMA300-10-5	300	240	M10	23.5	42.5	22	20	94.5	5
LCMA300-12-5	300	240	M12	23.5	42.5	22	20	94.5	
LCMA300-16-5	300	240	M16	23.5	42.5	22	20	94.5	
LCMA300-20-5	300	240	M20	23.5	42.5	22	20	94.5	
LCMAX300-10-5	—	300 <sup>^</sup>	M10	26.2	48.0	26.5	23.5	107.0	
LCMAX300-12-5	—	300 <sup>^</sup>	M12	26.2	48.0	26.5	23.5	107.0	
LCMAX300-16-5	—	300 <sup>^</sup>	M16	26.2	48.0	26.5	23.5	107.0	
LCMAX300-20-5	—	300 <sup>^</sup>	M20	26.2	48.0	26.5	23.5	107.0	
LCMA400-12-5	400	—	M12	27	49.5	26.5	23.5	107	
LCMA400-16-5	400	—	M16	27	49.5	26.5	23.5	107	
LCMA400-20-5	400	—	M20	27	49.5	26.5	23.5	107	
LCMA500-12-1	500	—	M12	31	57.5	28.5	25.5	120	
LCMA500-16-1	500	—	M16	31	57.5	28.5	25.5	120	
LCMA500-20-1	500	—	M20	31	57.5	28.5	25.5	120	
LCMA500-00-1	500	—	Blank	31	57.5	—	—	120	
LCMA630-12-1	630	—	M12	34.5	63	28.5	27.5	132	1
LCMA630-16-1	630	—	M16	34.5	63	28.5	27.5	131	
LCMA630-20-1	630	—	M20	34.5	63	28.5	27.5	131	
LCMA630-00-1	630	—	Blank	34.5	63	—	—	131	

Visit [www.panduit.com/tools](http://www.panduit.com/tools) for tool and die information.

\*\*Consult cable manufacturer for voltage stress relief instructions with applications greater than 2000 V.

\*\*\*Not CE compliant and not tested to EN 61238-2:2003/IEC 61238-1:2003 for terminations with metric Class 5f or Class 6f flexible stranded conductor.

<sup>^</sup>Class 5f conductor only