

Preinsulated ring terminals

Tin-plated copper. Barrel with funnel entry. Grooves inside the barrel for a better electric contact and a better pullout resistance. Polyamide insulation. Max. operating temperature: 105°C. Easy entry. Flammability rating: UL 94V0. Halogen free.

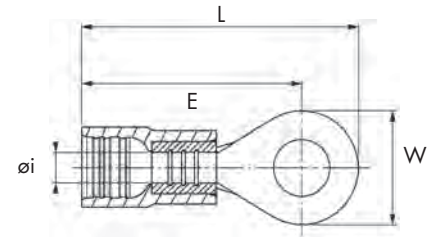

Compliant with CEI 60352-2



Conductor size (mm ²)	Bulk packing		Packing 100 pieces/box		Insulation max. Ø (mm)	Bolt Ø (mm)	Dimensions (mm)			
	Item code	Part number	Item code	Part number			W	Øi	E	L
2.6 - 6	7 210 191	NC1-5	7 210 190	B100NC1-5	6.4	5	9.6	3.3	22.2	27
	7 210 201	NC1-6	7 210 200	B100NC1-6	6.4	6	9.6	3.3	22.2	27
	7 210 211	NC2-6	7 210 210	B100NC2-6	6.4	6	13.8	3.3	25.1	32

Preinsulated disconnects

Tin-plated brass. Barrel with funnel entry. Grooves inside the barrel provide a better pullout resistance. PVC insulating sleeve. Easy entry. Copper sleeve for double crimping. Max. operating temperature: 75°C. Flammability rating: UL 94V0.



8625



8625TI

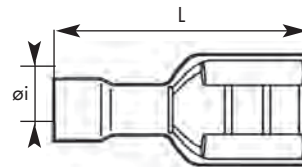
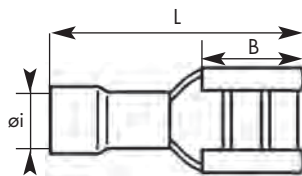

Conductor size (mm ²)	Packing 100 pieces/bag		Insulation Ø max. (mm)	Width (mm)	Thickness (mm)	Øi (mm)	B (mm)	L (mm)
	Item code	Part number						
2.6 - 6	7 307 621	8625	6.2	6.35	0.8	3.4	7.3	23.3
	7 307 622	8625TI	6.2	6.35	0.8	3.4	-	24.2

Other preinsulated terminals: see the general catalogue

Tooling: see page 19