

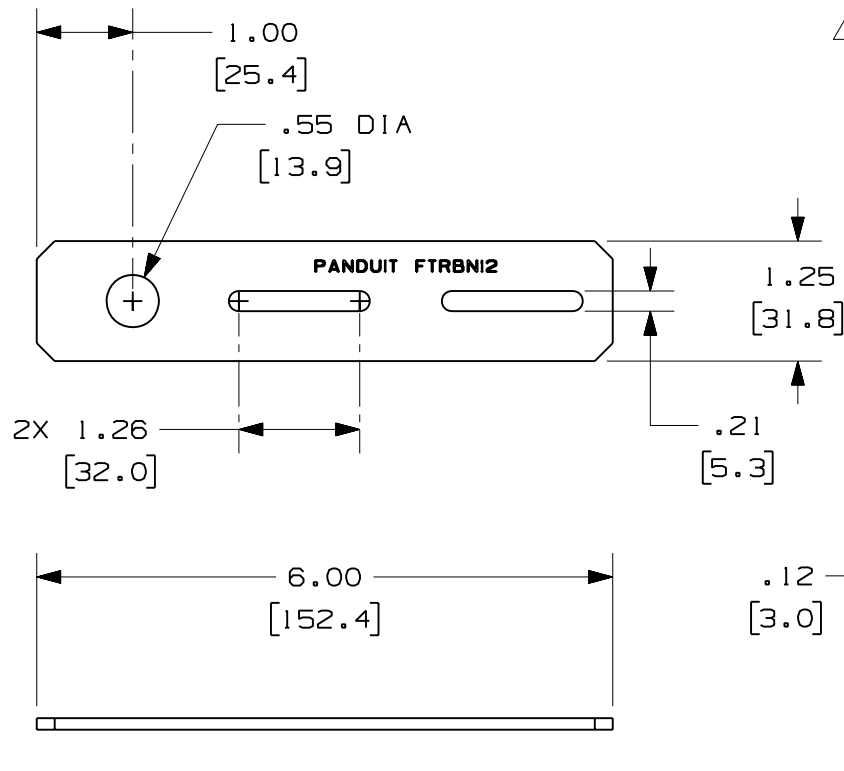

PANDUIT PART NUMBER	WEIGHT
FTRBN12 FTRBN12M	0.39 LB/EACH (176g/EACH)



NOTES:

- SEE CURRENT CATALOG FOR ADDITIONAL PART SUFFIXES TO INDICATE PACKAGE QUANTITY.
- THE FIBER-DUCT 2x2, 4x4 AND FIBERRUNNER 2x2 NEW THREADED ROD BRACKET IS USED TO SUPPORT THE FIBER-DUCT 2x2, 4x4 AND FIBERRUNNER 2x2 CABLE ROUTING SYSTEMS FROM A SECTION OF NEW 1/2" (M12) THREADED ROD.
- THE FIBER-DUCT 2x2, 4x4 AND FIBERRUNNER 2x2 NEW THREADED ROD BRACKET INCLUDES:  
ONE (1) BRACKET,  
TWO (2) 1/2-13 HEAVY HEX NUTS (FTRBN12 ONLY),  
TWO (2) 1/2" HELICAL SPRING LOCKWASHERS,  
TWO (2) M12x1.75 HEX NUTS (FTRBN12M ONLY),  
TWO (2) #10-32x1/2 PAN HEAD SLOTTED MACHINE SCREWS,  
TWO (2) #10-32 HEX MACHINE SCREW NUTS,  
TWO (2) #10 HELICAL SPRING LOCKWASHERS.
- FINISH COLOR: YELLOW ZINC DICHROMATE (EXCEPT HARDWARE)
- DIMENSIONS IN PARENTHESES ARE IN METRIC.

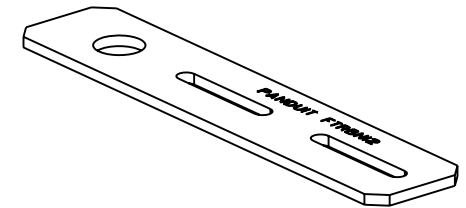

ENG. REF.: D35245BP\_DC\_FTRBN12\_02.prt

CAD FILENAME/LAYERS		FTRBN12.pdf	
PANDUIT CORP		TINLEY PARK, ILLINOIS	
FIBER-DUCT 2x2, 4x4 AND FIBERRUNNER 2x2		NEW THREADED ROD BRACKET - 1/2" (M12)	
G H		THREADED ROD (FTRBN12, FTRBN12M)	
UNLESS OTHERWISE SPECIFIED, DIMENSIONAL TOLERANCES ARE:		UNLESS OTHERWISE SPECIFIED, ALL DIMENSIONS ARE GIVEN IN INCHES, THIRD ANGLE PROJECTION.	
(.X) ± (.XXX) ±		ANGLES ±	
(.XX) ± .03 (.8)			
DRAWN BY	TCP	MAT'L:	STEEL
DATE	11-20-96		
CHK'D	CEI		
SCALE	NONE	DRAWING NO.	35245-16
		DWG	A
		SIZE	A

REV	DATE	BY	CHK	DESCRIPTION	ECN	R	CUST	SUP	GMBH
-	-----	---	--	K. REVISED GENERAL NOTES.	-----	--	--		
-	-----	---	--	J. REVISED PART WEIGHT. I. REVISED MATERIAL.	-----	--	--		
-	-----	---	--	H. REMOVED FTRBN58. G. REVISED DRAWING TITLE.	-----	--	--		
2	12-27-06	MSO	RN	F. REVISED CAD FILENAME. E. REVISED AND REDRAWN.	35245-16	RN	RN		