

PANDUIT PART NUMBER	WEIGHT
FITF12X4	1.40 LB/EACH [ 635 g/EACH ]

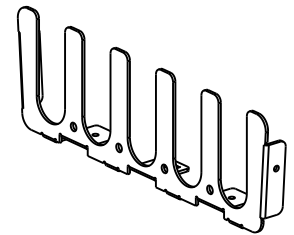
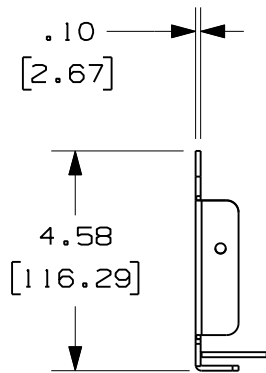
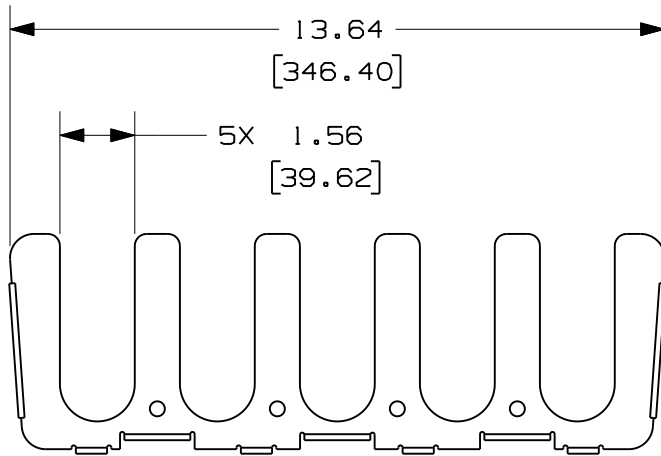
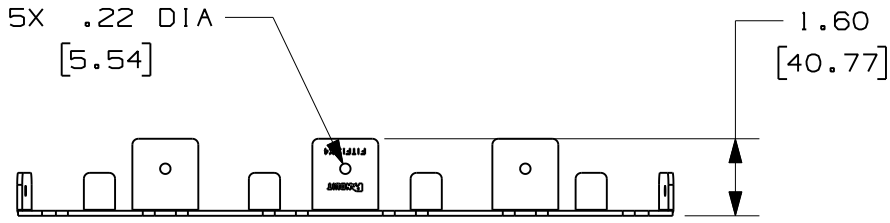

**NOTES:**

1. SEE CURRENT CATALOG FOR ADDITIONAL PART SUFFIXES TO INDICATE PACKAGE QUANTITY.
2. THE FIBERRUNNER 12x4 INNERDUCT TRANSITION FITTING ATTACHES TO ANY FIBERRUNNER 12x4 CHANNEL AND/OR FITTING AS WELL AS THE FIBERRUNNER 12x4 VERTICAL TEE FITTING TO CREATE A FLEXIBLE SPILL-OUT INTO EQUIPMENT FRAMES AND TELECOMMUNICATIONS CABINETS. THE INNERDUCT TRANSITION IS DESIGNED TO SECURELY HOLD UP TO TEN (10) PIECES OF 1 1/2" (38.1) I.D. INNERDUCT AND/OR SOLID CORRUGATED LOOM TUBING.
3. THE FIBERRUNNER 12x4 INNERDUCT TRANSITION FITTING INCLUDES:  
 ONE (1) INNERDUCT TRANSITION FITTING,  
 FIVE (5) #10-32x1/2 PAN HEAD PHILLIPS MACHINE SCREWS,  
 FIVE (5) #10 HELICAL SPRING LOCKWASHERS,  
 FIVE (5) #10-32 HEX MACHINE SCREW NUTS,  
 FIVE (5) BT41-CO DOME-TOP BARB-TY CABLE TIES
4. FINISH COLOR: BLACK (EXCEPT HARDWARE)
5. DIMENSIONS IN PARENTHESES ARE IN METRIC.

CAD FILENAME/LAYERS D375851D\_DC\_FITF12X4/03B

**PANDUIT** CORP. TINLEY PARK, ILLINOIS  
 FIBERRUNNER 12X4 INNERDUCT  
 TRANSITION FITTING (FITF12X4)  
 CUSTOMER DRAWING

UNLESS OTHERWISE SPECIFIED,  
 DIMENSIONAL TOLERANCES ARE:  
 (.X) ± (.XXX) ±  
 (.XX) ± .03 [.8] ANGLES ±

UNLESS OTHERWISE SPECIFIED,  
 ALL DIMENSIONS ARE GIVEN  
 IN INCHES, THIRD ANGLE PROJECTION.

I	02-11-09	JHEP	PM	RELEASED TO PRODUCTION	37585-189	RN	RN			
R	10-08-08	JHEP	PM	DRAWING RELEASED						
REV	DATE	BY	CHK	DESCRIPTION	ECN	CHK	CUST	SUP		

DRAWN BY JHEP	MAT'L: STEEL	SCALE NONE
DATE 10-08-08		DRAWING NO. 37585-189
CHK'D PM		DWG SIZE A