

P31 - R/L HAND REDUCER H25/50/75/100

Reference(s): 4815../10/11/12 - 4815../50/51/52/52/54
4835../50/51/52/52/54 - 4855../50/51/52/52/54
X9D../48Z/49Z/51Z/52Z - X9D../48C/49C/51C/52C
X9D../48G/49G/51G/52G - X9D../48L/49L/51L/52L
4816../69/70/71/72 - 4836../69/70/71/72 - 4856../69/70/71/72



1. USE

R/L hand reducer in H25/50/75/100 for cable trays.

2. RANGE BLIND

■ 2.1 R/L HAND REDUCER H25 blind PG

Description	Code	Width		Weight		Thickness		Coating	Section	
		(mm)	(inch)	(Kg)	(lb)	(mm)	(inch)		(mm ²)	(inch ²)
P31-R/L HAND REDUCER 25X 50 PG	481510	50	1,97	0,04	0,09	0,7	0,03	PG	2381	3,69
P31-R/L HAND REDUCER 25X100 PG	481511	100	3,94	0,06	0,13	0,7	0,03	PG	5181	8,03
P31-R/L HAND REDUCER 25X150 PG	481512	150	5,91	0,08	0,17	0,7	0,03	PG	7708	11,95

■ 2.2 R/L HAND REDUCER H50 blind PG

Description	Code	Width		Weight		Thickness		Coating	Section	
		(mm)	(inch)	(Kg)	(lb)	(mm)	(inch)		(mm ²)	(inch ²)
P31-R/L HAND REDUCER 50X 50 PG	481550	50	1,97	0,06	0,14	1,0	0,04	PG	2381	3,69
P31-R/L HAND REDUCER 50X100 PG	481551	100	3,94	0,09	0,20	1,0	0,04	PG	5181	8,03
P31-R/L HAND REDUCER 50X150 PG	481552	150	5,91	0,12	0,25	1,0	0,04	PG	7708	11,95
P31-R/L HAND REDUCER 50X200 PG	481553	200	7,87	0,14	0,31	1,0	0,04	PG	10273	15,92
P31-R/L HAND REDUCER 50X300 PG	481554	300	11,81	0,19	0,42	1,0	0,04	PG	15403	23,87

■ 2.3 R/L HAND REDUCER H50 blind HDG

Description	Code	Width		Weight		Thickness		Coating	Section	
		(mm)	(inch)	(Kg)	(lb)	(mm)	(inch)		(mm ²)	(inch ²)
P31-R/L HAND REDUCER 50X 50 HDG	483550	50	1,97	0,07	0,16	1,0	0,04	HDG	2381	3,69
P31-R/L HAND REDUCER 50X100 HDG	483551	100	3,94	0,10	0,22	1,0	0,04	HDG	5181	8,03
P31-R/L HAND REDUCER 50X150 HDG	483552	150	5,91	0,13	0,28	1,0	0,04	HDG	7708	11,95
P31-R/L HAND REDUCER 50X200 HDG	483553	200	7,87	0,15	0,34	1,0	0,04	HDG	10273	15,92
P31-R/L HAND REDUCER 50X300 HDG	483554	300	11,81	0,21	0,46	1,0	0,04	HDG	15403	23,87

■ 2.4 R/L HAND REDUCER H50 blind BLUE

Description	Code	Width		Weight		Thickness		Coating	Section	
		(mm)	(inch)	(Kg)	(lb)	(mm)	(inch)		(mm ²)	(inch ²)
P31-R/L HAND REDUCER 50X 50 BLUE	485550	77	3,03	0,06	0,14	1,0	0,04	BLUE	2381	3,69
P31-R/L HAND REDUCER 50X100 BLUE	485551	100	3,94	0,09	0,20	1,0	0,04	BLUE	5181	8,03
P31-R/L HAND REDUCER 50X150 BLUE	485552	150	5,91	0,12	0,25	1,0	0,04	BLUE	7708	11,95
P31-R/L HAND REDUCER 50X200 BLUE	485553	200	7,87	0,14	0,31	1,0	0,04	BLUE	10273	15,92
P31-R/L HAND REDUCER 50X300 BLUE	485554	300	11,81	0,19	0,42	1,0	0,04	BLUE	15403	23,87

■ 2.5 R/L HAND REDUCER H75 blind PG

Description	Code	Width		Weight		Thickness		Coating	Section	
		(mm)	(inch)	(Kg)	(lb)	(mm)	(inch)		(mm²)	(inch²)
P31-R/L HAND REDUCER 75X 50 PG	X9D48Z	50	1,97	0,10	0,22	1,0	0,04	PG	3963	6,14
P31-R/L HAND REDUCER 75X100 PG	X9D49Z	100	3,94	0,14	0,30	1,0	0,04	PG	11785	18,27
P31-R/L HAND REDUCER 75X150 PG	X9D51Z	150	5,91	0,17	0,38	1,0	0,04	PG	15700	24,34
P31-R/L HAND REDUCER 75X200 PG	X9D52Z	200	7,87	0,21	0,46	1,0	0,04	PG	23530	36,47

■ 2.6 R/L HAND REDUCER H75 blind HDG

Description	Code	Width		Weight		Thickness		Coating	Section	
		(mm)	(inch)	(Kg)	(lb)	(mm)	(inch)		(mm²)	(inch²)
P31-R/L HAND REDUCER 75X 50 HDG	X9D48C	50	1,97	0,11	0,24	1,0	0,04	HDG	3963	6,14
P31-R/L HAND REDUCER 75X100 HDG	X9D49C	100	3,94	0,15	0,33	1,0	0,04	HDG	11785	18,27
P31-R/L HAND REDUCER 75X150 HDG	X9D51C	150	5,91	0,19	0,42	1,0	0,04	HDG	15700	24,34
P31-R/L HAND REDUCER 75X200 HDG	X9D52C	200	7,87	0,23	0,50	1,0	0,04	HDG	23530	36,47

■ 2.7 R/L HAND REDUCER H75 blind BLUE

Description	Code	Width		Weight		Thickness		Coating	Section	
		(mm)	(inch)	(Kg)	(lb)	(mm)	(inch)		(mm²)	(inch²)
P31-R/L HAND REDUCER 75X 50 BLUE	X9D48G	50	1,97	0,10	0,22	1,0	0,04	BLUE	3963	6,14
P31-R/L HAND REDUCER 75X100 BLUE	X9D49G	100	3,94	0,14	0,30	1,0	0,04	BLUE	11785	18,27
P31-R/L HAND REDUCER 75X150 BLUE	X9D51G	150	5,91	0,17	0,38	1,0	0,04	BLUE	15700	24,34
P31-R/L HAND REDUCER 75X200 BLUE	X9D52G	200	7,87	0,21	0,46	1,0	0,04	BLUE	23530	36,47

■ 2.8 R/L HAND REDUCER H75 blind 316L

Description	Code	Width		Weight		Thickness		Coating	Section	
		(mm)	(inch)	(Kg)	(lb)	(mm)	(inch)		(mm²)	(inch²)
P31-R/L HAND REDUCER 75X 50 316L	X9D48L	50	1,97	0,10	0,22	1,0	0,04	316L	3963	6,14
P31-R/L HAND REDUCER 75X100 316L	X9D49L	100	3,94	0,14	0,30	1,0	0,04	316L	11785	18,27
P31-R/L HAND REDUCER 75X150 316L	X9D51L	150	5,91	0,17	0,38	1,0	0,04	316L	15700	24,34
P31-R/L HAND REDUCER 75X200 316L	X9D52L	200	7,87	0,21	0,46	1,0	0,04	316L	23530	36,47

■ 2.9 R/L HAND REDUCER H100 blind PG

Description	Code	Width		Weight		Thickness		Coating	Section	
		(mm)	(inch)	(Kg)	(lb)	(mm)	(inch)		(mm²)	(inch²)
P31-R/L HAND REDUCER 100X 50 PG	481669	50	1,97	0,14	0,31	1,0	0,04	PG	5181	8,03
P31-R/L HAND REDUCER 100X100 PG	481670	100	3,94	0,18	0,41	1,0	0,04	PG	10193	15,80
P31-R/L HAND REDUCER 100X150 PG	481671	150	5,91	0,23	0,50	1,0	0,04	PG	15258	23,65
P31-R/L HAND REDUCER 100X200 PG	481672	200	7,87	0,27	0,60	1,0	0,04	PG	20323	31,50

■ 2.10 R/L HAND REDUCER H100 blind HDG

Description	Code	Width		Weight		Thickness		Coating	Section	
		(mm)	(inch)	(Kg)	(lb)	(mm)	(inch)		(mm²)	(inch²)
P31-R/L HAND REDUCER 100X 50 HDG	483669	50	1,97	0,15	0,34	1,0	0,04	HDG	5181	8,03
P31-R/L HAND REDUCER 100X100 HDG	483670	100	3,94	0,20	0,45	1,0	0,04	HDG	10193	15,80
P31-R/L HAND REDUCER 100X150 HDG	483671	150	5,91	0,25	0,56	1,0	0,04	HDG	15258	23,65
P31-R/L HAND REDUCER 100X200 HDG	483672	200	7,87	0,30	0,66	1,0	0,04	HDG	20323	31,50

■ 2.11 R/L HAND REDUCER H100 blind BLUE

Description	Code	Width		Weight		Thickness		Coating	Section	
		(mm)	(inch)	(Kg)	(lb)	(mm)	(inch)		(mm²)	(inch²)
P31-R/L HAND REDUCER 100X 50 BLUE	485669	50	1,97	0,14	0,31	1,0	0,04	BLUE	5181	8,03
P31-R/L HAND REDUCER 100X100 BLUE	485670	100	3,94	0,18	0,41	1,0	0,04	BLUE	10193	15,80
P31-R/L HAND REDUCER 100X150 BLUE	485671	150	5,91	0,23	0,50	1,0	0,04	BLUE	15258	23,65
P31-R/L HAND REDUCER 100X200 BLUE	485672	200	7,87	0,27	0,60	1,0	0,04	BLUE	20323	31,50

3. DIMENSIONS (mm/inch)

■ **3.1 Fitting dimensions**

Description	Width		L1		L2	
	(mm)	(inch)	(mm)	(inch)	(mm)	(inch)
P31-R/L HAND REDUCER 25X 50	51	2,01	100	3,94	100	3,94
P31-R/L HAND REDUCER 25X100	101	3,98	100	3,94	150	5,91
P31-R/L HAND REDUCER 25X150	151	5,94	100	3,94	200	7,87

■ **3.2 Fitting dimensions**

Description	Width		L1		L2	
	(mm)	(inch)	(mm)	(inch)	(mm)	(inch)
P31-R/L HAND REDUCER 50X 50	48	1,89	51	2,01	210	8,27
P31-R/L HAND REDUCER 50X100	98	3,86	51	2,01	260	10,24
P31-R/L HAND REDUCER 50X150	148	5,83	51	2,01	310	12,20
P31-R/L HAND REDUCER 50X200	198	7,80	51	2,01	360	14,17
P31-R/L HAND REDUCER 50X300	298	11,73	51	2,01	460	18,11

■ **3.3 Fitting dimensions**

Description	Width		L1		L2	
	(mm)	(inch)	(mm)	(inch)	(mm)	(inch)
P31-R/L HAND REDUCER 75X 50	48	1,89	78	3,07	210	8,27
P31-R/L HAND REDUCER 75X100	98	3,86	78	3,07	260	10,24
P31-R/L HAND REDUCER 75X150	148	5,83	78	3,07	310	12,20
P31-R/L HAND REDUCER 75X200	198	7,80	78	3,07	360	14,17

■ **3.4 Fitting dimensions**

Description	Width		L1		L2	
	(mm)	(inch)	(mm)	(inch)	(mm)	(inch)
P31-R/L HAND REDUCER 100X 50	48	1,89	101	3,98	210	8,27
P31-R/L HAND REDUCER 100X100	98	3,86	101	3,98	260	10,24
P31-R/L HAND REDUCER 100X150	148	5,83	101	3,98	310	12,20
P31-R/L HAND REDUCER 100X200	198	7,80	101	3,98	360	14,17

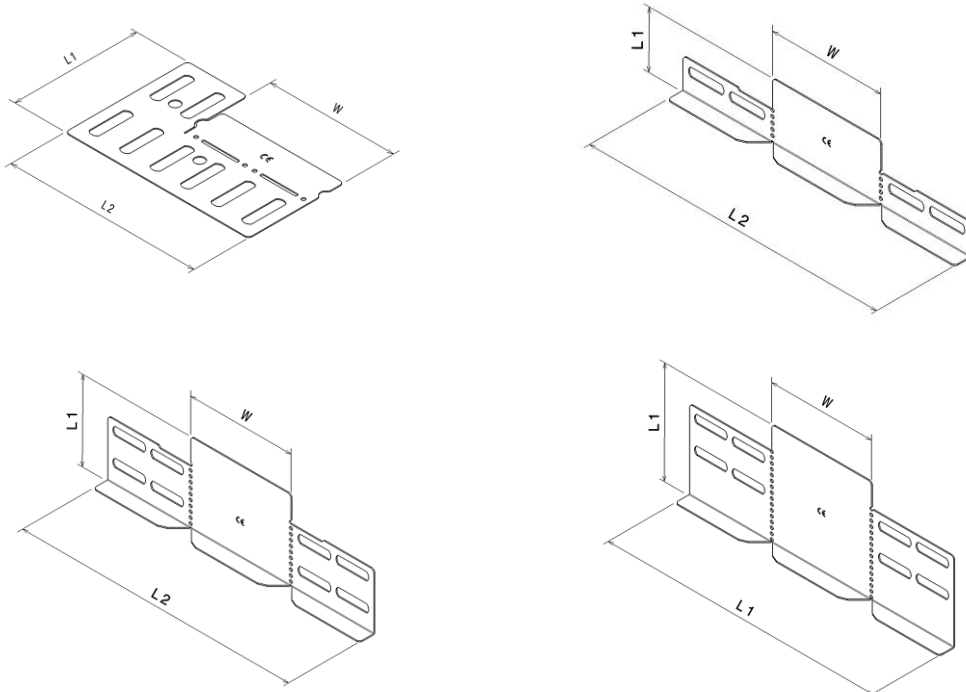

4. INSTALLATION

■ **4.1 Screw and tools**

Use screws M6x12 tightened at 11Nm

- Reference(s): 341895 / 03V1M610Z (PG)
 485035 (Zn-Ni)
 346895/ 03V1M610L (SS316L)
 341708 / 31X99X999 (PG)
 346474 / 31X99X99X (SS316L)

■ **4.2 Fitting to cable tray**

R/L hand reducer are assembled using screws supplied.

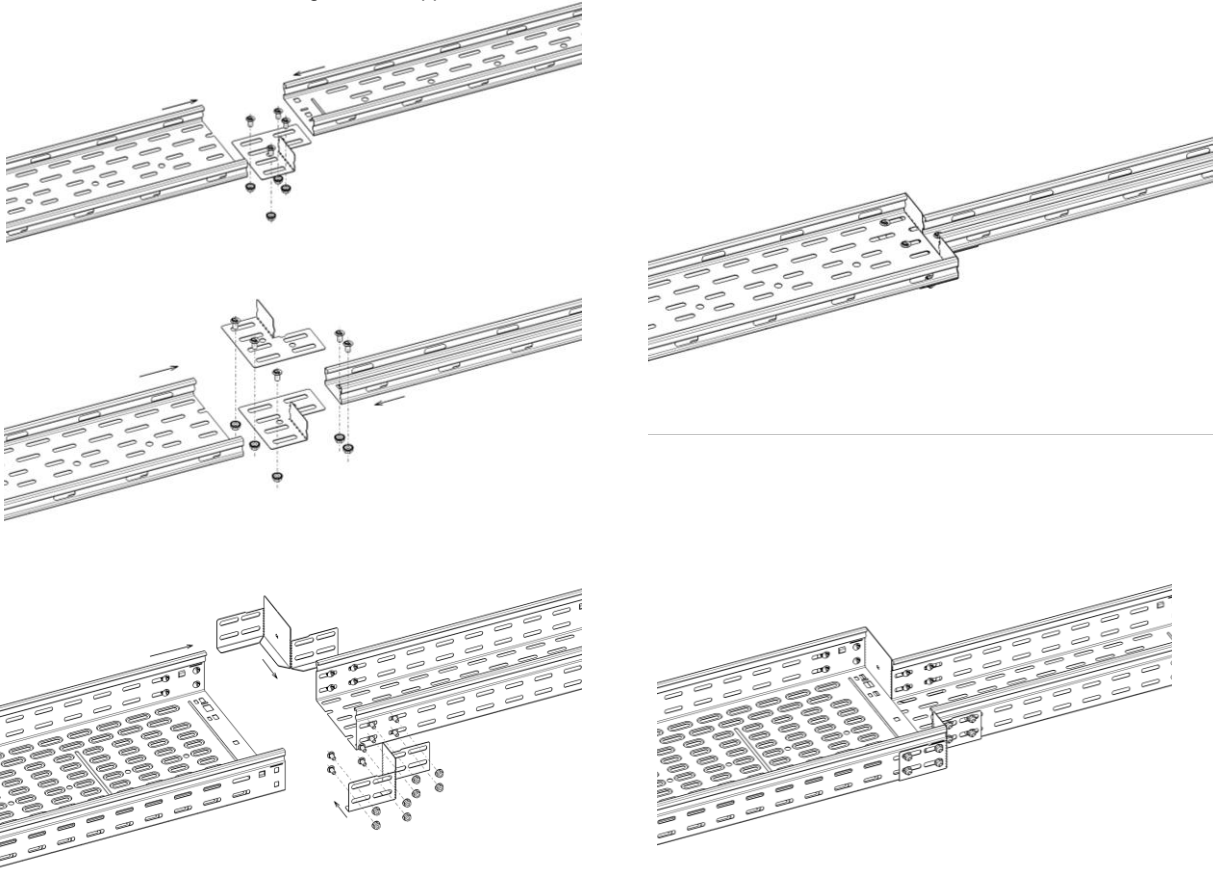

5. TECHNICAL DATA

■ **5.1 Climatic characteristics**

Storage and operating temperature: - 20° C à + 120° C

■ **5.2 Material characteristics**

Material finish	Material	Standard	Resistance class against corrosion
PG	DX51D + Z200	EN 10346	Classe 3 - CEI 61537
BLUE	DX51D + Z200	EN 10346	Classe 3 - CEI 61537
HDG	DC 01	EN 10130	Classe 6 - CEI 61537
SS304	X5CrNi18-10	EN 10 088-2	Classe 9A - CEI 61537
SS316L	X2CrNiMo17-12-2	EN 10 088-2	Classe 9B - CEI 61537

6. CONFORMITY - CERTIFICATION

Comply with CEI 61537 Cable tray systems
 Certification: CE, IMQ