

BP TRCC M6x12 HE

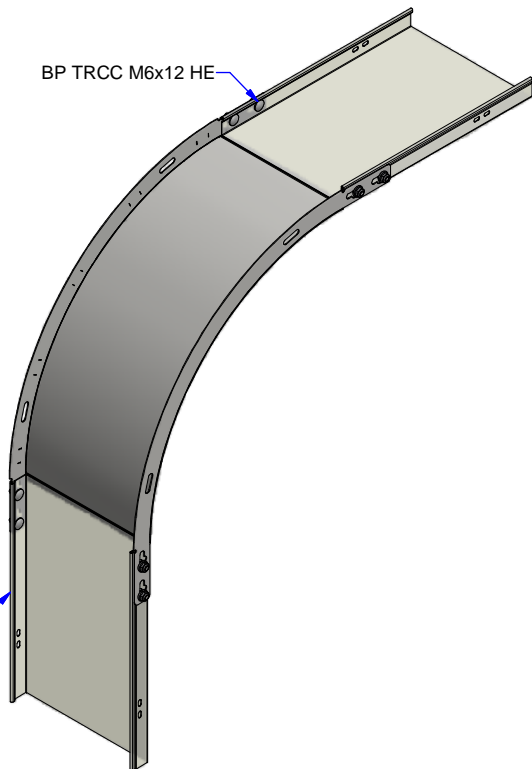

Goulotte GBRs  
(GBRS Trunking)

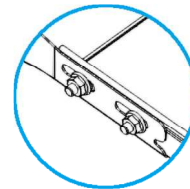
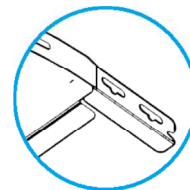

Description	Code	Masse/Weight Kg/p	Ep./Th. mm	H mm	l./w. mm
CV GBRs 24x50 SZ	518535	0,560	1,00	24,00	54
CV GBRs 24x75 SZ	518540	0,650	1,00	24,00	78
CV GBRs 24x100 SZ	518545	0,750	1,00	24,00	102
CV GBRs 24x147 SZ	518555	0,930	1,00	24,00	150
CV GBRs 24x195 SZ	518565	1,110	1,00	24,00	198

**G** : Pre-galvanised according to NF EN 10346 (S220 GD / Z).

**SZ** : Tôle d'acier galvanisé avant fabrication suivant NF EN 10346 (S220 GD / Z).



www.niedaxfrance.fr

CONVEXE GBRs H24 SZ  
GBRS OUTSIDE BEND H24 G



ASSISTANCE TECHNIQUE  
+33 (0)1 55 95 92 17  
pole.technique@niedax.fr

**NIEDAX**  
France

FT02728

