

THIS COPY IS PROVIDED ON A RESTRICTED BASIS AND IS NOT TO BE USED IN ANY WAY DETRIMENTAL TO THE INTERESTS OF PANDUIT CORP.

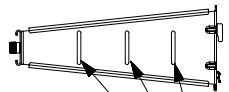

SLOTS FOR TYING OFF BUNDLES OF CABLES (BOTH SIDES)

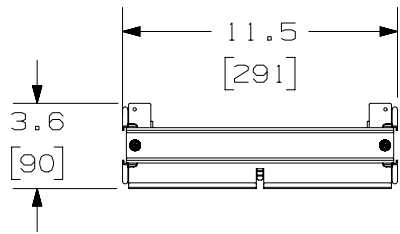
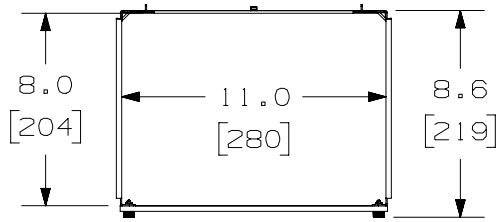
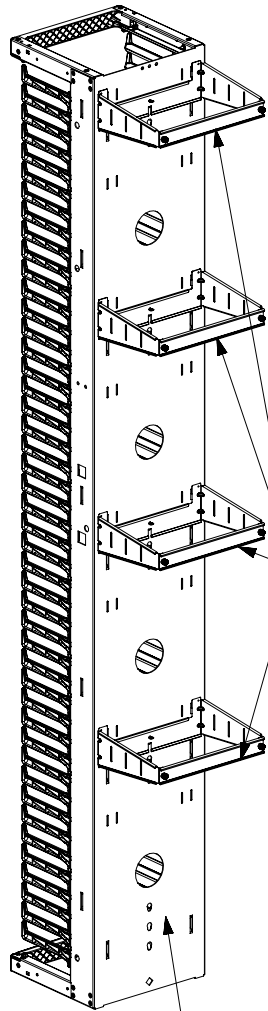

KIT CONTAINS (4) GATE ASSEMBLIES

PR2VF12 (SHOWN) OR PR2VF1296 (SOLD SEPARATELY)

- NOTES:
1. VISIT OUR ON-LINE CATALOG AT WWW.PANDUIT.COM FOR A LIST OF CURRENT PARTS APPLICABLE FOR USE WITH THIS PRODUCT.
 2. DIMENSIONS IN [] ARE METRIC.
 3. ALL MATERIALS AND COMPONENTS USED MEET THE MATERIAL RESTRICTIONS OF RoHS (EUROPEAN DIRECTIVE 2011/65/EU ON THE RESTRICTION OF HAZARDOUS SUBSTANCES) AS PROPOSED BY THE RoHS TECHNICAL ADAPTATION COMMITTEE.
 4. PART INCLUDES:
 - (4) 12" GATE ASSEMBLIES, WHICH INCLUDES GATE FRAME AND SWIVEL GATE
 - (4) #6-32 THUMB SCREWS
 5. WEIGHT: 6.2 LBS. (2.8Kg) PER KIT

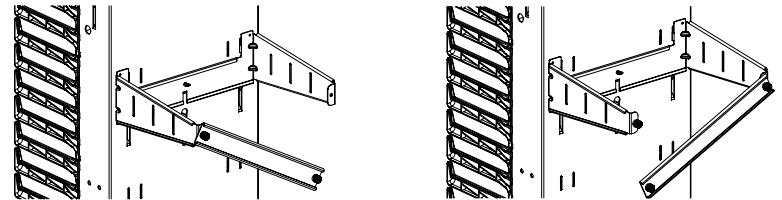

GATE OPENS FROM EITHER SIDE BY LOOSENING EITHER CAPTIVE SCREW

| | | | | |
|---|---------|---------------------------|------|------|
| PART NUMBER | | PR2VRGSK12 | | |
| TITLE | | PR2V REAR GATE SYSTEM KIT | | |
| ITEM REVISION NAME | | CUSTOMER DRAWING | | |
| | | 00422EAE/00 | | |
| DATASET FILE NAME | | 00422EAE_DC/00A | | |
|  | | THIRD ANGLE PROJECTION | | |
| MATERIAL | | STEEL | | |
| | | DRAWING NUMBER | | |
| | | 00422EAE - DC | | |
| 00 | 5/14/19 | BAME | KRKE | JEFK |
| REV | DATE | BY | CHK | APR |
| DRAWING RELEASED | | | | |
| DESCRIPTION | | | | |
| ECN | | | | |
| DRAWN BY | | DATE | | CHK |
| BAME | | 5/14/19 | | KRKE |
| SCALE | | NONE | | |
| SHEET 1 OF 1 | | | | SIZE |
| | | | | A |

A-SIZE CUSTOMER