

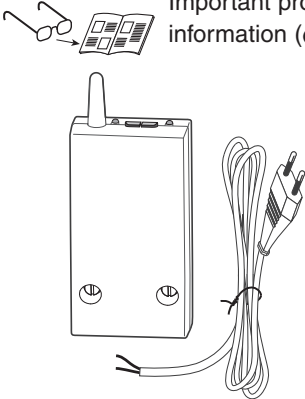

# TYWATT 5300

www.deltadore.com

Important product information (i)



	230 V~, 50 Hz 1 VA	
	<b>Stockage</b>	-10°C / +70°C
	<b>Fonctionnement</b>	0°C / +40°C
	54 x 140 x 25 mm	
	868 MHz (EN 300 220) 100 m	
<b>IP</b>	IP x4	
<b>CE</b>	R&TTE 1999/5/CE	



## Fixation / Raccordement capteur

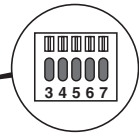
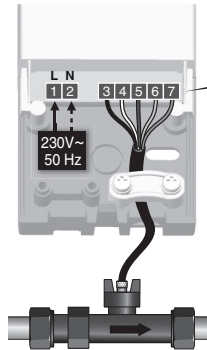
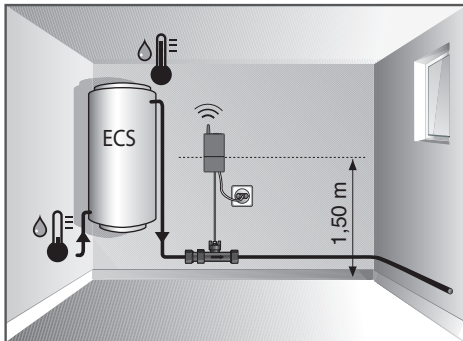

3. Noir, black, negro, preto, nero, schwarz, zwart, czarny
4. Blanc, white, bianco, branco, bianco, weiß, wit, biały
5. Brun, brown, marrón, marron, marrone, braun, bruin, br1 zowý
6. Gris, Grey, cinza, grigio, grau, grijs, szary
7. Bleu, blue, azul, blu, blau, blauw, niebieski

**1**  
  
**OFF**  
230V~  
50 Hz

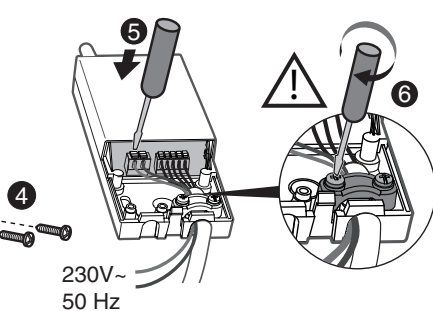
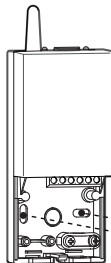
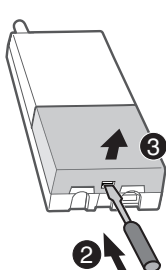

230V~  
50 Hz

## Sélection du type de Capteur

### Première mise sous tension

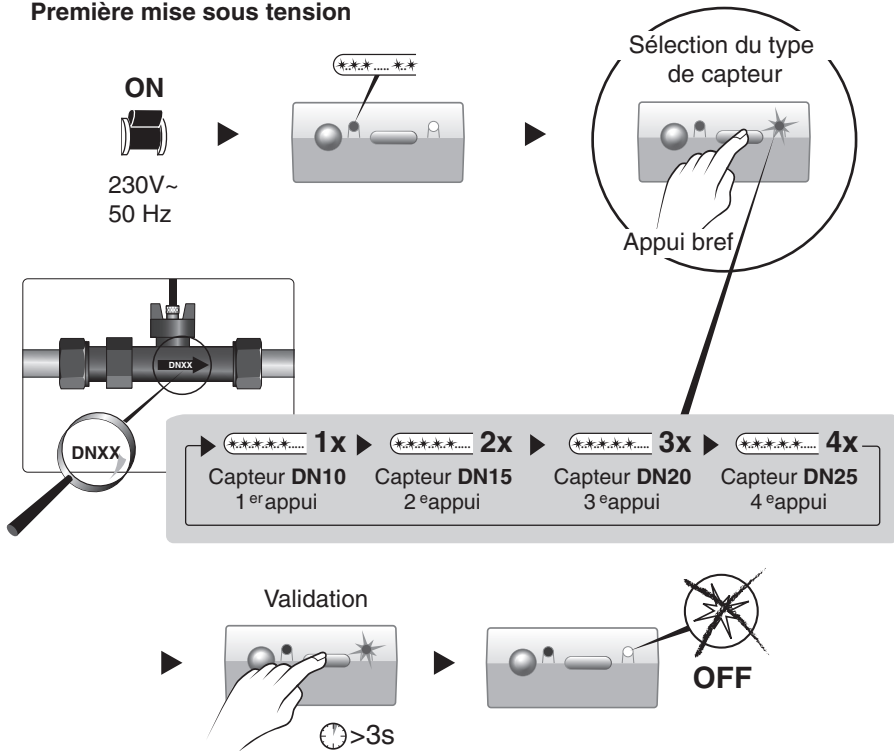

## Association radio

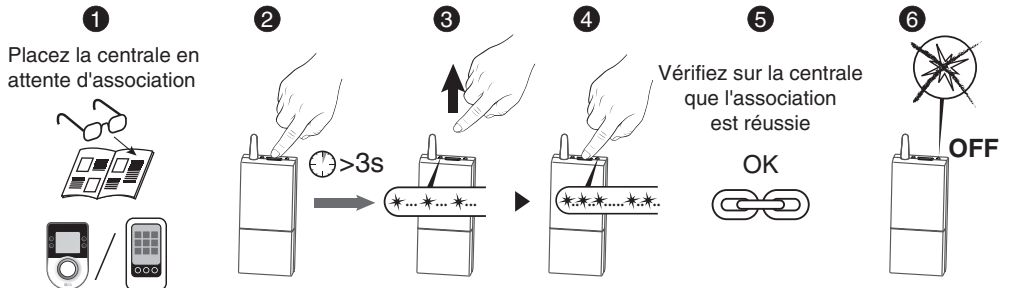

## RESET ► Modification du type de capteur

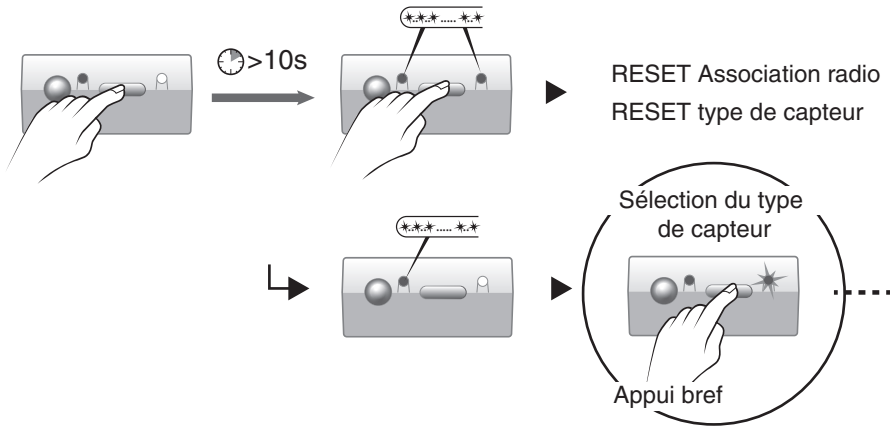

## Signalement défaut

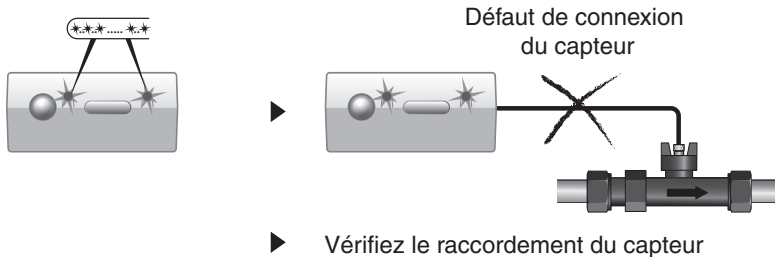

Récepteur / Receiver / Receptor / Receptor / Ricevitore / Empfänger / Odbiornik / Ontvanger / Prijimač / Mottagare / Modtager / Mottaker / Vastaanotin / 接收器 /



Emetteur / Transmitter / Emisor / Emisor / Emittitore / Sender / Nadajnik / Zender / Vysiláč / Sändare / Transmitter / Sender / Lähetin / 发射器 /



Association / Association / Asociación / Associação / Associazione / Verbindung / Przypisanie / Verbinding / Piižazeni / Associering / Tilknytning / Forbindelse / Kytchentä / 连接 /



Suppression d'une association / Delete one association / Borrà associación / Eliminar associação / Eliminare le associazioni / Verbindung löschen / Usunięcie przypisania / Een verbinding opheffen / Zrušit piižazeni / Ta bort associationerna / Sletning af en tilknytning / Slette en Forbindelse / Poista kytchentä / 删除一个连接 /



Reset total / Total reset / Reset total / Reinicialização total / Reset totale / Reset / Reset calkivity / Totale reset / Celkový reset / Total återställning / Total nullstilling / Total nullstilling / Nollaa kaikki / 完全初始化设置 /



Clignotement lent / Slow flashing / Parpadeo lento / Intermitência lenta / Lamppeggiamento lento / Langsames blinken / Wolne miganie / Langzaam knipperen / Pomalé blikání / Blinking långsam / Langsomme blink / Langsomme blink / Hidas vilkunta / 缓慢的闪烁 /



Clignotement rapide / Fast flashing / Parpadeo rápido / Intermitência rápida / Lamppeggiamento rapido / Schnelles blinken / Szybkie miganie / Snel knipperen / Rychlé blikání / Snabb blinkningar / Hurtige blink / Raske blink / Nopea vilkunta / 快速的闪烁 /



Temps d'appui / Press time / Tiempo de pulsación / Tempo de pressão / Tempo pressione / Tastendruckdauer / Czas naciskania / Drukttij / Doba stisknutí / Kopplingstid / Tid Nedtrykning / Trykkestid / Painallisaika / 按键时间 /



OFF

Voyant éteint / LED off / Testigo apagado / Indicador apagado / Spia spenta / Kontrollleuchte aus / Lamka gaśnie / Kontrolllampe uit / LED nesviti / Lampan släcks / Kontrolllampe slukket / Lysoledi slukket / Merkkivalo palaa / 指示灯熄灭 /