

| | | | | |
|---|----------|----|------|--------------------------------------|
| Product designation | | | | Rotary cam switches |
| Product type designation | | | | GF10 |
| General characteristics | | | | |
| Switching diagram | | | | 87 - Multi-step 1-2-3-4 2 poles |
| N° of elements | | | | 4 |
| Mounting form | | | | U - Front mounting with black handle |
| Contact characteristics | | | | |
| Rated insulation voltage U_i | IEC/EN | V | 480 | |
| | UL/CSA | V | 240 | |
| Rated impulse withstand voltage U_{imp} | | kV | 4 | |
| Conventional free air thermal current I_{th} | IEC/EN | A | 10 | |
| | UL/CSA | A | 10 | |
| Rated operational voltage | | V | 480 | |
| Rated operational impulse voltage | | kV | 4 | |
| Maximum fuse size for short-circuit protection I_n (gG) | 10kA | A | 16 | |
| Rated short time current I_{cw} | 1s | A | 250 | |
| Conductivity | | | | 10/5 mA/V |
| Operational current I_e IEC/EN | | | | |
| AC1/AC21A | | A | 10 | |
| AC15 | 110V | A | 5 | |
| | 220/230V | A | 3 | |
| | 380/400V | A | 2 | |
| Rated operational power in AC | | | | |
| Three-phase AC-3 | 220/230V | kW | 1.5 | |
| | 380/440V | kW | 2.2 | |
| Single-phase AC-3 | 110V | kW | 0.3 | |
| | 220/230V | kW | 0.55 | |
| | 380/440V | kW | 0.75 | |
| Three-phase AC23A | 220/230V | kW | 1.8 | |
| | 380/440V | kW | 3 | |
| Single-phase AC23A | 110V | kW | 0.7 | |
| | 220/230V | kW | 0.75 | |
| | 380/440V | kW | 1.1 | |
| Rated operational current in DC | | | | |
| DC21A | 48V | A | 10 | |
| | 60V | A | 7 | |
| | 110V | A | 2 | |
| | 220V | A | 0.7 | |

| | | | |
|--|------|-----------------|-------------------|
| | 440V | A | 0.2 |
| DC13 | 24V | A | 3 |
| | 48V | A | 3 |
| | 60V | A | 2 |
| | 110V | A | 1 |
| | 220V | A | 0.3 |
| | 440V | A | 0.1 |
| Power dissipation | | W | 0.4 |
| Mechanical features | | | |
| Terminals screw | | | 2.5M |
| Tightening torque for terminals max | | Nm | 0.4 |
| Conductor size | | | |
| AWG - Rigid cable | min | AWG | 20 |
| | Max | AWG | 14 |
| AWG - Flexible cable | min | AWG | 20 |
| | Max | AWG | 14 |
| Conductor size (IEC) - Flexible cable | min | mm ² | 0.5 |
| | Max | mm ² | 1.5 |
| Conductor size (IEC) - Rigid cable | min | mm ² | 0.5 |
| | Max | mm ² | 1.5 |
| Mechanical life | | cycles | 1x10 ⁶ |
| UL technical data | | | |
| Motor power for direct-on-line control | | | |
| for three-phase motor | 240V | HP | 2 |
| for single-phase motor | 240V | HP | 0.75 |
| Ambient conditions | | | |
| Temperature | | | |
| Operating temperature | min | °C | -25 |
| | max | °C | +55 |
| Storage temperature | min | °C | -40 |
| | max | °C | +70 |
| Resistance & Protection | | | |
| Frontal IP degree | | | IP40 |
| Terminals IP degree | | | IP20 |
| Dimensions | | | |

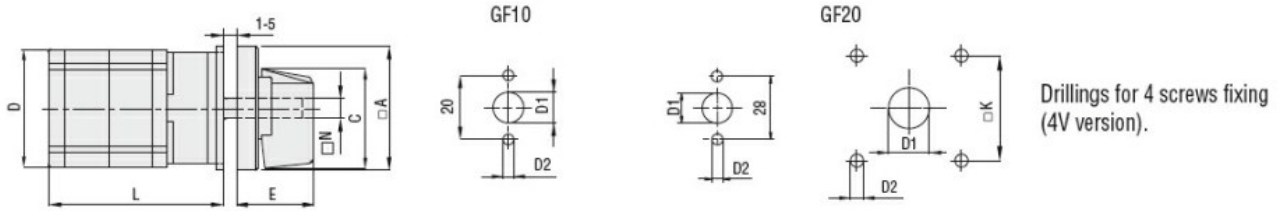

| Series | Dimensions | | | | | | | | L Number of elements | | | | | | | | | | | |
|--------|------------|------|----|-----|-----|------|----|----|----------------------|------|----|------|----|-------|-----|-------|-----|-------|-----|-------|
| | □A | C | D | ØD1 | ØD2 | E | □K | N | 1 | 2 | 3 | 4 | 5 | 6 | 7 | 8 | 9 | 10 | 11 | 12 |
| GF10 | 30 | 24 | 29 | 9 | 3.2 | 18.5 | - | Ø5 | 40 | 52 | 64 | 76 | 88 | 100 | 112 | 124 | - | - | - | - |
| GF20 | 48 | 39.5 | 36 | 12 | 5 | 26.5 | 36 | □6 | 44 | 57.5 | 71 | 84.5 | 98 | 111.5 | 125 | 138.5 | 152 | 165.5 | 179 | 192.5 |

Wiring diagrams

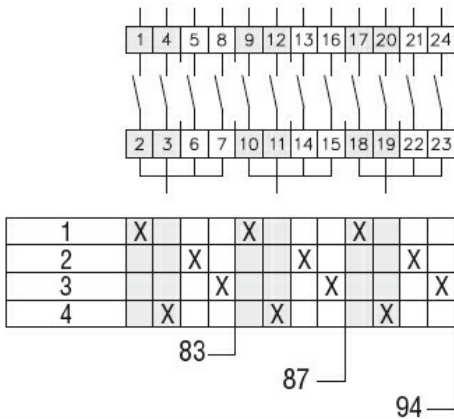

Certifications and compliance

Compliance

- CSA C22.2 n° 14
- IEC/EN/BS 60947-1
- IEC/EN/BS 60947-3
- IEC/EN/BS 60947-5-1
- UL60947-4-1

Certificates

- cULus
- EAC

ETIM classification

ETIM 8.0

EC001029 -
Selector switch,
complete