

DILM32-XTE... XTCEXTE...

- ① DILM32-XTED11, XTCEXTED...C11
- ①, ② DILM32-XTEE11, XTCEXTEEC11

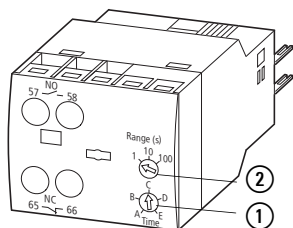

- DILM32-XTEY20
 XTCEXTEYC20

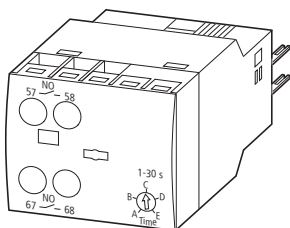

- DILM32-XTEPLH
 XTCEXTESHRD

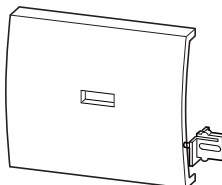

10 mm (0.39")



0.75 - 1.5 mm²

1.2 Nm
 (10.6 lb-in)



0.75 - 2.5 mm²

AWG18 - AWG14

1.2 Nm
 (10.6 lb-in)

en Electric current! Danger to life!
 Only skilled or instructed persons may carry out the following operations.

de Lebensgefahr durch elektrischen Strom!
 Nur Elektrofachkräfte und elektrotechnisch unterwiesene Personen dürfen die im Folgenden beschriebenen Arbeiten ausführen.

fr Tension électrique dangereuse !
 Seules les personnes qualifiées et averties doivent exécuter les travaux ci-après.

es ¡Corriente eléctrica! ¡Peligro de muerte!
 El trabajo a continuación descrito debe ser realizado por personas cualificadas y advertidas.

it Tensione elettrica: Pericolo di morte!
 Solo persone abilitate e qualificate possono eseguire le operazioni di seguito riportate.

zh 触电危险!
 只允许专业人员和受过专业训练的人员进行下列工作。

ru Электрический ток! Опасно для жизни!
 Только специалисты или проинструктированные лица могут выполнять следующие операции.

Mounting – Montage – Montaje – Montaggio – 安装 – Монтаж

- DILA, DILM7, DILM9,
 DILM12, DILM15
 XTRE10B, XTCE007B
 XTCE009B, XTCE012B,
 XTCE015B

1

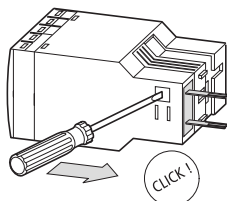

2

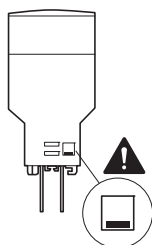

3

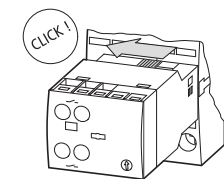

- DILM17, DILM25,
 DILM32, DILM38
 XTCE018C, XTCE025C,
 XTCE032C, XTCE038C

1

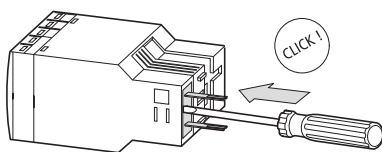

2

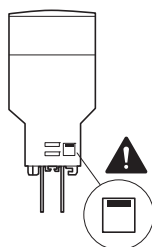

3

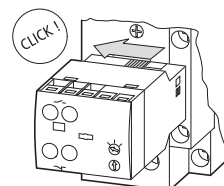

1 DILM32-XTEPLH, XTCEXTESHRD

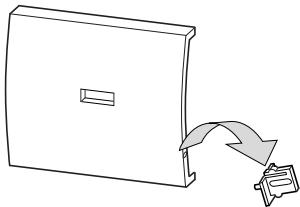

2

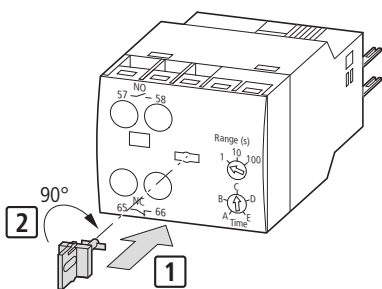

3

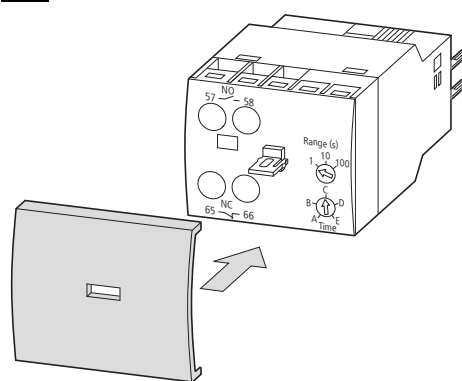

4

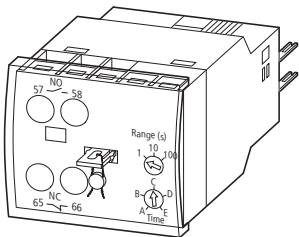

Flow diagrams – Ablaufdiagramme – Diagrammes de fonctionnement – Diagrama de secuencia – Diagramma di sequenza – 过程表 – диаграмма последовательности переключений

DILM32-XTEE11, XTCEXTEEC11

on-delayed
ansprechverzögert
retard à l'appel
temporización de trabajo
ritardato all'eccitazione
接通延时
задержка срабатывания

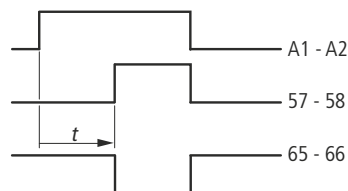

DILM32-XTED11¹⁾, XTCEXTED...C11¹⁾

off-delayed (without auxiliary voltage)
rückfallverzögert (ohne Hilfsspannung)
retard à la chute (sans tension auxiliaire)
temporización de reposo (sin tensión auxiliar)
ritardato alla diseccitazione (senza tensione ausiliaria)
断开延时 (无辅助电压)
Задержка отпущения (без вспомогательного напряжения)

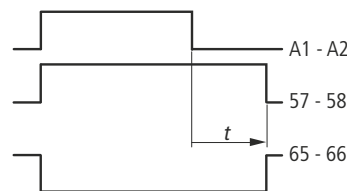

DILM32-XTEY20, XTCEXTEYC20

star-delta function
Stern-Dreieck-Funktion
fonction étoile-triangle
función estrella-triángulo
funzione stella-triangolo
星形三角功能
Функция звезда-треугольник

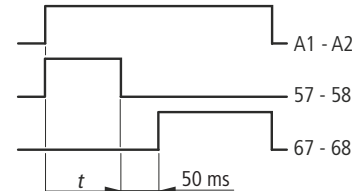

→ As supplied from the factory, the position of the output contacts of the DILM32-XTED11, XTCEXTED...C11 is not defined (bistable relay). Applying the control voltage and switching it off again once only causes the contacts to change over to the correct position.

→ Beim DILM32-XTED11, XTCEXTED...C11 ist die Stellung der Ausgangskontakte im Anlieferungszustand nicht definiert (bistabiles Relais). Ein einmaliges Anlegen und Abschalten der Steuerspannung führt zu einem Kontaktwechsel in die richtige Stellung.

→ Pour DILM32-XTED11, XTCEXTED...C11 position indéfinie des contacts de sortie à la livraison (relais bistable). Le cycle application/coupage de la tension de commande provoque un virement du relais et la mise en position correcte des contacts.

→ Para DILM32-XTED11, XTCEXTED...C11 de serie la posición de los contactos no está definida (relé biestable). Aplicando y retirando una vez la tensión de mando los contactos se conmutan a la posición correcta.

→ Per DILM32-XTED11, XTCEXTED...C11 nella condizione di fornitura, i contatti di uscita sono in una posizione indefinita (relè bistabile). Applicando e disattivando una volta la tensione di comando si provoca la commutazione dei contatti nella posizione corretta.

→ 对于 DILM32-XTED11, XTCEXTED...C11, 在供货时没有定义输出触点的位置 (双稳态继电器)。接上或关闭控制电源就能使触点切换到正确的位置。

→ При поставке с завода, состояние контактов DILM32-XTED11, XTCEXTED...C11 неопределенно (бистабильное реле). Подключение управляющего напряжения единственным способ приведения контактов в однозначное положение.

Range setting – Zeitbereichseinstellung – Choix de la plage de temporisation – Margen de ajuste – Impostazione tempo – 时间范围调整 – установка временной области

DILM32-XTEE11, XTCEXTEEC11

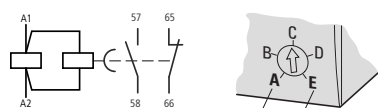

0.05 s - 1 s
0.5 s - 10 s
5 s - 100 s

DILM32-XTED11, XTCEXTED...C11

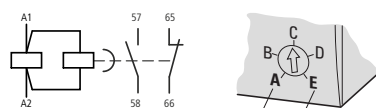

DILM32-XTED11-1: 0.05 s - 1 s
DILM32-XTED11-10: 0.5 s - 10 s
DILM32-XTED11-100: 5 s - 100 s
XTCEXTED1C11: 0.05 s - 1 s
XTCEXTED10C11: 0.5 s - 10 s
XTCEXTED100C11: 5 s - 100 s

DILM32-XTEY20, XTCEXTEYC20

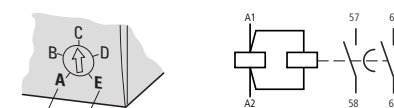

1 s - 30 s
Dead interval on reversing – Umschaltpause – temps de pause de commutation – intervalo de conmutación – intervallo di commutazione – 切换间隙 – Пауза переключения:

50 ms

convertible – umschaltbar – commutable – conmutable – commutabile – 可切换 – Переключаемый