

| | | | | |
|---|----------|----|------|--------------------------------------|
| Product designation | | | | Rotary cam switches |
| Product type designation | | | | GX40 |
| General characteristics | | | | |
| Switching diagram | | | | 85 - Multi-step 1-2-3-4-6 1 pole |
| N° of elements | | | | 3 |
| Mounting form | | | | U - Front mounting with black handle |
| Contact characteristics | | | | |
| Rated insulation voltage U_i | IEC/EN | V | 690 | |
| | UL/CSA | V | 600 | |
| Rated impulse withstand voltage U_{imp} | | kV | 6 | |
| Conventional free air thermal current I_{th} | IEC/EN | A | 40 | |
| | UL/CSA | A | 40 | |
| Rated operational voltage | | V | 440 | |
| Rated operational impulse voltage | | kV | 4 | |
| Maximum fuse size for short-circuit protection I_n (gG) | 10kA | A | 40 | |
| | 15kA | A | 35 | |
| | 25kA | A | 35 | |
| Rated short time current I_{cw} | 1s | A | 1000 | |
| Conductivity | | | | 10/5 mA/V |
| Operational current I_e IEC/EN | | | | |
| AC1/AC21A | | A | 40 | |
| AC15 | 110V | A | 25 | |
| | 220/230V | A | 22 | |
| | 380/400V | A | 12 | |
| | 660/690V | A | 2 | |
| Rated operational power in AC | | | | |
| Three-phase AC-3 | 220/230V | kW | 7.5 | |
| | 380/440V | kW | 15 | |
| | 500/690V | kW | 15 | |
| Single-phase AC-3 | 110V | kW | 2.2 | |
| | 220/230V | kW | 4.4 | |
| | 380/440V | kW | 7 | |
| Three-phase AC23A | 220/230V | kW | 9 | |
| | 380/440V | kW | 18.5 | |
| | 500/690V | kW | 15 | |
| Single-phase AC23A | 110V | kW | 3 | |
| | 220/230V | kW | 5.2 | |
| | 380/440V | kW | 7.5 | |
| Rated operational current in DC | | | | |

| | | | | |
|--|------|-----------------|-------------------|--|
| DC21A | | | | |
| | 48V | A | 40 | |
| | 60V | A | 40 | |
| | 110V | A | 6 | |
| | 220V | A | 0.8 | |
| | 440V | A | 0.25 | |
| DC23A (poles in series) | | | | |
| | 24V | A | 40 (1) | |
| | 48V | A | 40 (1) | |
| | 60V | A | 40 (3) | |
| | 110V | A | 40 (3) | |
| | 220V | A | 12 (4) | |
| DC13 | | | | |
| | 24V | A | 40 | |
| | 48V | A | 32 | |
| | 60V | A | 16 | |
| | 110V | A | 3 | |
| | 220V | A | 0.5 | |
| | 440V | A | 0.15 | |
| Power dissipation | | W | 1.6 | |
| Mechanical features | | | | |
| Terminals screw | | | M4 | |
| Tightening torque for terminals max | | Nm | 1.2 | |
| Conductor size | | | | |
| AWG - Rigid cable | | | | |
| | min | AWG | 16 | |
| | Max | AWG | 8 | |
| AWG - Flexible cable | | | | |
| | min | AWG | 16 | |
| | Max | AWG | 10 | |
| Conductor size (IEC) - Flexible cable | | | | |
| | min | mm ² | 1.5 | |
| | Max | mm ² | 6 | |
| Conductor size (IEC) - Rigid cable | | | | |
| | min | mm ² | 1.5 | |
| | Max | mm ² | 10 | |
| Mechanical life | | cycles | 1X10 ⁶ | |
| UL technical data | | | | |
| Motor power for direct-on-line control | | | | |
| for three-phase motor | | | | |
| | 120V | HP | 5 | |
| | 240V | HP | 10 | |
| | 480V | HP | 15 | |
| | 600V | HP | 15 | |
| for single-phase motor | | | | |
| | 120V | HP | 2 | |
| | 240V | HP | 5 | |
| Ambient conditions | | | | |
| Temperature | | | | |
| Operating temperature | | | | |
| | min | °C | -25 | |
| | max | °C | +55 | |
| Storage temperature | | | | |
| | min | °C | -40 | |

max °C +70

Resistance & Protection

| | |
|---------------------|------|
| Frontal IP degree | IP65 |
| Terminals IP degree | IP20 |

Dimensions

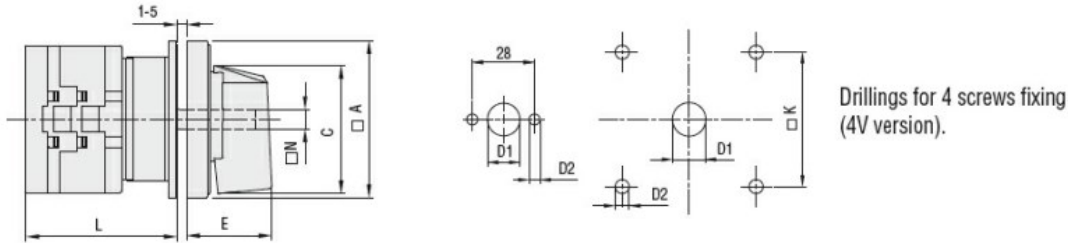

| Series | Dimensions | | | | | | | L Number of elements | | | | | | | | | | | |
|--------|------------|------|-----|-----|------|----|----|----------------------|------|----|------|----|------|-----|-------|-----|-------|-----|-------|
| | □A | C | ∅D1 | ∅D2 | E | □K | □N | 1 | 2 | 3 | 4 | 5 | 6 | 7 | 8 | 9 | 10 | 11 | 12 |
| GX16 | 48 | 39.5 | 12 | 5 | 26.5 | 36 | 6 | 43 | 51.5 | 60 | 68.5 | 77 | 85.5 | 94 | 102.5 | 111 | 119.5 | 128 | 136.5 |
| GX20 | 48 | 39.5 | 12 | 5 | 26.5 | 36 | 6 | 43 | 51.5 | 60 | 68.5 | 77 | 85.5 | 94 | 102.5 | 111 | 119.5 | 128 | 136.5 |
| GX32 | 65 | 53 | 14 | 5 | 34.5 | 48 | 7 | 51 | 63 | 75 | 85 | 99 | 111 | 123 | 135 | 147 | 159 | 171 | 183 |
| GX40 | 65 | 53 | 14 | 5 | 34.5 | 48 | 7 | 51 | 63 | 75 | 85 | 99 | 111 | 123 | 135 | 147 | 159 | 171 | 183 |

Wiring diagrams

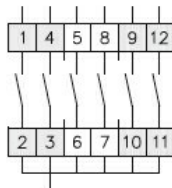

| | | | | | |
|---|---|---|---|---|---|
| 1 | X | | | | |
| 2 | | | X | | |
| 3 | | | | | X |
| 4 | | X | | | |
| 5 | | | | X | |
| 6 | | | | | X |

85

Certifications and compliance

Compliance

- CSA C22.2 n° 14
- IEC/EN/BS 60947-1
- IEC/EN/BS 60947-3
- IEC/EN/BS 60947-5-1
- IEC/EN/BS 61058-1
- UL60947-4-1

Certificates

- cULus
- EAC

ETIM classification

ETIM 8.0

EC001029 - Selector switch, complete