

# PLANETE 400 ES ADR CGLine+

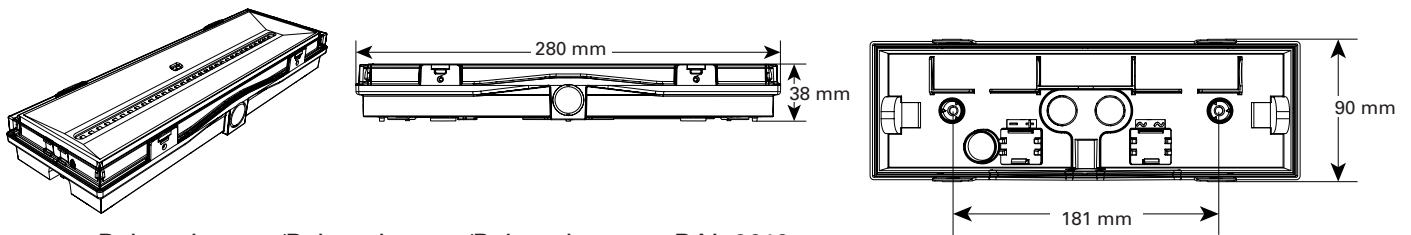

+ centrale de gestion web/web-controller/web-controller ADR 1L511/CGLine+

AEAS  
www.lcie.fr

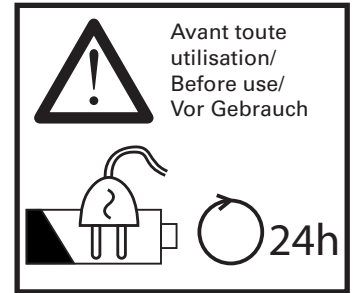
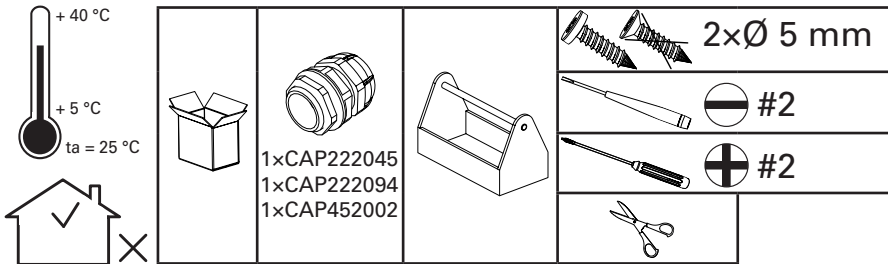

Polycarbonate/Polycarbonate/Polycarbonat RAL 9010

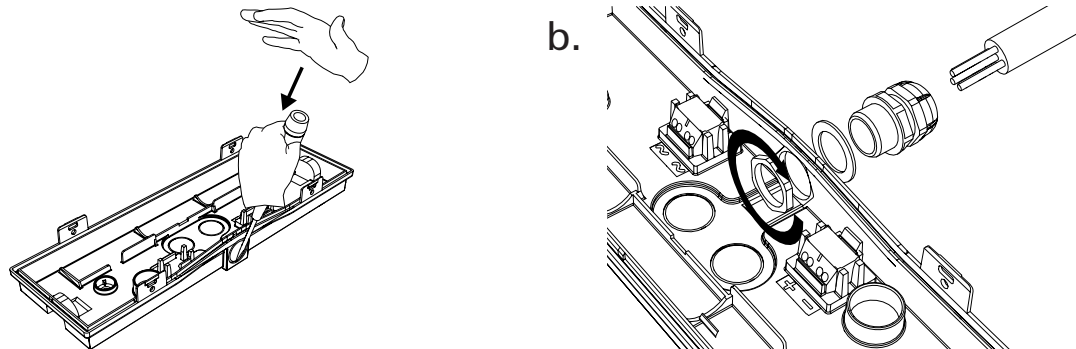
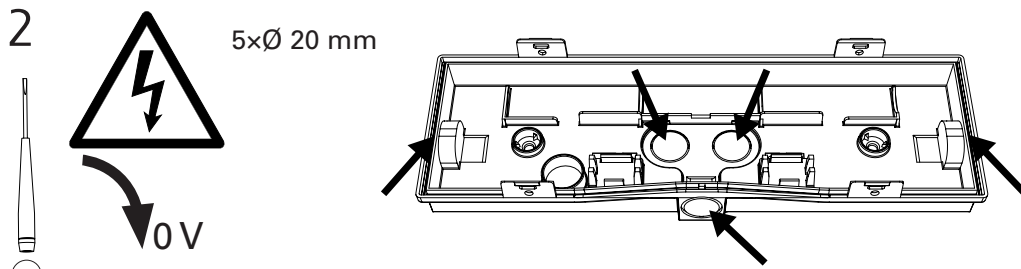
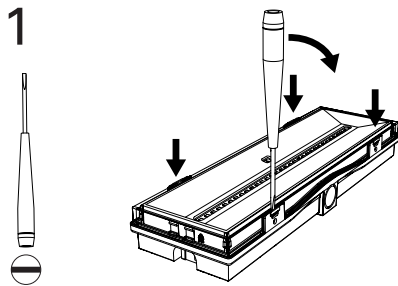

Powering Business Worldwide

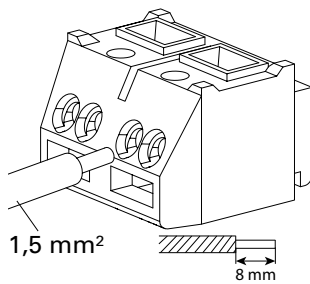
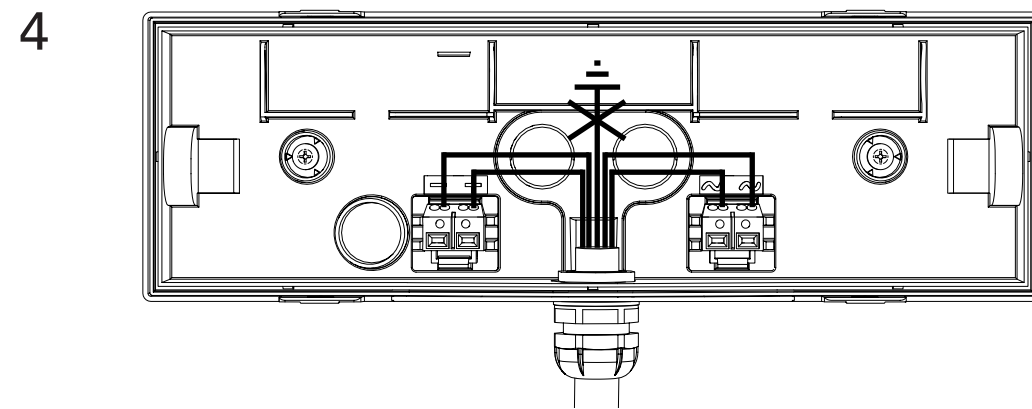
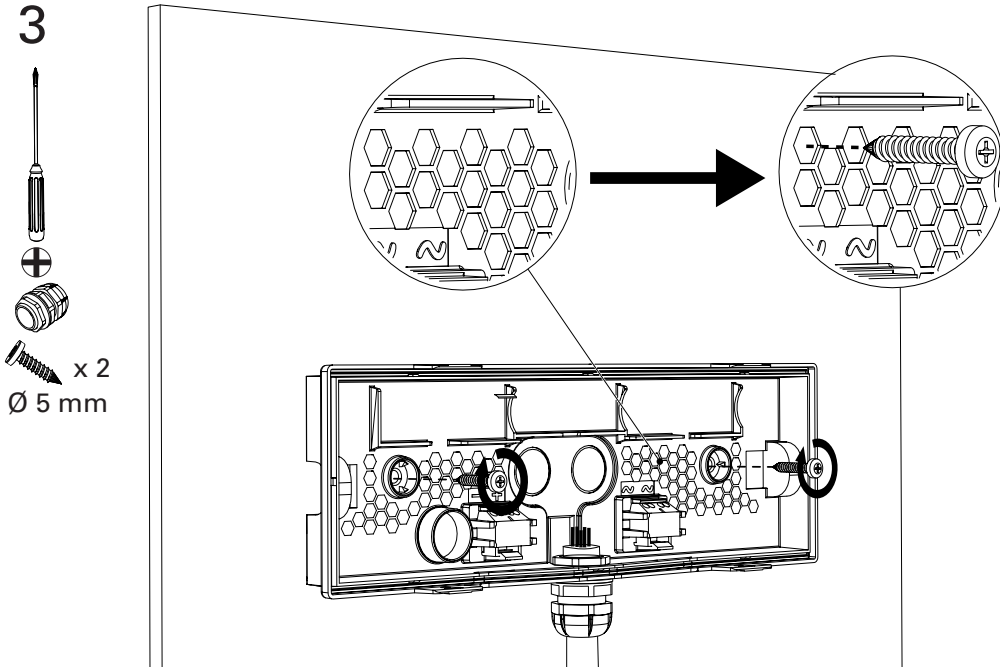

Câble rigide/  
Rigid wire/  
Starres Kabel

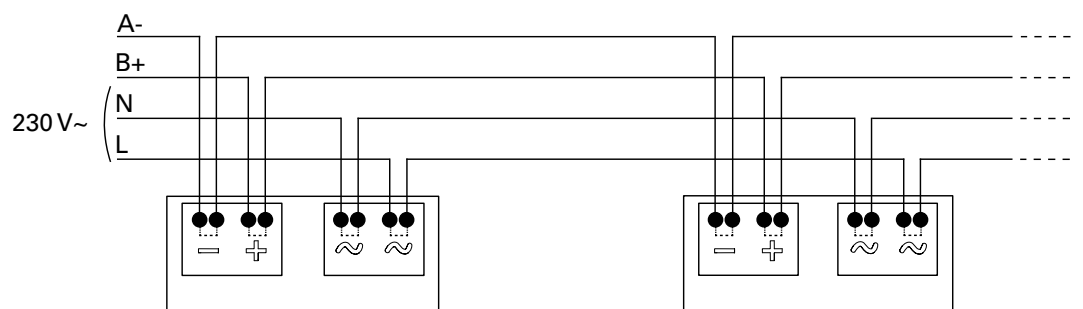

Décalage Test Autonomie/Duration Test postponing/Betriebsdauertest verschieben

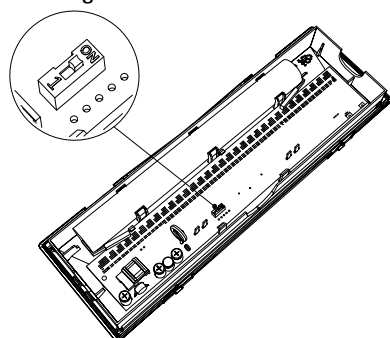

1 (OFF)



ON



+ 7 jours/days/Tage

5

a.

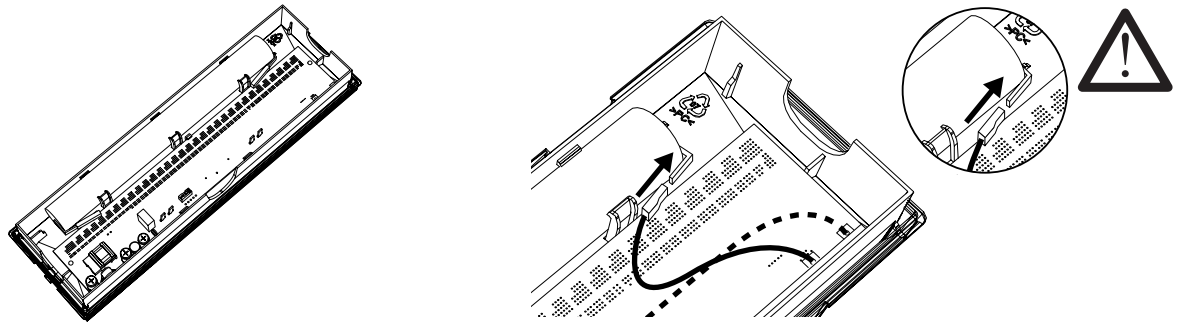

b.

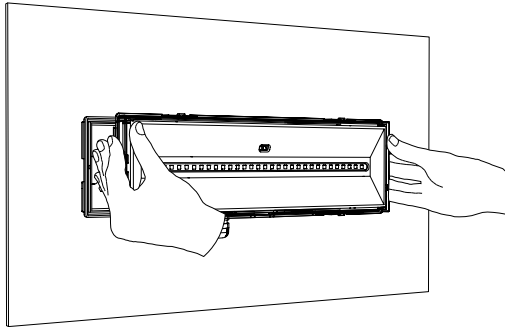

c.

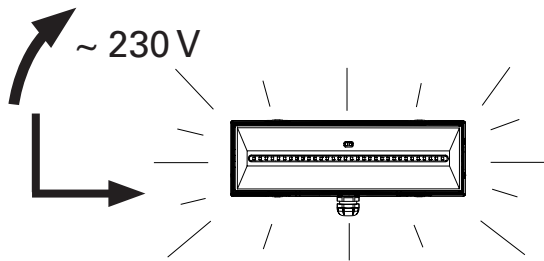

# Autotest / SATI

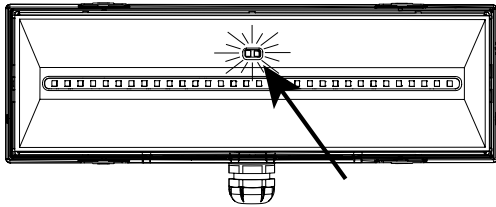

V/G/Gr		OK
V/G/Gr		Test
V/J / G/Y / Gr/Ge		·)))))) com/com/kom
J/Y/Ge		2 s
J/Y/Ge		0,5 s

## Test

charge/charge/Ladung

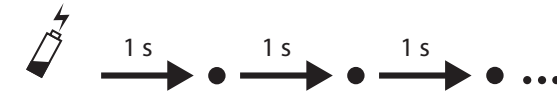

lampe/lamp/Lampe

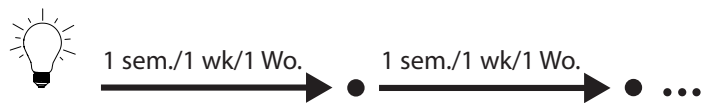

batterie/battery/Batterie

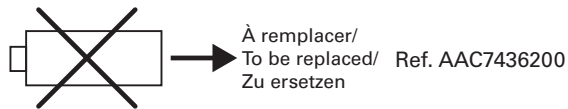

## Programmation de l'heure des tests/Test hour programming/Testdatumprogrammierung

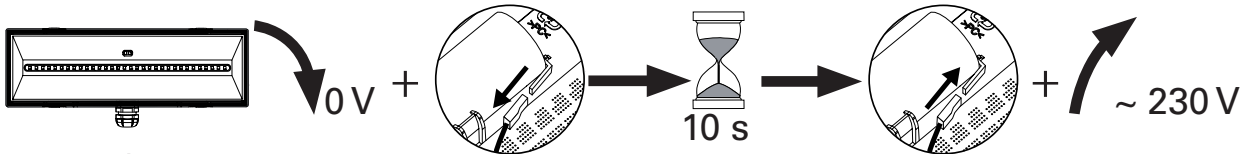

ou/or/oder

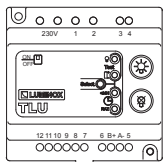

TLU  
LUM10312

	<b>NF</b>	<b>IP/IK</b>				<b>U</b>	<b>P</b>	<b>EN</b>	<b>FR</b>	
PLANETE 400 ES ADR CGLine+	LUM17147	T15003	66/08	1	360	230 V~/50-60 Hz	1,1 W	NFEN 60598.1 NFEN 60598.2.22	NFC 71801 NFEN 62034 C 71820-1 (NFEN 62034) NF 4113	



**Eaton**  
**Cooper Sécurité SAS**  
PEE II - Rue Beethoven - BP10184  
63204 RIOM CEDEX FRANCE  
Tél. +33 (0)825 826 212 (0,15 €TTC/min)  
www.cooperfrance.com  
www.eaton.eu

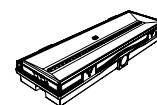

FR : [www.recylum.com](http://www.recylum.com)

© 2015 Eaton  
Tous droits réservés.  
All rights reserved.  
Alle Rechte vorbehalten.

