

### INSTRUCTIONS CM549

© Panduit Corp. 2011

## PANDUIT Combination Lock Swinghandle Replacement

### NET-SERV DOOR APPLICATIONS

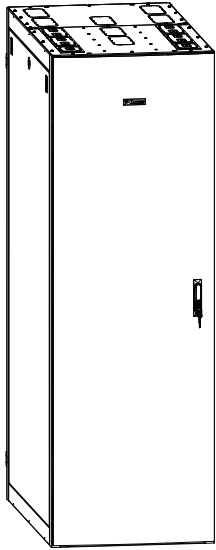

**Single Hinge Door**  
(See page 2)

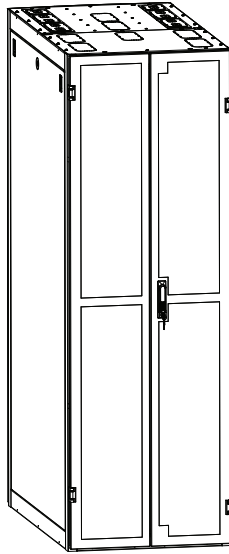

**Handle-Side Split Door**  
(See page 3)

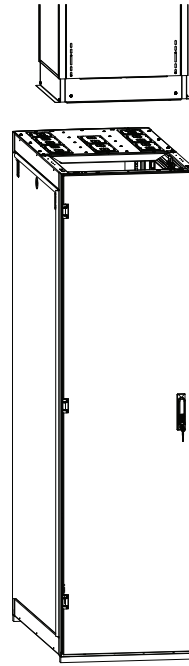

**Single Hinge Solid Door**  
(See page 3)

### NET-ACCESS DOOR APPLICATIONS

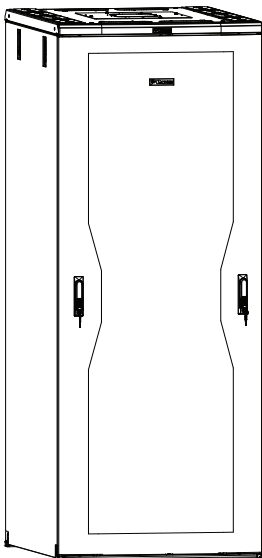

**DUAL HINGE DOOR**  
(See Page 4)

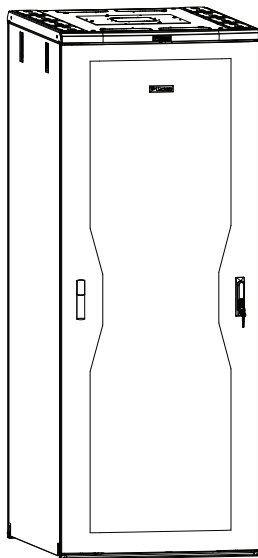

**SINGLE HINGE DOOR**  
(See page 5 for door removal)  
(See page 2 for door handle)

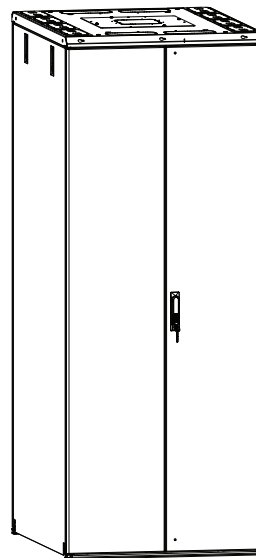

**SOLID SPLIT DOOR**  
(See page 5 for door removal)  
(See page 3 for door handle)

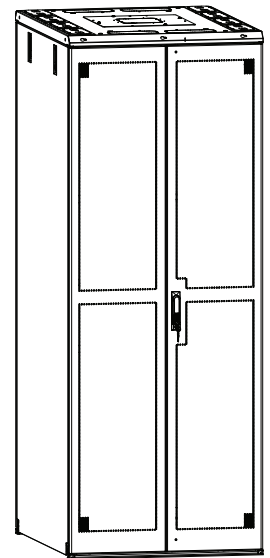

**PERF. SPLIT DOOR**  
(See page 5 for door removal)  
(See page 3 for door handle)

## NET-SERV Single Hinge Door Removal

**NOTE:** For best results, remove single hinge door from cabinet before replacing stock swinghandle with CCL Combination Lock Swinghandle.

Pull down the levers of the spring loaded hinge pins as indicated in the view to the right and remove door from cabinet frame. Reverse steps to re-install the door.

**NOTE:** Make sure that both pins are fully engaged when door is installed.

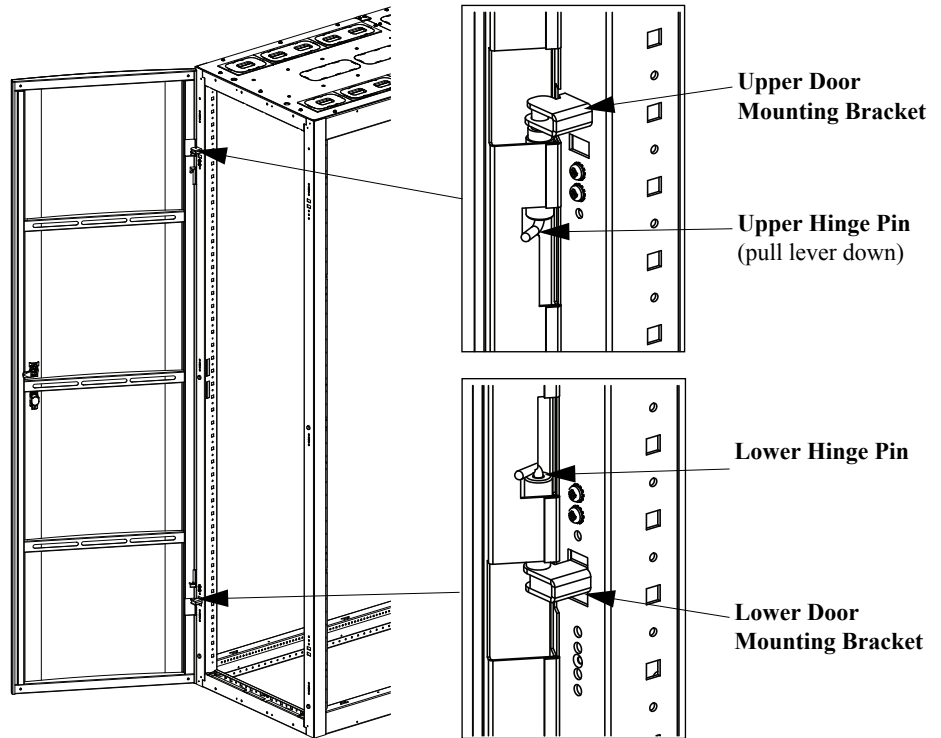

## Door Cam Swinghandle Replacement

### Remove Stock Swinghandle

Remove adapter screw from handle assembly. Remove bridge screw and bridge from handle. Slide door handle hook out of position and remove stock swinghandle from door.

### Install Combination Lock Swinghandle

Position handle assembly of combination lock swinghandle in openings of single hinge door. Secure handle to door by installing Bearing Plate and Bearing Plate screws. Install Bottom Clamping Plate and Bottom Clamping Plate Screws. Position cam stop between handle cam and handle assembly with adapter tab at 9:30 clock position (from inside of door). Secure handle cam to handle with adapter screw. (Use included 1/4" SAE flat washer if adapter screw is longer than 1/2")

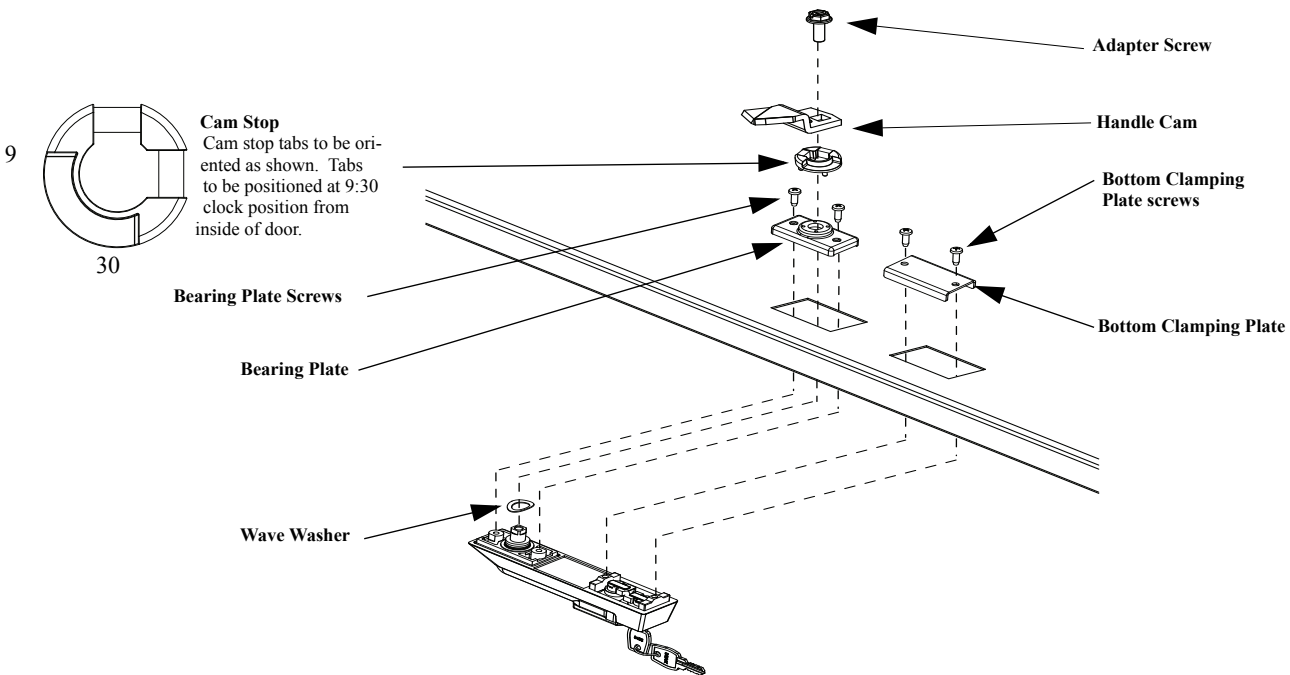

VIEW OF INSIDE OF DOOR CAM ASSEMBLY

## Handle-Side Split Door & Solid Single Hinge Door Removal (Rear of Cabinet)

**NOTE:** For best results, remove handle-side split door from cabinet before replacing stock swinghandle with Combination Lock Swinghandle.

To remove split, and solid single hinge door, first disconnect grounding jumper between door and cabinet frame (grounding jumper is located near bottom of door). Close door and remove (2) hinge pins of handle-side door (3) hinge pins on solid single hinge door (hinges include a safety feature that keeps doors captive unless they are open to 90°). Open split door to 90° and slide door away from cabinet and out of hinges. Reverse steps to re-install door.

With split door open to 90° slide door out of hinges

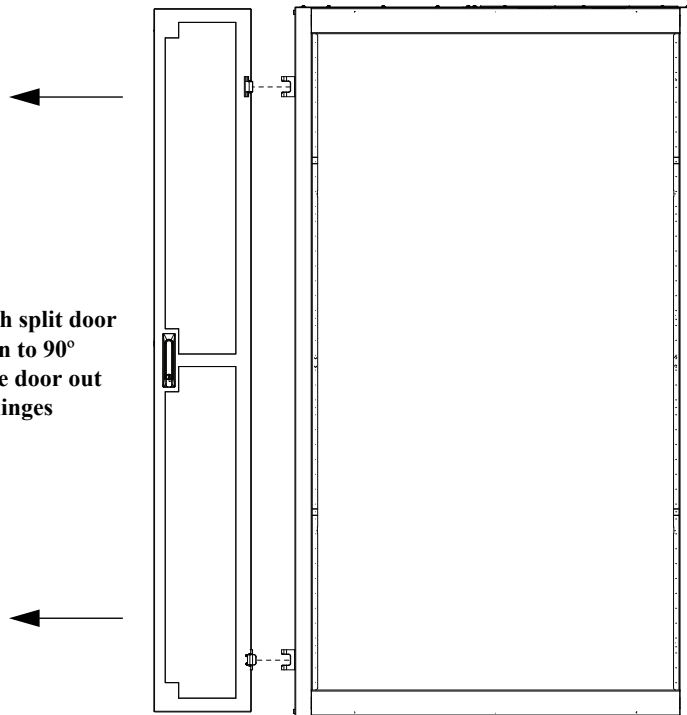

Remove (2) hinge pins from split door (3) hinge pins from solid single hinge door.

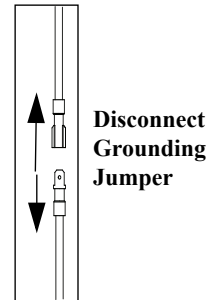
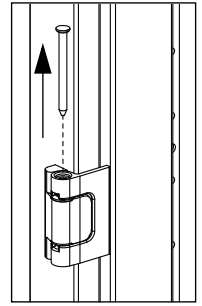

Disconnect Grounding Jumper

## Door Rod Assembly Swinghandle Replacement

### Remove Stock Swinghandle

Remove adapter screw and cam stop from handle assembly (leave door rods attached to handle cam). Remove bridge screw and bridge from handle. Slide door handle hook out of position and remove stock swinghandle from split door.

### Install Combination Lock Swinghandle

Position handle assembly of combination lock swinghandle in openings of split door. Secure handle to door by installing Bearing Plate and Bearing Plate screws. Install Bottom Clamping Plate and Bottom Clamping Plate Screws. Position cam stop between handle cam and handle assembly with cam stop tab at 3:00 clock position (from inside of door). Secure handle cam to handle with adapter screw. (Use included 1/4" SAE flat washer if adapter screw is longer than 1/2")

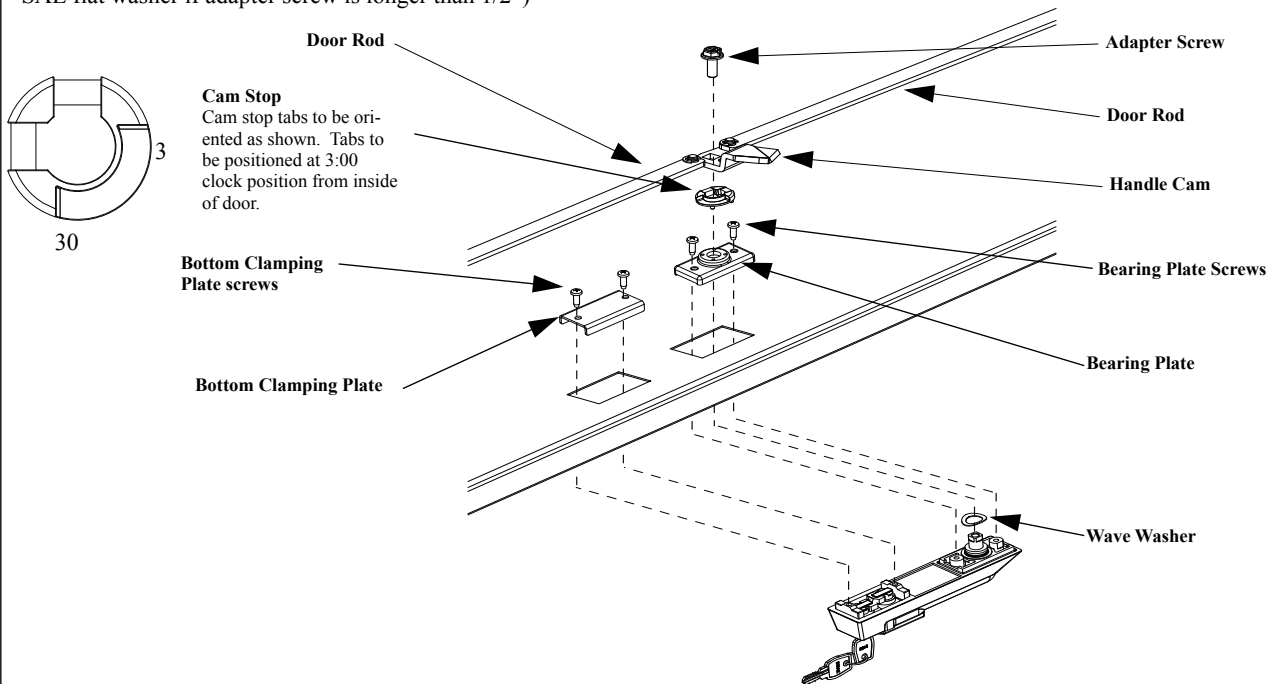

VIEW OF INSIDE OF DOOR ROD ASSEMBLY

## Dual Hinge Door Removal and Installation (CNDDE)

**NOTE:** For best results, Leave dual hinge door on cabinet while replacing stock swinghandle with Combination Lock Swinghandle. (Handle can be replaced with door attached or removed.)

To remove, support the door on the open side with one hand while retracting the hinge pin with the other hand as described to the right.

To re-install, lift door and insert lower hinge pin into the bushing in the bottom door support. Orient the door so the top hinge pin is near the top cabinet bushing. Using a pinching action, pull the red finger handle over and down to retract the hinge pin. Release the red finger handle when aligned with the top bushing

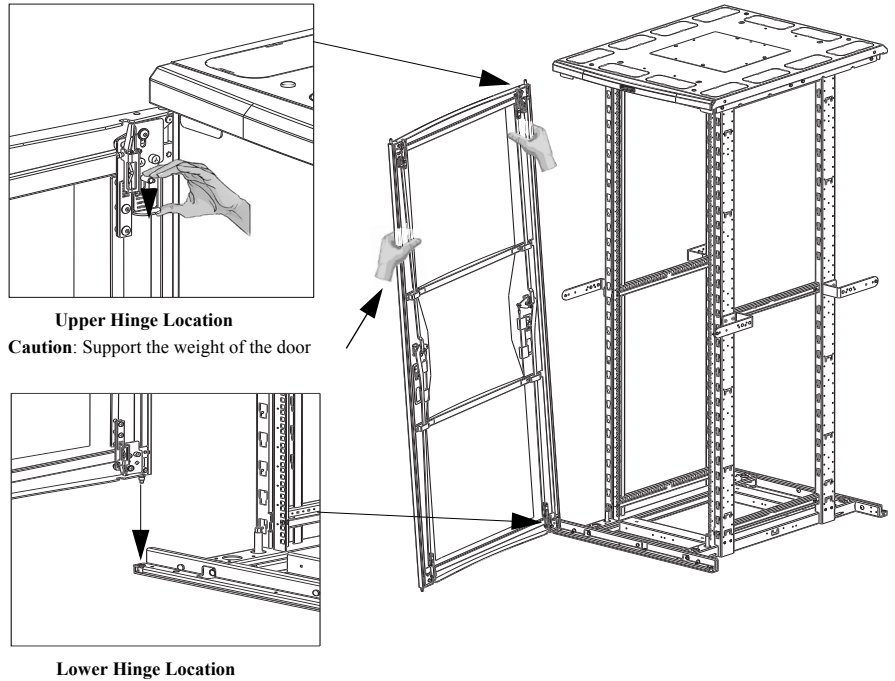

## Dual Hinge Door Swinghandle Replacement

### Remove Stock Swinghandle

Remove top door rod guide. Remove rope bracket screw and replace with provided #12-24 hex head screw and #12 lock washer. Remove adapter screw from handle assembly (leave door rods attached to handle cam). Move door rod assembly over to access door handle. Remove door handle by depressing two (2) spring loaded tabs under the cam assembly.

### Install Combination Lock Swinghandle

Position handle assembly of combination lock swinghandle in openings of dual hinge door. Secure handle to door by installing Bearing Plate with Bearing Plate screws. Install Bottom Clamping Plate with Bottom Clamping Plate Screws. With swinghandle in open position, install cam stop between the rope bracket and handle assembly with cam stop tab as shown below. Secure handle cam to handle with adapter screw. Re-install top door rod guide.

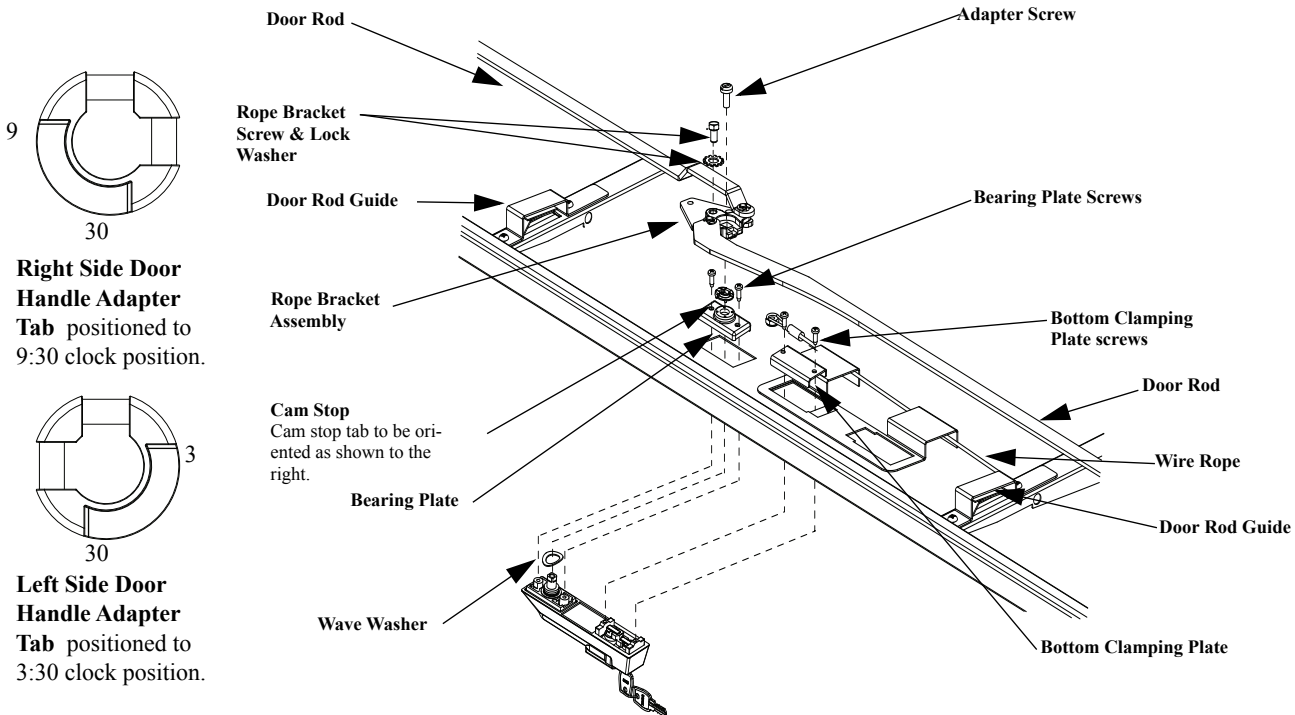

VIEW OF INSIDE OF DUAL HINGE DOOR

## Single Hinge and Handle Side Split Door Removal and Installation

**NOTE:** For best results, remove door from cabinet before replacing stock swinghandle with Combination Lock Swinghandle.

To remove, support the door on the open side with one hand while retracting the hinge pin with the other hand as described to the right.

To re-install, lift door and insert lower hinge pin into the bushing in the bottom door support. Orient the door so the top hinge pin is near the top cabinet bushing. Pull upper hinge pin lever down and align the hinge pin with the bushing and release hinge pin lever.

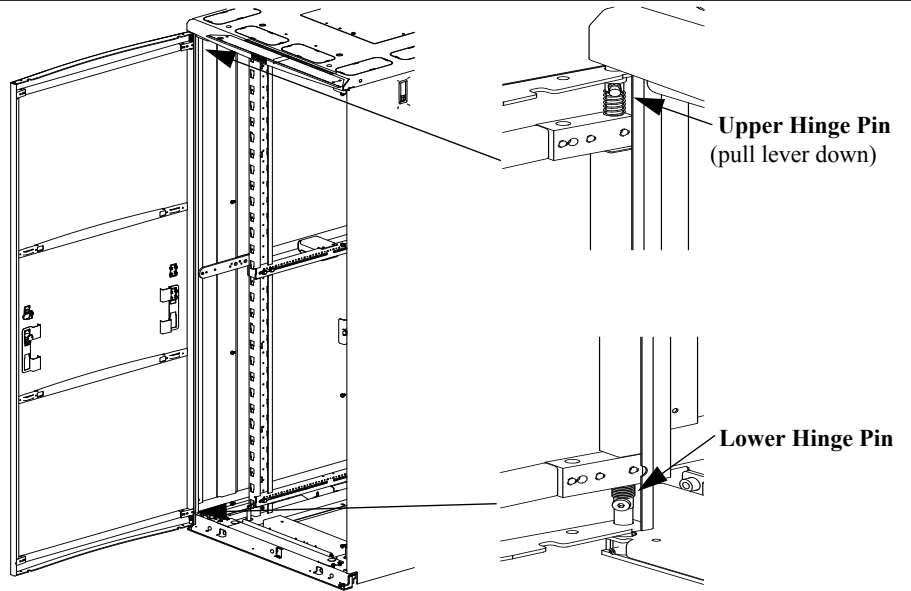

### Original combination set

1. Make sure the combination wheels are at the original position "0-0-0".
2. Use a sharply pointed object (i.e. screwdriver, pen etc.) and aim the tip to the small round hole located on the bottom of the lock cylinder, push in and hold.
3. Turn the three wheels to your desired new combination position and release the tip.

### To Reset

1. Turn the combination to your current set position.
2. Repeat steps 2 and 3 to obtain your new codes.

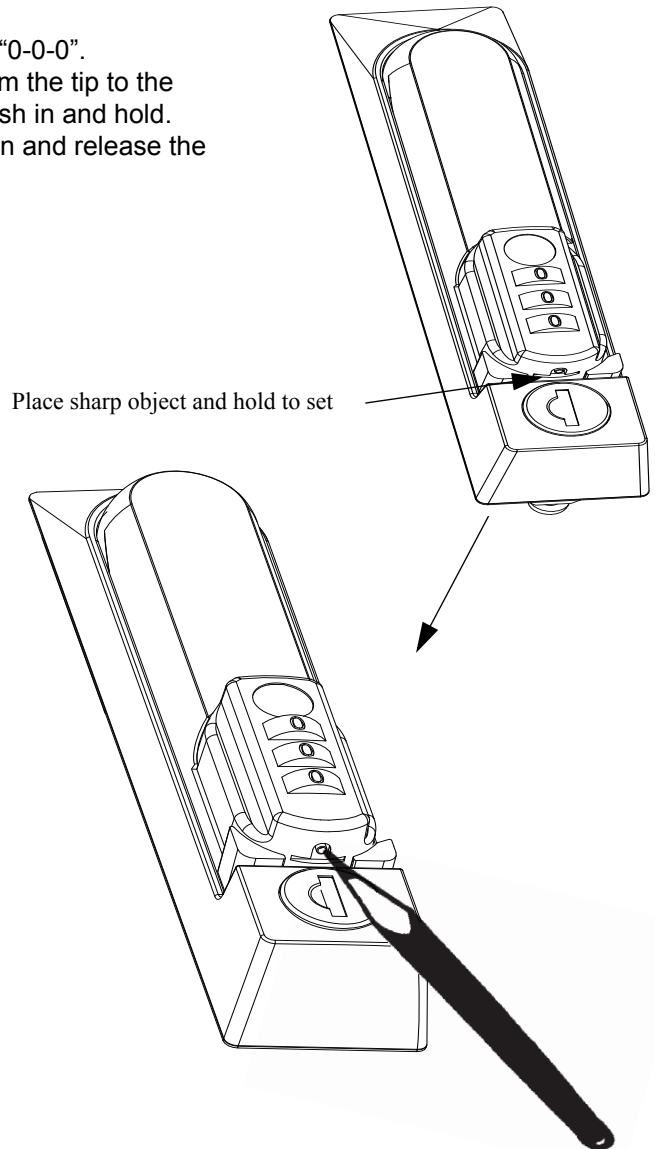
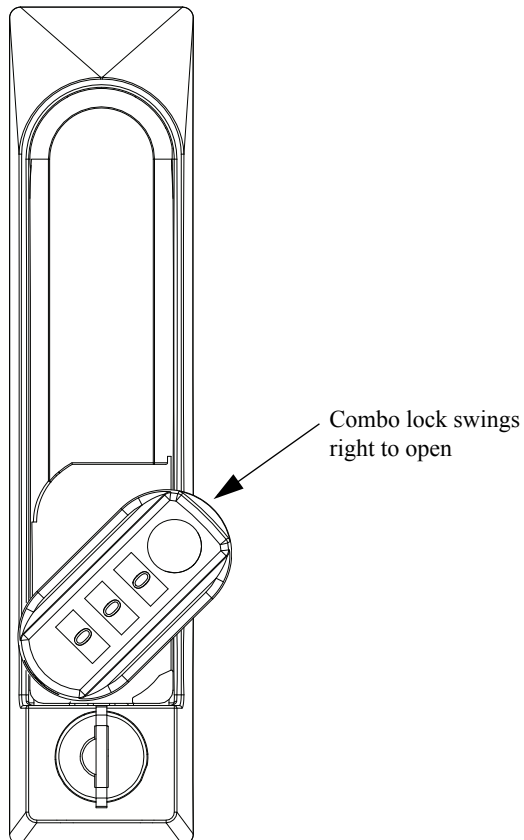

**THIS PAGE LEFT BLANK INTENTIONALLY**