

Tetra

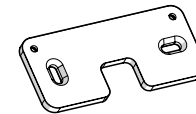

Class 1
LED



x1



x2



x2

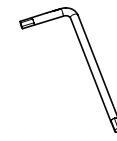

x1



x1

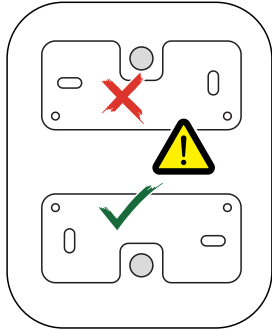

1 Traçage & perçage des trous de fixation Trace & drill the mounting holes

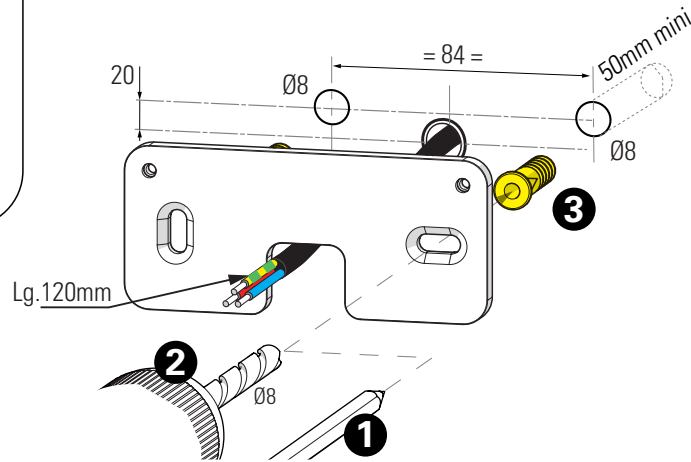

2 Fixation de la platine au mur Fix the wall-plate to the wall

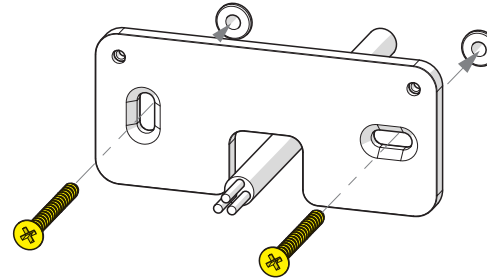

3 Retirer l'embase Remove the base

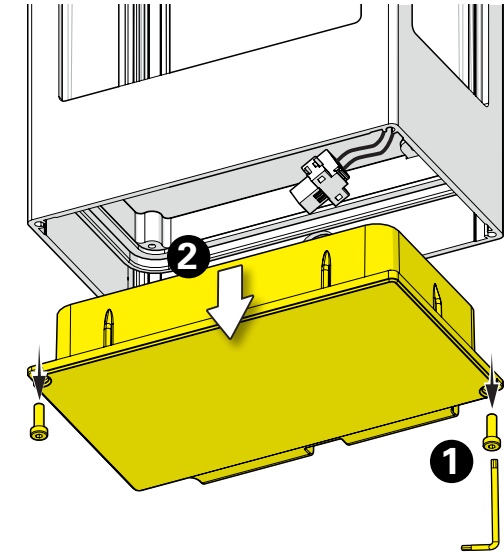

4 Fixer l'embase sur la platine Fix the base to the wall-plate

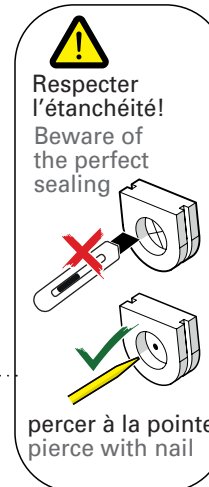
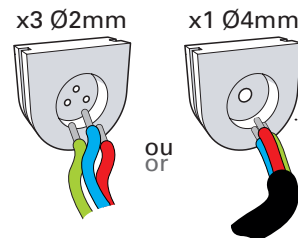
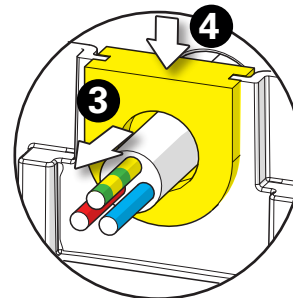
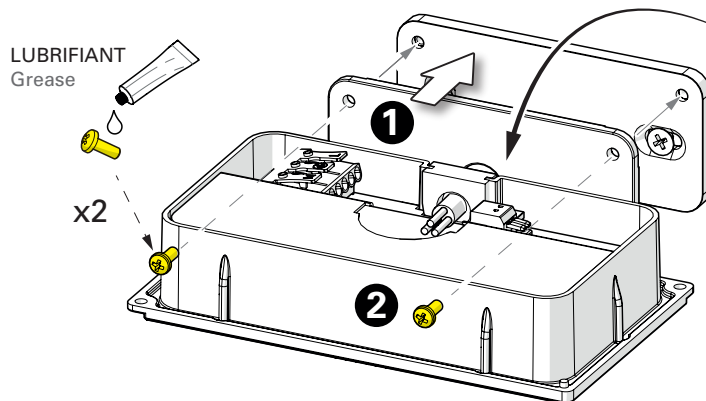

5 Raccordement électrique Connect electrical wires

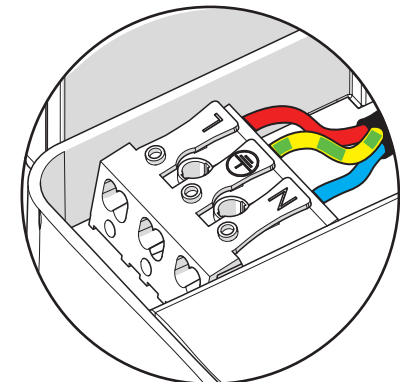

6 Raccordement de la platine
Connect LED module

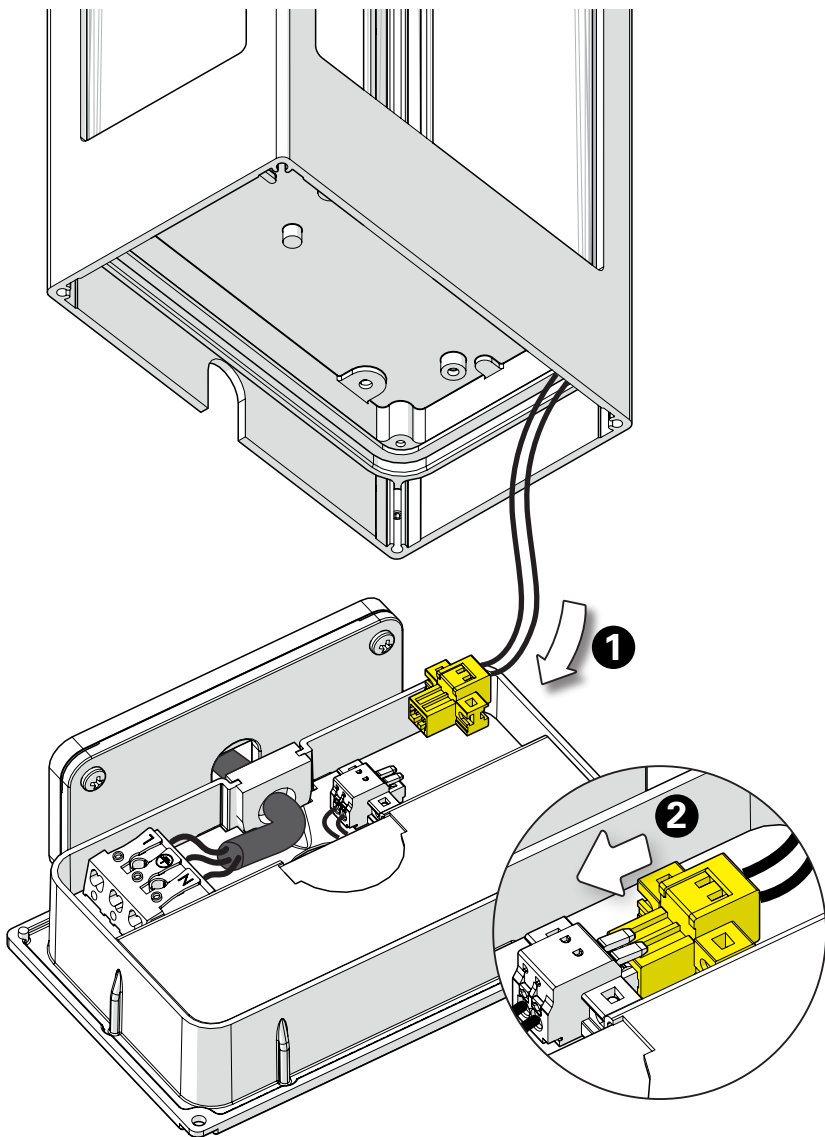

7 Montage du cadre sur l'embase
Install the frame on the base

