

2

1

THIS COPY IS PROVIDED ON A RESTRICTED BASIS AND IS NOT TO BE USED IN ANY WAY DETRIMENTAL TO THE INTERESTS OF PANDUIT CORP.

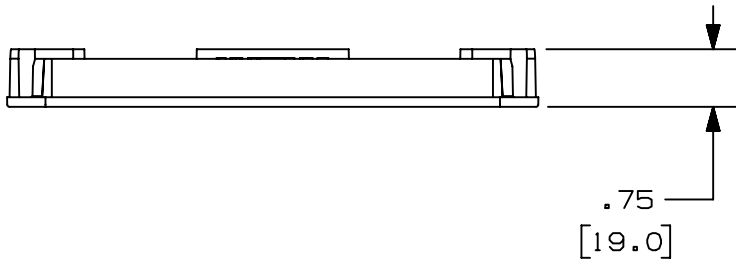

PANDUIT PART NUMBER	WEIGHT	MATERIAL
FREC6X4**	0.2 LB/EACH (91g/EACH)	ABS
FREC6X4L**	0.2 LB/EACH (91g/EACH)	PC/ABS



NOTES:

- SEE CURRENT CATALOG FOR ADDITIONAL PART SUFFIXES TO INDICATE COLOR AND/OR PACKAGE QUANTITY.
- DIMENSIONS IN PARENTHESES ARE IN METRIC.

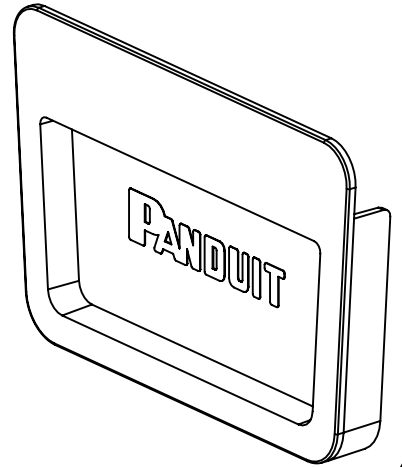
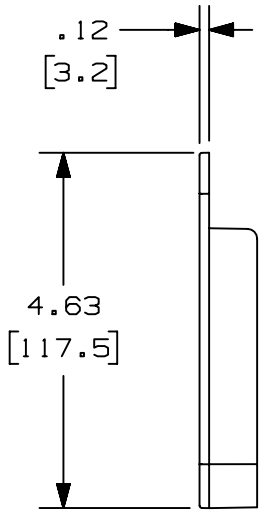
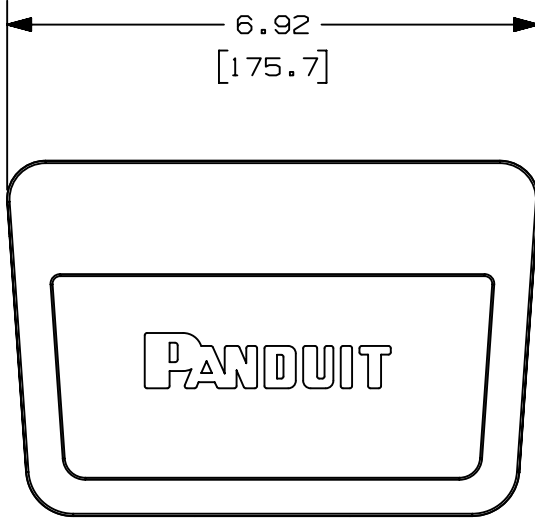

REV	DATE	BY	CHK	APR	DESCRIPTION	ECN
04A	1-16-20	MES	DWR	DWR	J. ADDED FREC6X4L** PART NUMBER	V09002DZ/01
3	05-09-13	JBN	RTFI	RN	I. UPDATED DRAWING BORDER & TITLE BLOCK	37185-77

TITLE FIBERRUNNER 6X4 END CAP FREC6X4**, FREC6X4L**		PANDUIT
CUSTOMER DRAWING		
ITEM REVISION NAME D37185FE/01		MATERIAL: SEE PART NUMBER TABLE ABOVE
DATASET FILE NAME D37185FE_DC/04A		
UNLESS OTHERWISE SPECIFIED, DIMENSIONAL TOLERANCES ARE: IN [mm] .X ± .03 [.8] .XXX ± .XX ± .03 [.8] ANGLES ±		
DRAWN BY REWE		DRAWING NUMBER: 37185-77
DATE 05-09-00	CHK SMF	SCALE NONE
THIRD ANGLE PROJECTION		SHT 1 OF 1
SIZE A		

2

1

D10100DA/15