

GHG 263 - Ex-safety switches for three-phase drives 40 A



3-pole, 40 A

Technical data

Ex-safety switches 40 A for controlled three-phase drives

Marking accd. to 2014/34/EU	Ⓔ II 2 G Ex ed ia IIC T6 / Ⓔ II 2 D Ex tD A21 IP66 T80 °C
EC-Type Examination Certificate	PTB 99 ATEX 1161
IECEX Certificate of Conformity	BKI 07.0012
Marking accd. to IECEx	Ex ed ia IIC T6 Ex tD A21 IP66 T53 °C
Permissible ambient temperature	-20 °C up to +40 °C ¹⁾
Rated voltage	up to max. 690 V
Rated current	max. 40 A
Frequency	50/60 Hz
Rated making/breaking capacity AC-3 accd. EN 60947-3	U _e 230 V / I _e 40 A U _e 400 V / I _e 40 A U _e 500 V / I _e 40 A U _e 690 V / I _e 32 A
Back-up fuse	up to 400 V AC: 80 A gG up to 500 V AC: 80 A gG up to 690 V AC: 63 A gG
Connecting terminals	main contact 2 x 16 mm ² auxiliary/signal contact 2 x 4 mm ²
Protection class	I
Degree of protection accd. to EN 60529	IP66
Cable glands/enclosure drilling	M25 cable gland see ordering details M40 cable gland see ordering details M50 cable gland see ordering details Option: metal flange with 2 x thread
Weight	approx. 4.3 kg
Enclosure material	glass-fibre reinforced polyester
Enclosure colour	black
Aux. contact	1 x NO making - lagging; breaking - leading 1 x NC making - leading; breaking - lagging
Safety interlock for electronics	1 x NO making - lagging; breaking - leading
Padlocking facility	can be locked in OFF position with 3 commercially available padlocks (Ø max. 6 mm)

¹⁾ Other ambient temperatures on request



3-pole, 40 A

Ordering details

Content	Cable gland	Order No.
Safety switch 40 A 3-pole Version with 2 auxiliary contacts (1 NO; 1 x NC), 1 x Safety interlock for electronics (1 x NO)		
3-pole	2 x M40 / 2 x M25	GHG 263 0053 R0001

Customized version on request, auxiliary contacts in Ex ia available

Accessories

Type	Application	Fixing method	Order No.
Mounting plate for Ex-safety switches 125 A/180 A 3-pole			
Size 3	2 x pipe clamp	screw-on ¹⁾	GHG 610 1953 R0110

¹⁾ observe mounting distance

Type	OU	Order No.
Accessories for mounting plates		
Label holder with label (unlabelled) for mounting plate size 1, 2, 2A and 3	10	GHG 610 1953 R0057
Mounting set for pipes 1" (of 27 - 30 mm) for mounting plates with pipe fixing	10	GHG 610 1953 R0020

Please pay attention that only order units (OU) according to the ordering details can be delivered.

Dimension drawing

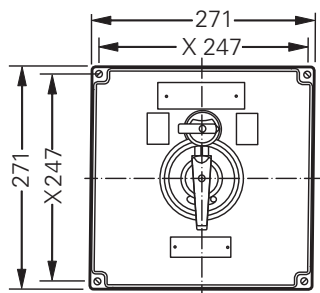

Ex-safety switches 40 A

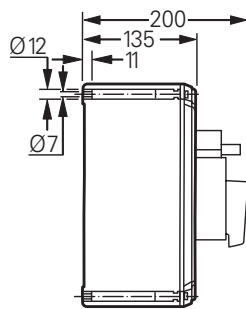

X = fixing dimensions