



ZS3608-DPA0262VZK

Zx36

MOBILE HANDHELD SCANNERS

**SICK**  
Sensor Intelligence.



### Ordering information

Type	Part no.
ZS3608-DPA0262VZK	6073736

Other models and accessories → [www.sick.com/Zx36](http://www.sick.com/Zx36)



### Detailed technical data

#### Features

<b>Version</b>	Standard Density (DPA)
<b>Application</b>	Industrial application
<b>Country approval</b>	India
<b>Scanner design</b>	Cable connection variant
<b>Sensor resolution</b>	1,280 px x 960 px
<b>Light source</b>	LED, Visible, Warm white, Direct LED, Visible, Red, 634 nm, diffuse
<b>Alignment aid</b>	LED, Red, 630 nm
<b>Reading distance</b>	3 mm ... 125 mm
<b>Code resolution</b>	≥ 0.08 mm <sup>1)</sup> ≥ 0.13 mm <sup>2)</sup>
<b>Authorizations</b>	BIS-conformity

<sup>1)</sup> Valid for Code 39.

<sup>2)</sup> Valid for Data Matrix code.

#### Mechanics/electronics

<b>Supply voltage</b>	5 V DC, ± 10 %, Via host 12 V DC, ± 5 %, External supply
<b>Current consumption</b>	Operation: 360 mA Standby current: 100 mA
<b>Housing color</b>	Blue, black
<b>Enclosure rating</b>	IP65 IP68
<b>Weight</b>	304 g
<b>Dimensions (L x W x H)</b>	132 mm x 77 mm x 185 mm

#### Performance

<b>Readable code structures</b>	1D codes
---------------------------------	----------

<b>Bar code types</b>	Code 39
<b>2D code types</b>	Data Matrix
<b>Stacked code types</b>	PDF417
<b>Code alignment</b>	Omni-directional
<b>Battery power</b>	3,100 mAh, over 100,000 scans with full battery
<b>Code buffer</b>	9,000 Codes (EAN, for scanning in batch mode)
<b>Authorizations</b>	BIS-conformity KC-conformity

Interfaces

<b>Ethernet</b>	✓, TCP/IP, RS-232 TTL
Type of fieldbus integration	Optional over external fieldbus module CDF600-2 Optional over external fieldbus module CDF600-2 Optional over external fieldbus module CDF600-2 Optional over external fieldbus module CDF600-2
Function	PROFINET Single Port, PROFINET Dual Port Keyboard wedge, COM-Port emulation
<b>Optical indicators</b>	2 LEDs (operational status, good read)
<b>Acoustic indicators</b>	Beeper, can be switched off
<b>Vibration</b>	Yes
<b>Configuration software</b>	Z-Up Tool

Ambient data

<b>Shock resistance</b>	Multiple falls onto concrete from a height of 2.4 m
<b>Ambient operating temperature</b>	-30 °C ... +50 °C
<b>Storage temperature</b>	-40 °C ... +70 °C
<b>Permissible relative humidity</b>	95 %, Non-condensing
<b>Ambient light immunity</b>	108,000 lx

General notes

<b>Note</b>	Not free of paint wetting impairment substances.
-------------	--

Classifications

<b>ECLASS 5.0</b>	27280101
<b>ECLASS 5.1.4</b>	27280101
<b>ECLASS 6.0</b>	27280101
<b>ECLASS 6.2</b>	27280101
<b>ECLASS 7.0</b>	27280101
<b>ECLASS 8.0</b>	27280101
<b>ECLASS 8.1</b>	27280101
<b>ECLASS 9.0</b>	27280101
<b>ECLASS 10.0</b>	27280101
<b>ECLASS 11.0</b>	27280101
<b>ECLASS 12.0</b>	27280101
<b>ETIM 5.0</b>	EC002550
<b>ETIM 6.0</b>	EC002550
<b>ETIM 7.0</b>	EC002550

<b>ETIM 8.0</b>	EC002550
<b>UNSPSC 16.0901</b>	43211701

### Connection diagram

PROFINET IO/RT

#### PROFINET IO/RT

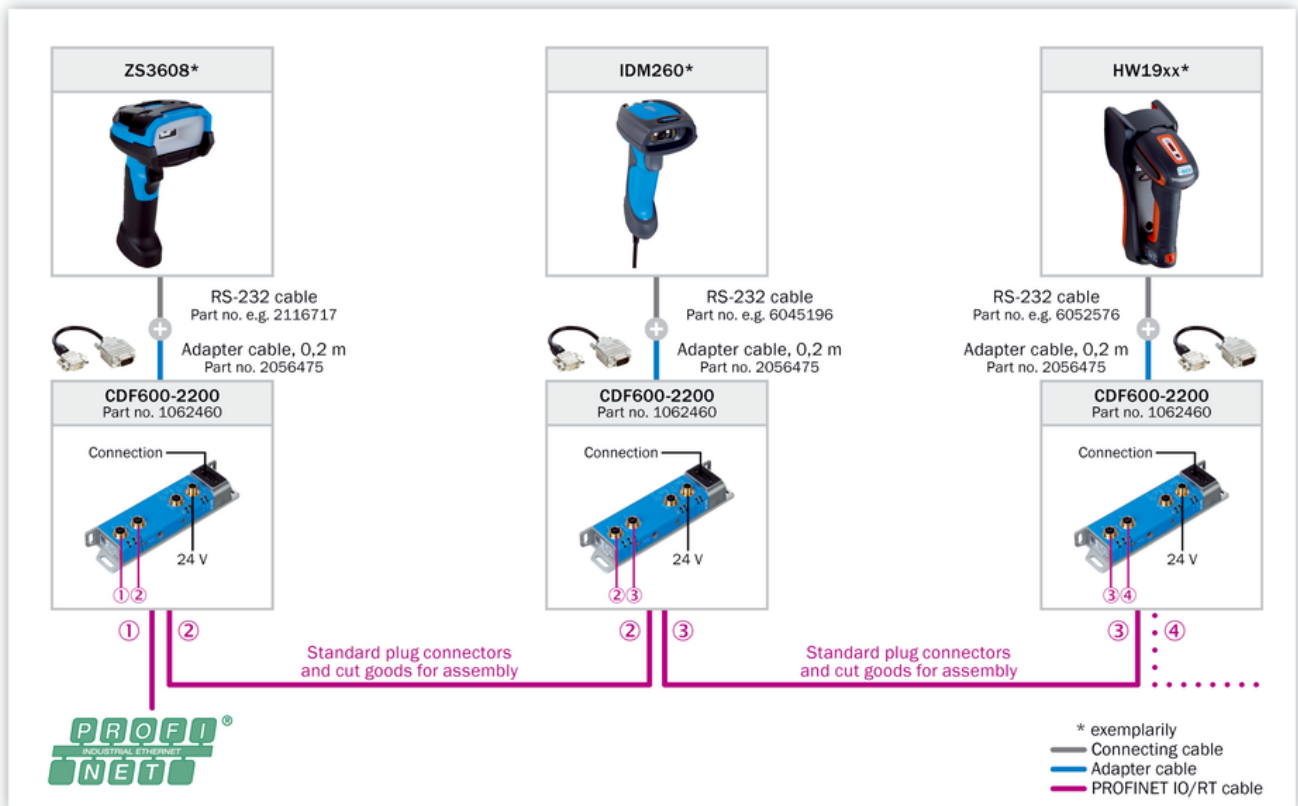

PROFIBUS DP

PROFIBUS DP

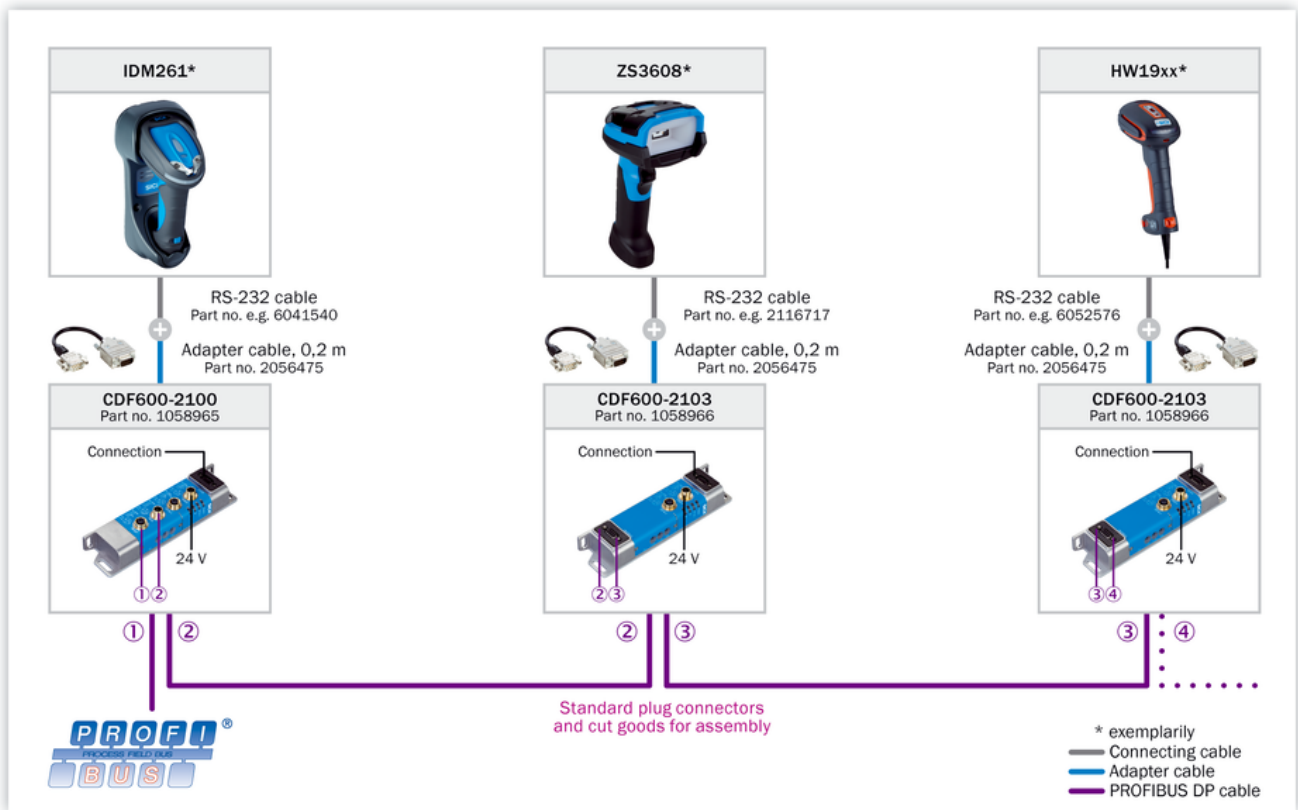

Ethernet TCP/IP

### Ethernet TCP/IP

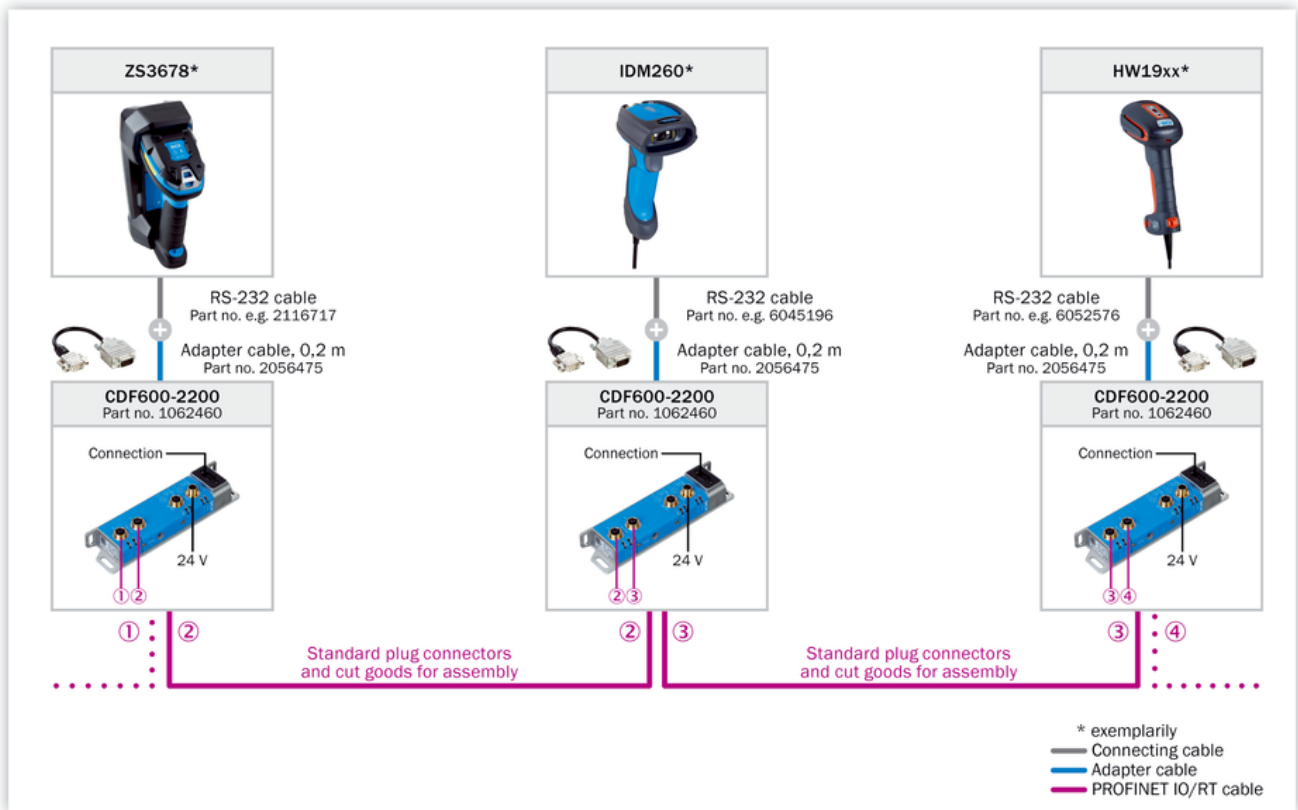

EtherCAT®

EtherCAT®

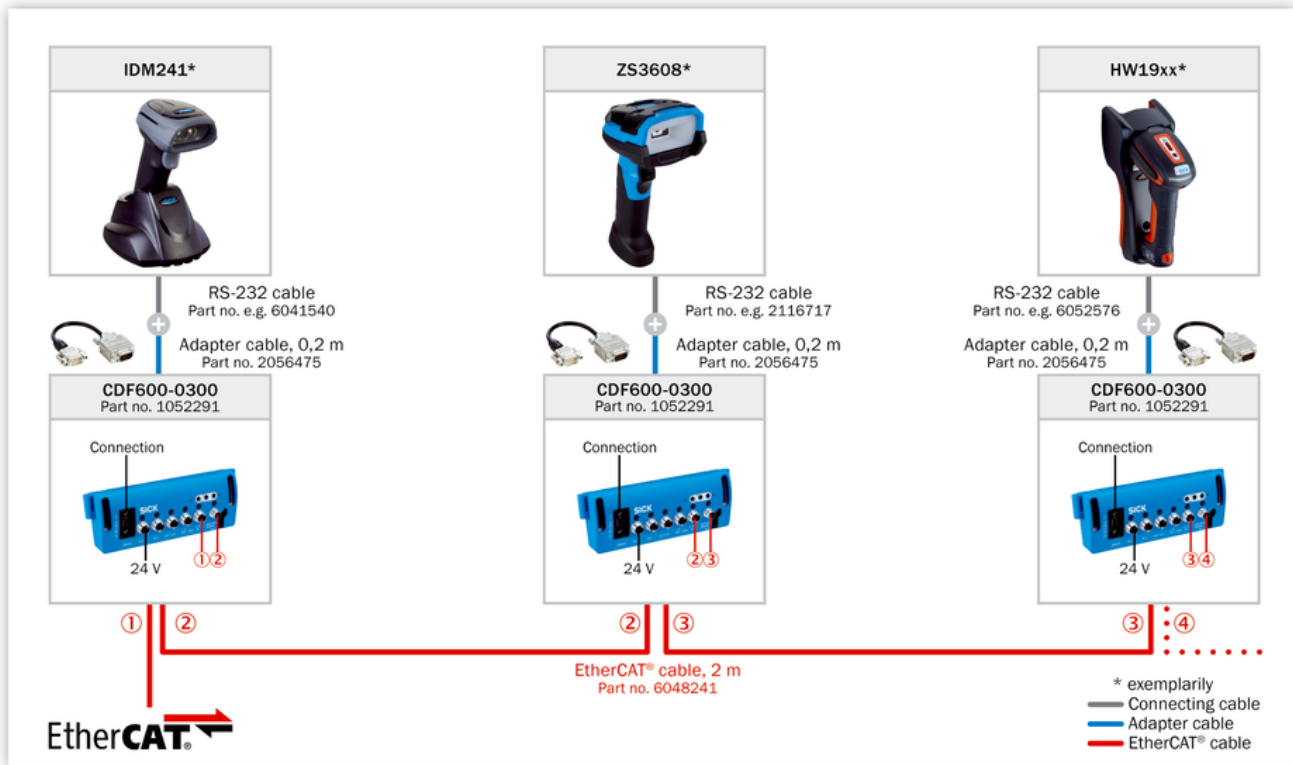

AUX looping

Looping-in via AUX

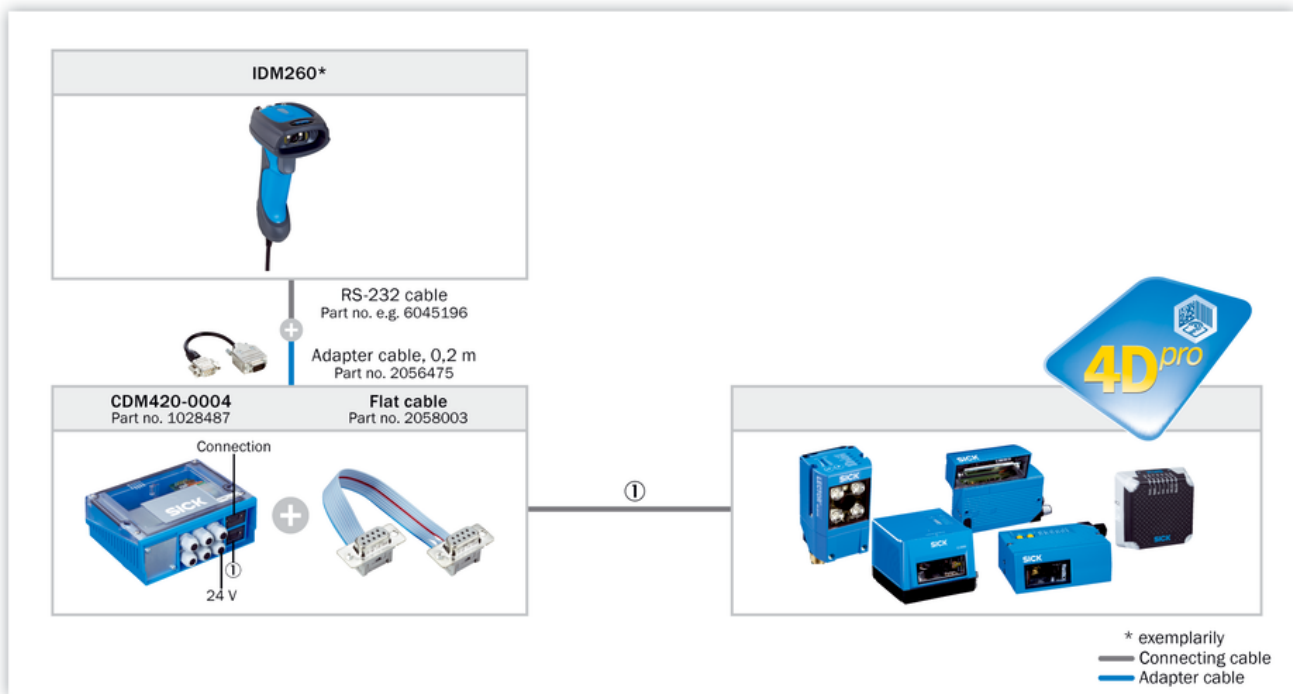

### Selection Guide

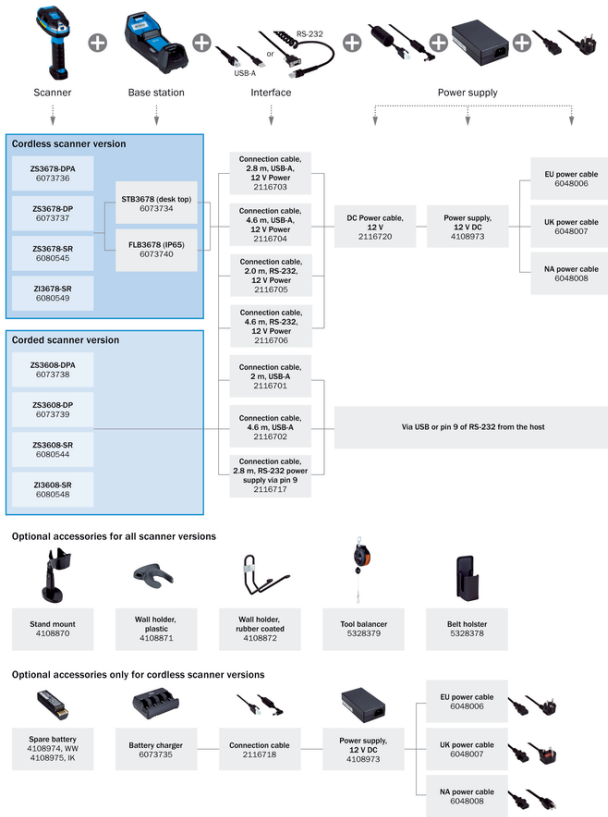









## Recommended accessories

Other models and accessories → [www.sick.com/Zx36](http://www.sick.com/Zx36)

	Brief description	Type	Part no.
<b>Other mounting accessories</b>			
	Wall bracket, grey, plastic (Zebra 11-66553-06R) for ZS36xx	Wall holder	4108871
	Adjustable stand, grey, weighted base plate, plastic (Zebra STND-AS0036-07) for ZS36xx	Stand mount	4108870
<b>Others</b>			
	AC power cable with EU male connector	Power cable	6048006
	DC cable for power supply (#6074455, Zebra PWRBGA12V50W0WW) for use with ZS36xx (Zebra CBL-DC-451A1-01)	Power cable	2116720
	Power supply for ZS36xx, battery charger, EA 3600 module (Zebra PWRB-GA12V50W0WW), requires DC and AC line	Power supply unit	4108973

	Brief description	Type	Part no.
	<ul style="list-style-type: none"> <li>• <b>Connection type head A:</b> Male connector, USB-A</li> <li>• <b>Connection type head B:</b> Male connector, RJ45</li> <li>• <b>Signal type:</b> USB</li> <li>• <b>Cable:</b> 2 m, straightened cable</li> <li>• <b>Description:</b> USB, for keyboard connector or USB Com Port Emulation, 5 V Host Power shielded (Zebra CBA-U46-S07ZAR), USB</li> </ul>	Connection cable (male connector-male connector)	2116701
	<ul style="list-style-type: none"> <li>• <b>Connection type head A:</b> Female connector, D-Sub, 9-pin, straight</li> <li>• <b>Connection type head B:</b> Male connector, RJ45</li> <li>• <b>Signal type:</b> RS-232 TTL</li> <li>• <b>Cable:</b> 2 m, straightened cable</li> <li>• <b>Description:</b> RS-232 TTL, 5 V Host Power, with power socket for 12 V power supply, RS232 TTL, TXT on pin 2 (Zebra CBA-R07-S07PAR), needs power supply/DC and AC line if necessary</li> </ul>	Connection cable (male connector-female connector)	2116705
	<ul style="list-style-type: none"> <li>• <b>Connection type head A:</b> Female connector, D-Sub, 9-pin, straight</li> <li>• <b>Connection type head B:</b> Male connector, RJ45</li> <li>• <b>Signal type:</b> RS-232 TTL</li> <li>• <b>Cable:</b> 2.8 m, coiled cable</li> <li>• <b>Description:</b> RS-232 TTL, Power supply via pin 9, RS232 TTL, (Zebra CBA-R21-S15PAR)</li> </ul>	Connection cable (male connector-female connector)	2116717
	<ul style="list-style-type: none"> <li>• <b>Connection type head A:</b> Male connector, USB-A</li> <li>• <b>Connection type head B:</b> Male connector, RJ45</li> <li>• <b>Signal type:</b> USB</li> <li>• <b>Cable:</b> 2.8 m, straightened cable</li> <li>• <b>Description:</b> USB, for keyboard connector or USB Com Port Emulation, 5 V Host Power, with power socket for 12 V power supply, shielded (Zebra CBA-U42-S07PAR), USB, needs power supply/DC- and AC cable</li> </ul>	Connection cable (male connector-male connector)	2116703

## SICK AT A GLANCE

SICK is one of the leading manufacturers of intelligent sensors and sensor solutions for industrial applications. A unique range of products and services creates the perfect basis for controlling processes securely and efficiently, protecting individuals from accidents and preventing damage to the environment.

We have extensive experience in a wide range of industries and understand their processes and requirements. With intelligent sensors, we can deliver exactly what our customers need. In application centers in Europe, Asia and North America, system solutions are tested and optimized in accordance with customer specifications. All this makes us a reliable supplier and development partner.

Comprehensive services complete our offering: SICK LifeTime Services provide support throughout the machine life cycle and ensure safety and productivity.

For us, that is “Sensor Intelligence.”

## WORLDWIDE PRESENCE:

Contacts and other locations –[www.sick.com](http://www.sick.com)