

Product designation				Enclosed rotary cam switch	
Product type designation				7GN63	
General characteristics					
Switching diagram				55 - Changeover switch without 0 2 poles	
N° of elements				2	
Mounting form				P - Plastic enclosure with black handle	
Contact characteristics					
Rated insulation voltage U_i	IEC/EN	V	690		
	UL/CSA	V	600		
Rated impulse withstand voltage U_{imp}			kV	6	
Conventional free air thermal current I_{th}	IEC/EN	A	63		
	UL/CSA	A	60		
Rated operational voltage			V	480	
Rated operational impulse voltage			kV	4	
Maximum fuse size for short-circuit protection I_n (gG)	10kA	A	63		
	15kA	A	63		
	25kA	A	63		
	50kA	A	63		
	63kA	A	63		
Rated short time current I_{cw}			1s	A	
				1600	
Conductivity				10/5 mA/V	
Operational current I_e IEC/EN	AC1/AC21A		A	63	
	AC15				
		110V	A	32	
		220/230V	A	25	
		380/400V	A	15	
		660/690V	A	4	
Rated operational power in AC	Three-phase AC-3				
			220/230V	kW	11
			380/440V	kW	18.5
			500/690V	kW	18.5
	Single-phase AC-3				
			110V	kW	3.7
			220/230V	kW	6.5
			380/440V	kW	11.5
	Three-phase AC23A				
			220/230V	kW	12.5
			380/440V	kW	30
			500/690V	kW	30
Single-phase AC23A					
		110V	kW	3.7	

		220/230V	kW	7.5
		380/440V	kW	12.5
Rated operational current in DC				
DC21A				
		48V	A	63
		60V	A	50
		110V	A	8
		220V	A	1
DC23A (poles in series)				
		24V	A	50 (1)
		48V	A	50 (2)
		60V	A	50 (3)
		110V	A	25 (3)
		220V	A	15 (4)
DC13				
		24V	A	63
		48V	A	40
		60V	A	28
		110V	A	3.3
Power dissipation			W	3.4
Mechanical features				
Terminals screw				M5
Tightening torque for terminals max			Nm	2
Conductor size				
AWG - Rigid cable				
	min	AWG		14
	Max	AWG		6
AWG - Flexible cable				
	min	AWG		14
	Max	AWG		8
Conductor size (IEC) - Flexible cable				
	min	mm ²		2.5
	Max	mm ²		10
Conductor size (IEC) - Rigid cable				
	min	mm ²		2.5
	Max	mm ²		16
Mechanical life			cycles	5x10 ⁶
UL technical data				
Motor power for direct-on-line control				
for three-phase motor				
	120V	HP		7.5
	240V	HP		15
	480V	HP		25
	600V	HP		25
for single-phase motor				
	120V	HP		3
	240V	HP		10
Ambient conditions				
Temperature				
Operating temperature				
	min	°C		-25
	max	°C		+55
Storage temperature				
	min	°C		-40

max °C +70

Resistance & Protection

Frontal IP degree	IP65
Terminals IP degree	IP00

Dimensions

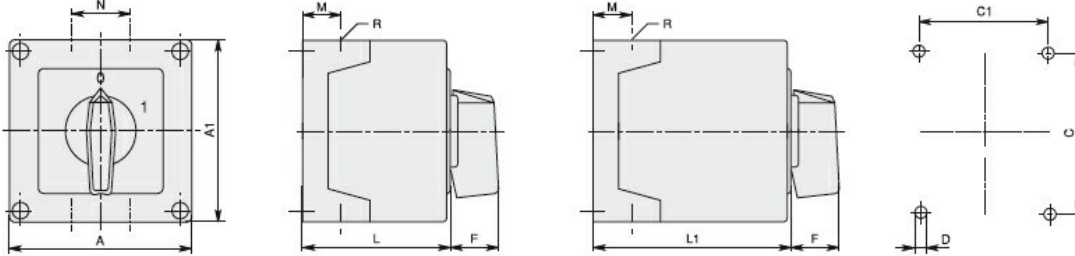

Series	Enclosure size	Number of elements		Dimensions										Cable entry	Protection degree
		L	L1	A	A1	C	C1	D	F	M	N	L	L1		
7GN12	75x75	1-2	3-4	75	75	50	64	4.5	19	14	28	57.5	79.8	4xPG13.5	IP65
7GN20		1-2	3-4												
7GN25		1	2-3												
7GN12	90x90	1-3	4-6	90	90	79	63	4.5	25	19	30	71.3	98.3	4xPG16	IP65
7GN20		1-3	4-6												
7GN25		1-2	3-4												
7GN32		1-2	3-4												
7GN40		1	2-3												
7GN12	110x110	1-4	5-8	110	110	98.4	83	4.5	32	21	39.5	85.5	119.5	4xPG21	IP65
7GN20		1-4	5-8												
7GN25		1-3	4-5												
7GN32		1-3	4-5												
7GN40		1-2	3-5												
7GN63		1-2	3-4												
7GN32	125x175	1-3	4-5	125	175	146	112	5.5	32	21	68	84.3	118.3	4xPG21 2xPG11	IP65
7GN40		1-2	3-4												
7GN63		1-2	3-4												
7GN125		1	2												
7GN32	180x254	1-5	6-8	180	254	120	190	5.5	32	35	76	121	175	4xPG29 2xPG11	IP65
7GN40		1-4	5-7												
7GN63		1-3	4-6												
7GN125		1-2	3-4												

Wiring diagrams

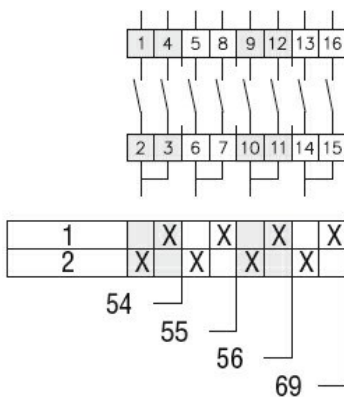

Certifications and compliance

Compliance

IEC/EN/BS 60947-1
IEC/EN/BS 60947-3
IEC/EN/BS 60947-5-1

Certificates

EAC

ETIM classification

ENCLOSED ROTARY CAM SWITCH 7GN SERIES, CHANGEOVER SWITCH WITHOUT 0, 2
POLES 63A IN PLASTIC ENCLOSURE 125X175MM WITH BLACK HANDLE

ETIM 8.0

EC001029 -
Selector switch,
complete