

Part number

CRF D



Coding pin, for standard inserts, female, in zinc plated iron

Product description

Product type	Coding pin
Specification	For standard inserts Female, in zinc plated iron

Further technical details

Weight	2,70 g
---------------	--------

General ordering information

EAN13 code	8015747038539
eCl@ss 8.1	27440203
ETIM 7.0	EC002311

Packaging Information

Packaging length	112,00 mm
Packaging height	95,00 mm
Packaging width	117,00 mm
Packaging weight	1,27 kg
Packaging volume	1,24 dm ³
Packaging description	Carton box
Packaging quantity	400 Pcs
Packaging EAN code	8015747206754
Sub-packaging length	50,00 mm
Sub-packaging height	44,00 mm
Sub-packaging width	50,00 mm
Sub-packaging weight	0,16 kg
Sub-packaging volume	0,11 dm ³
Sub-packaging description	Plastic box
Sub-packaging quantity	50 Pcs
Sub-packaging EAN barcode	8015747038546

Part number

CRF D



Catalogue drawings

CRM / CRM D

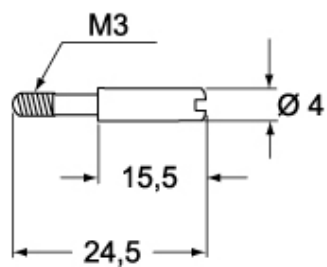

CRF /CRF D

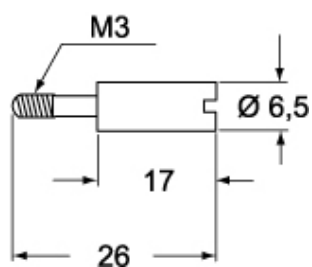

Notes

Dimensions shown in mm are not binding and may be changed without notice.
