

# Installation Guide

## Smart-UPS SCL500RM1UC

### with Lithium-ion Battery and APC<sup>TM</sup> SmartConnect

### Inventory

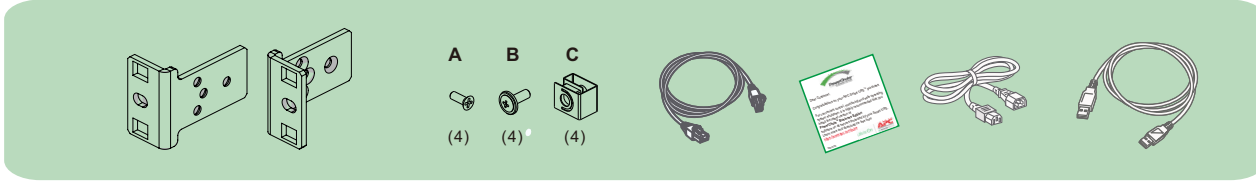

### UPS Installation

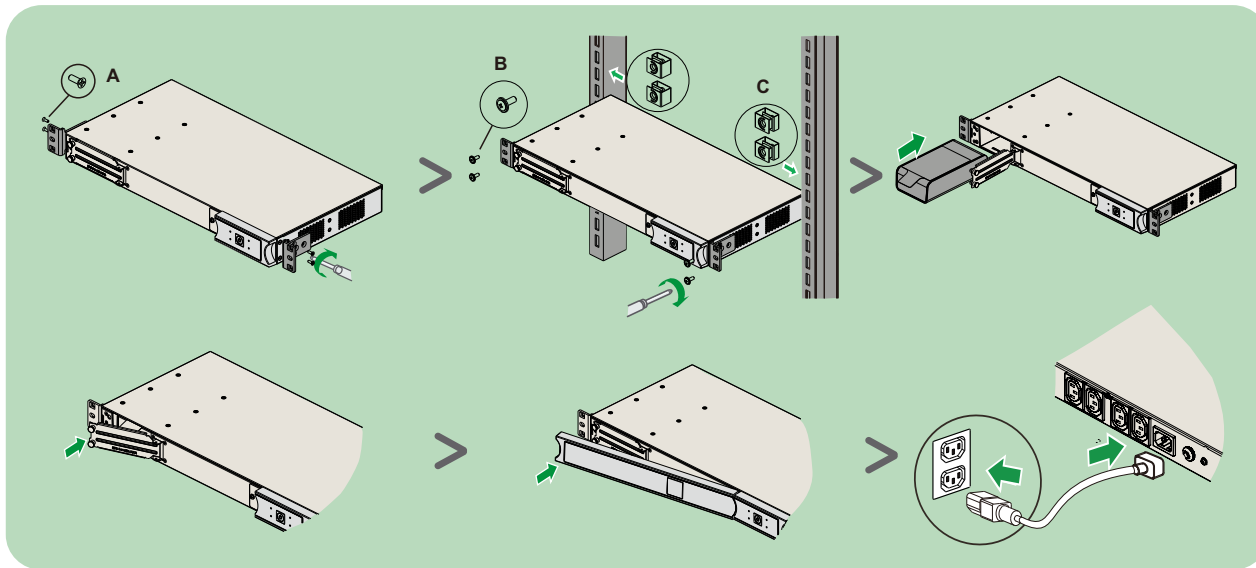

### APC<sup>TM</sup> SmartConnect Installation

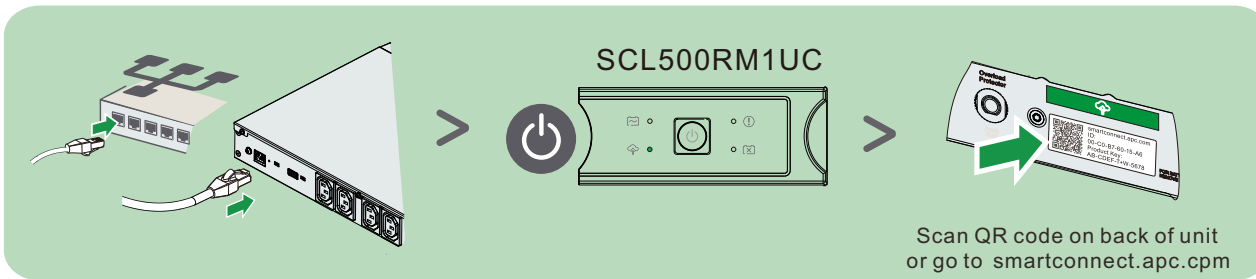

Scan QR code on back of unit or go to [smartconnect.apc.com](http://smartconnect.apc.com)

Operation Manual  
Manuel d'utilisation  
Manual de operaciones

<https://d.go2se.com/scl500rmi1uc>

### Display Interface

SCL500RM1UC

- 1 On battery / online indicator
- 2 SmartConnect status indicator
- 3 Event and Error detected indicator
- 4 Replace battery indicator

**SmartConnect.apc.com**

- Firmware update notifications
- Power event notifications
- Advanced support