

Installation guide

Solenoid valve

Type EV227B

032R9277

032R9277

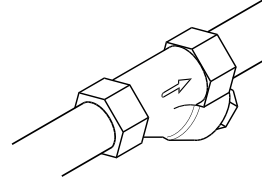
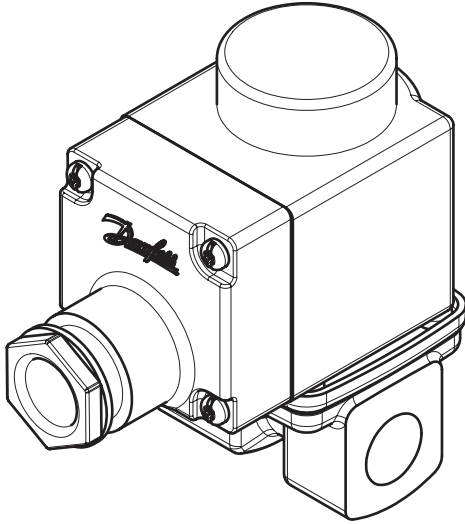

≥ 297 Microns

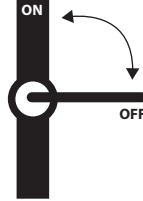

1

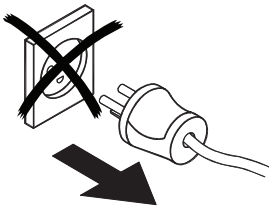

2

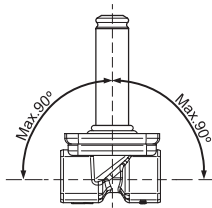

3

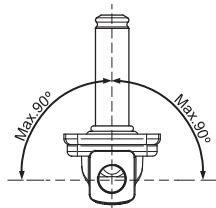

4

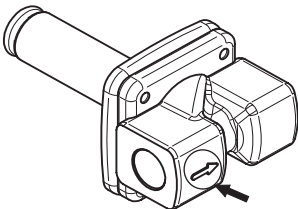

5

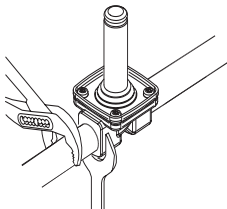

6

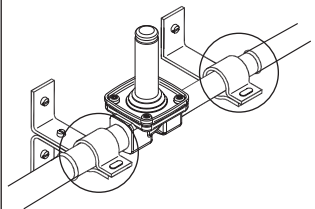

7

8

9

10

11

12

13

Max. PT

Bar

| DN | Max. Working Pressure (MWP) | Max. Test pressure (PT) |
|--------------|-----------------------------|-------------------------|
| | [bar] | [bar] |
| 10 - 22 | 10 | 16 |
| EN 60730-2-8 | | |

Visit www.products.danfoss.com for further technical data.
 Para más información, visite www.products.danfoss.es
 Rendez-vous sur le site www.products.danfoss.fr pour plus de données techniques.