

SHPOUTV224

Instruction Manual

CARLO GAVAZZI

ENGLISH



Write here the location



• SUPPLY SPECIFICATIONS

Operational voltage range 15 - 28 VDC. **Max ripple** 1 V. **Reverse polarity protection** Yes. **Overvoltage category** Overvoltage cat. II (IEC 60664-1, par. 4.3.3.2). **Rated impulse voltage** 500 V (1.2/50 μ s) (IEC 60664-1, tab. F.1). **Typ. current consumption** 15 mA (only internal). **Max. output current** 100 mA (not self-limited). **Power on delay** \leq 2 s. **Power off delay** \leq 1 s.

• SPECIFICATIONS FOR ANALOG OUTPUTS

Output 1 and 2

Output type 2 x 0-10 VDC. **Inaccuracy** $<$ 0.5% fs (over entire temp. range). **Cable length** $<$ 5 m. **Load, each channel** max 1.5 mA

• DUPLINE® SPECIFICATIONS

Voltage 8.2 V. **Maximum Dupline® voltage** 10 V. **Minimum Dupline® voltage** 5.5 V. **Maximum Dupline® current** 1.5 mA.

• GENERAL SPECIFICATIONS

Environment. **Pollution degree** 2 (IEC 60664-1, par. 4.6.2). **Operating temperature** 0 to +50°C (-4 to +122°F). **Storage temperature** -50 to +85°C (-58 to +185°F). **Humidity** (non-condensing) 20 - 90%. **Housing.** **Material** Macromel. **Colour** Ambra. **Dimensions** (h x w x d) 50 x 30 x 18 mm. **Weight** 50 g. **Protection degree** IP20. **Terminal block.** **Power supply input** 4 x spring terminal. **Dupline® bus** 4 x spring terminal. **Cross-sectional area** Terminal: 1.5 mm². **Cable x 4.** 5 (GND). 6 Out 2. 7 GND. 8 Out 1. **Wire cross section** 0.14 mm². **Wire length** 0.25 m. **EMC.** **Immunity** EN61000-6-2. **Electrostatic discharge** EN61000-4-2. **Radiated radiofrequency** EN61000-4-3. **Burst immunity** EN61000-4-4. **Surge** EN61000-4-5. **Conducted radiofrequency** EN61000-4-6. **Power frequency magnetic fields** EN61000-4-8. **Voltage dips, variations, interruptions** EN61000-4-11. **Emission.** **Conducted and radiated emissions** CISPR 22 (EN55022), cl.B. **Conducted emissions** CISPR 16-2-1 (EN55016-2-1). **Radiated emissions** CISPR 16-2-3 (EN55016-2-3). **Approvals** CE, cULus according to UL60950

MANUAL SHPOUTV224
code 15-029-526 / 230113
<http://www.carlogavazzi.com/>
 CARLO GAVAZZI

Approvals: CE, cULus according to UL60950.

UL notes: Max ambient temperature: 40°C.

• WIRING DIAGRAM

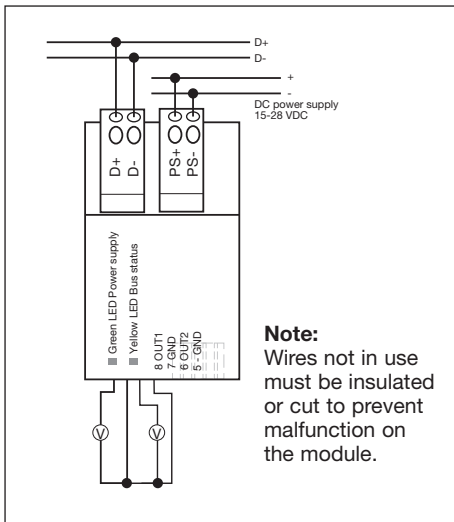

• DIMENSIONS

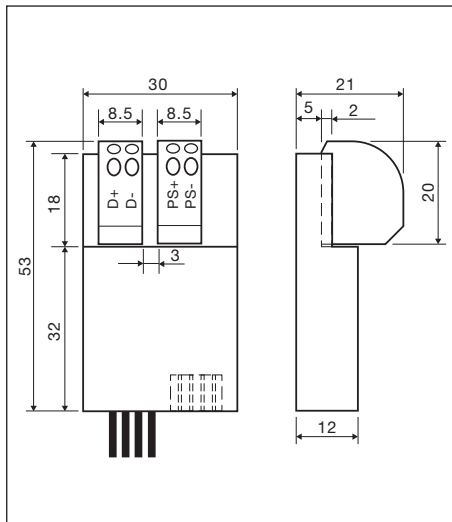

Read carefully the instruction manual. If the instrument is used in a manner not specified by the producer, the protection provided by the instrument may be impaired. **Maintenance:** make sure that the connections are correctly carried out in order to avoid any malfunctioning or damage to the instrument. To keep the instrument clean, use a slightly damp cloth; do not use any abrasives or solvents. We recommend to disconnect the instrument before cleaning it. **WARNING:** join or divide the modules ONLY when they're NOT power supplied.

• MODE OF OPERATION

The SHPOUTV224 is fully programmable via the SH tool. Each analog output can be individually associated to one or more functions supported by the smart-house system.

SHPOUTV224 connected to the SH2WEB24. Coding/Addressing:

If the analog output module is connected to the SH2WEB24 controller, no addressing is needed since the module is provided with a specific identification number (SIN); the user has only to insert the SIN number in the SH tool when creating the system configuration.

• GENERAL SPECIFICATIONS

Address assignments/channel programming

If it is used with the SH2WEB24 the address assignment is automatic: the controller recognises the module through the SIN (Specific Identification Number) that has to be inserted in the SH tool.

MANUAL SHPOUTV224
code 15-029-526 / 230113
<http://www.carlogavazzi.com/>
CARLO GAVAZZI