

BP TRCC M6x12 HE

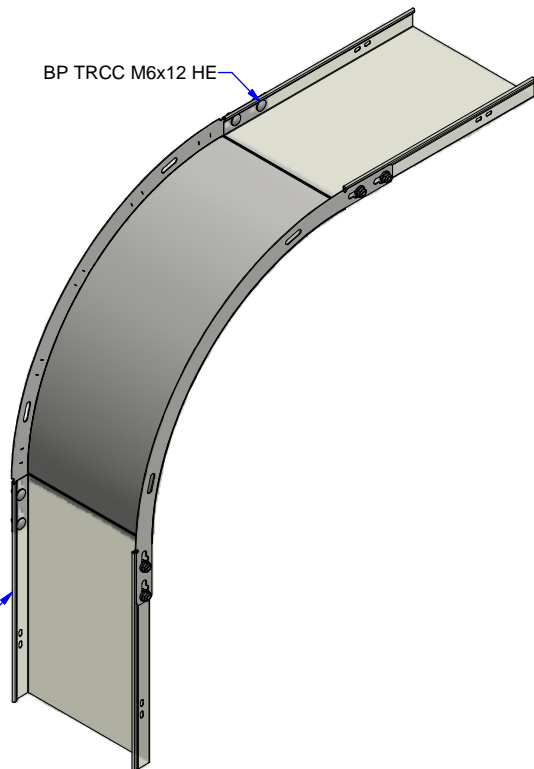

Goulotte GBRs
(GBRS Trunking)

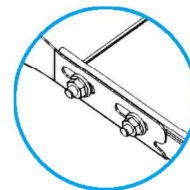
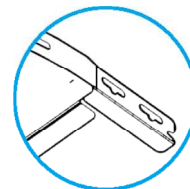

Description	Code	Masse/Weight Kg/p	Ep./Th. mm	H mm	l./w. mm
CV GBRs 24x50 GC	519535	0,616	1,00	24,00	54
CV GBRs 24x75 GC	519540	0,715	1,00	24,00	78
CV GBRs 24x100 GC	519545	0,825	1,00	24,00	102
CV GBRs 24x147 GC	519555	1,025	1,00	24,00	150
CV GBRs 24x195 GC	519565	1,221	1,00	24,00	198

HDG : Hot dip galvanised according to ISO 1461.

GC : Tôle d'acier galvanisé à chaud après fabrication suivant NF EN ISO 1461



www.niedaxfrance.fr

CONVEXE GBRs H24 GC
GBRS OUTSIDE BEND H24 HDG



ASSISTANCE TECHNIQUE
+33 (0)1 55 95 92 17
pole.technique@niedax.fr

NIEDAX
France

FT02728

