

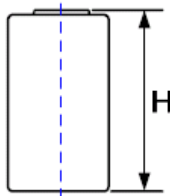

**CARACTERISTIQUES ELECTRIQUES
ELECTRICAL CHARACTERISTICS**

Type		Rechargeable Nickel Metal Hydride
IEC Designation		SC
Plot / Top		Flat top
Tension nominale / Nominal voltage		1.2V
Tension mini en décharge / Mini discharge voltage		1V
Charge standard 16h		220 mA
Capacité nominale / Nominal Capacity		2100 mAh
Capacité mini / Minimal Capacity		2000 mAh
Cycle life at 80% DOD (0,5C)		> 500 (IEC standard)
Resistance Interne / Internal Impedance (at 1000hz)		< 10 mΩ
Température d'usage / Ambient temperature	Charge / Charging	0 to 45°C
	Décharge / Discharging	-10 to 50°C
Temperature de stockage / Storage temperature		-20 to 30°C (Humidity: 65 ± 20%)
Charge rapide / Fast charge		2200mA - ΔV=0-5mV/Cell
Charge de maintient / Trickle charge		(0.05C)~(0.1C)

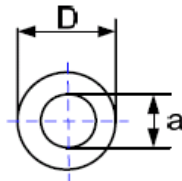

**CARACTERISTIQUES PHYSIQUES
PHYSICAL CHARACTERISTICS**

Accumulateur / Battery	
Dimension (mm)	23 x 33.5 (+/- 1)
Poids / Weight (g.)	40

