



BLUETOOTH® WIRELESS
DALI CONTROLLER FOR
OUTDOOR AND INDUSTRY



BLUETOOTH® WIRELESS DALI CONTROLLER FOR OUTDOOR AND INDUSTRY

Blu2Light - The intelligent wireless lighting control solution

Blu2Light is the first completely open Bluetooth® wireless technology system with mesh functionality for the professional lighting market, which, in addition to a variety of functions for lighting control, offers the luminaire manufacturer added IoT benefits with maximum system security.

Blu2Light Connect T-ME

The power is supplied via DALI.



Blu2Light Connect T-ME

- **ENABLES THE INTEGRATION OF THE BLU2LIGHT NETWORK IN STREET, BOLLARD AND INDUSTRY LIGHTING**
- **INTEGRATED BLUETOOTH® MESH RADIO MODULE**
- **MAINTENANCE-FREE**
- **OPERATING LIFETIME: 50,000 HRS.**
- **PRODUCT GUARANTEE: 5 YEARS**
- **IP67 PROTECTED CASING**



Blu2Light Connect T-ME

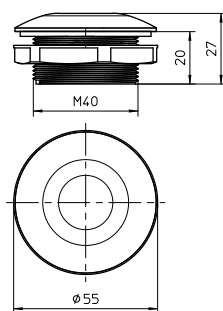

Type	Connect T-ME
Ref. No.	187295
Communication	Blu2Light Mesh Network
Frequency range	2402–2480 MHz
HF output power	< 10 mW EIRP
Power consumption standby/operation	< 0.24 W
Power supply	DALI power supply
IP protection	IP65
Protection class	II
Dimensions (Ø x H)	50x50x27mm
Casing	Makrolon, grey RAL 7023
Weight	50g

Product guarantee

- 5 years
- The conditions for the Product Guarantee of the Vossloh-Schwabe Group shall apply as published on our homepage (www.vossloh-schwabe.com). We will be happy to send you these conditions upon request.



The values in this data sheet may change due to technical innovations and are subject to change without notice.

Blu2Light Connect T-ME

General Safety and Mounting Instructions

- Only qualified persons are allowed to install Blu2Light products.
- Prior to installing and commissioning the system, read these instructions carefully. Only this will guarantee correct and safe handling. Please keep these instructions as you may need them later.
- The devices must always be disconnected before any work is carried out on them.
- The applicable safety and accident prevention regulations must be observed.
- Opening by unqualified personnel of the products is prohibited:
Risk of death from electric shock!
The devices must only be repaired by the manufacturer.
- Only DALI power supply may be connected.
- Overvoltage protection of the DALI interface: Connecting higher voltages than DALI voltage will destroy the products. Operation with 24 V / 110 V / 230 V is generally not permitted!
- The Blu2Light Outdoor control units are designed to control street and bollard lights.

Mounting

- A DALI power supply must be present on the input side.
- tbd

Setup and operation

- The Blu2Light devices are configured with the LiNA Connect app and can be operated via the LiNA Touch app.
- For the exact procedure for the configuration of the devices please refer to the instructions in the LiNA Connect app or in the corresponding documentation.
- A tablet is required for setup, both tablets and smartphones can be used for operation. Both are not included in the scope of delivery.
- For information on the iOS and Android operating systems that can currently be used, refer to the LiNA Connect/ LiNA Touch manual:



Bluetooth® wireless technology

The Bluetooth® word mark and logos are registered trademarks owned by the Bluetooth SIG, Inc. and any use of such marks by Vossloh-Schwabe is under license. Other trademarks and trade names are those of their respective owners.

Important note:

- Please refer to the installation instructions included with the product and the applicable Blu2Light system data sheet before installation. Make sure that the Bluetooth radio signal can propagate freely according to the specifications.
- All Blu2Light devices (ME, XS, XL, XXL, ...) that are supplied via DALI may only be connected to one DALI power supply! Therefore, it is not permissible to connect several Blu2Light devices to one power supply. In this case, malfunctions will occur.



We, Vossloh-Schwabe Deutschland GmbH, herewith confirm that these devices comply with the basic requirements of the directive 2014/53 / EU and other relevant directives. The entire text of the declaration of conformity can be obtained from the following address: www.vossloh-schwabe.com

The values in this data sheet may change due to technical innovations and are subject to change without notice.