

2

1

THIS COPY IS PROVIDED ON A RESTRICTED BASIS AND IS NOT TO BE USED IN ANY WAY DETRIMENTAL TO THE INTERESTS OF PANDUIT CORP.

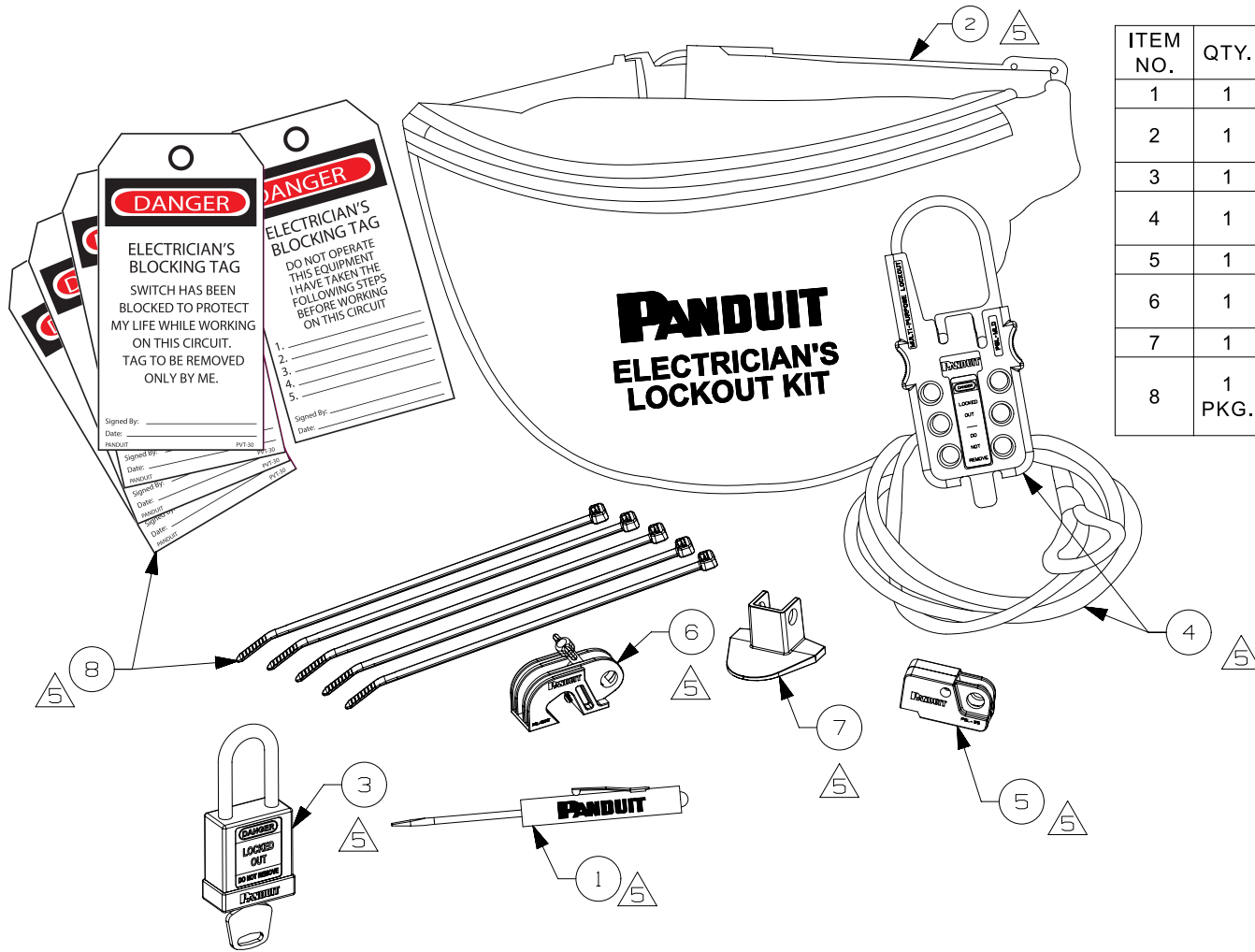

ITEM NO.	QTY.	PART NO.	DESCRIPTION
1	1	GMSDCOM	PANDUIT SCREWDRIVER
2	1	PSL-PK	LOCKOUT POUCH (EMPTY) FOR PSL-PK-E (FANNY PACK)
3	1	PSL-8	PLASTIC BODY PADLOCK, RED
4	1	PSL-MLD	MULTIPLE LOCKOUT DEVICE WITH CABLE
5	1	PSL-WS	WALL SWITCH LOCKOUT DEVICE
6	1	PSL-CBNT	NO-TOOL CIRCUIT BREAKER LOCKOUT UNIVERSAL STYLE
7	1	PSL-P	PLUG LOCKOUT DEVICE
8	1 PKG.	PVT-30	Plastic Tag, "DANGER ELECTRICIAN'S BLOCKING TAG", 5 tags & ties/pk, RB/WH

REV	DATE	BY	CHK	APR	DESCRIPTION	ECN
5	4/3/18	RVU	DJW	JHAC	UPDATE ALL ISO VIEWS W/ PSL-MLD, PSL-WS, PSL-P, AND TAGS. CHANGE HANDLE FOR PSL-CBNT. REMOVE ALL INSTRUCTION SHEETS.	GAECN04134
4	8/13/14	RVU	MJPF	MSAD	CHANGE OLD PANDUIT LOGO TO CURRENT PANDUIT LOGO.	GAECN02239
3	11/17/09	RVU			PSL-8 WAS PSL-3RED-LS. ADD ITEMS NO. 10 AND 11 FOR INST. SHEET. UPDATE ON PADLOCK.	5905
2	12/10/07	RVU			PSL-3RED-LS WAS PSL-5RED-LS.	5230
1	10/9/06	RVU			ELECTRICIAN'S WAS ELECTRICIAN'S.	4717
0	9/13/06	RVU			DRAWING RELEASE.	4659

TITLE		PSL-PK-EA ELECTRICIAN LOCKOUT KIT CUSTOMER DRAWING	
ITEM REVISION NAME		100619DF/08	
DATASET FILE NAME		100619DF_DC_C10443/08F	
UNLESS OTHERWISE SPECIFIED, DIMENSIONAL TOLERANCES ARE: IN (mm)		MATERIAL: NONE	
DRAWING NUMBER: C10443		DRAWING NUMBER: C10443	
DRAWN BY	DATE	CHK	SCALE
RVU	8/15/06	MSAD	NTS
SHT 1 OF 1		SIZE A	

2

1