

|   |          |    |      |  |
|---|----------|----|------|--|
| Product designation                                       |          |    |      | Rotary cam switches  |
| Product type designation                                  |          |    |      | GX40   |
| <b>General characteristics</b>                            |          |    |      |  |
| Switching diagram   |          |    |      | 66 - Voltmeter switch for phase-neutral and phase-phase voltages |
| N° of elements  |          |    |      | 3  |
| Mounting form   |          |    |      | U - Front mounting with black handle                             |
| <b>Contact characteristics</b>                            |          |    |      |  |
| Rated insulation voltage $U_i$                            | IEC/EN   | V  | 690  |  |
|   | UL/CSA   | V  | 600  |  |
| Rated impulse withstand voltage $U_{imp}$                 |          | kV | 6    |  |
| Conventional free air thermal current $I_{th}$            | IEC/EN   | A  | 40   |  |
|   | UL/CSA   | A  | 40   |  |
| Rated operational voltage                                 |          | V  | 440  |  |
| Rated operational impulse voltage                         |          | kV | 4    |  |
| Maximum fuse size for short-circuit protection $I_n$ (gG) | 10kA     | A  | 40   |  |
|   | 15kA     | A  | 35   |  |
|   | 25kA     | A  | 35   |  |
| Rated short time current $I_{cw}$                         | 1s       | A  | 1000 |  |
| Conductivity  |          |    |      | 10/5 mA/V  |
| Operational current $I_e$ IEC/EN                          |          |    |      |  |
| AC1/AC21A   |          | A  | 40   |  |
| AC15  | 110V     | A  | 25   |  |
|   | 220/230V | A  | 22   |  |
|   | 380/400V | A  | 12   |  |
|   | 660/690V | A  | 2    |  |
| Rated operational power in AC                             |          |    |      |  |
| Three-phase AC-3  | 220/230V | kW | 7.5  |  |
|   | 380/440V | kW | 15   |  |
|   | 500/690V | kW | 15   |  |
| Single-phase AC-3   | 110V     | kW | 2.2  |  |
|   | 220/230V | kW | 4.4  |  |
|   | 380/440V | kW | 7    |  |
| Three-phase AC23A   | 220/230V | kW | 9    |  |
|   | 380/440V | kW | 18.5 |  |
|   | 500/690V | kW | 15   |  |
| Single-phase AC23A  | 110V     | kW | 3    |  |

|   |          |                 |                   |
|---|----------|-----------------|-------------------|
|   | 220/230V | kW              | 5.2               |
|   | 380/440V | kW              | 7.5               |
| <b>Rated operational current in DC</b>        |          |                 |                   |
| DC21A   |          |                 |                   |
|   | 48V      | A               | 40                |
|   | 60V      | A               | 40                |
|   | 110V     | A               | 6                 |
|   | 220V     | A               | 0.8               |
|   | 440V     | A               | 0.25              |
| DC23A (poles in series)                       |          |                 |                   |
|   | 24V      | A               | 40 (1)            |
|   | 48V      | A               | 40 (1)            |
|   | 60V      | A               | 40 (3)            |
|   | 110V     | A               | 40 (3)            |
|   | 220V     | A               | 12 (4)            |
| DC13  |          |                 |                   |
|   | 24V      | A               | 40                |
|   | 48V      | A               | 32                |
|   | 60V      | A               | 16                |
|   | 110V     | A               | 3                 |
|   | 220V     | A               | 0.5               |
|   | 440V     | A               | 0.15              |
| <b>Power dissipation</b>                      |          | W               | 1.6               |
| <b>Mechanical features</b>                    |          |                 |                   |
| <b>Terminals screw</b>                        |          |                 | M4                |
| <b>Tightening torque for terminals max</b>    |          | Nm              | 1.2               |
| <b>Conductor size</b>                         |          |                 |                   |
| AWG - Rigid cable                             |          |                 |                   |
|   | min      | AWG             | 16                |
|   | Max      | AWG             | 8                 |
| AWG - Flexible cable                          |          |                 |                   |
|   | min      | AWG             | 16                |
|   | Max      | AWG             | 10                |
| Conductor size (IEC) - Flexible cable         |          |                 |                   |
|   | min      | mm <sup>2</sup> | 1.5               |
|   | Max      | mm <sup>2</sup> | 6                 |
| Conductor size (IEC) - Rigid cable            |          |                 |                   |
|   | min      | mm <sup>2</sup> | 1.5               |
|   | Max      | mm <sup>2</sup> | 10                |
| <b>Mechanical life</b>                        |          | cycles          | 1X10 <sup>6</sup> |
| <b>UL technical data</b>                      |          |                 |                   |
| <b>Motor power for direct-on-line control</b> |          |                 |                   |
| for three-phase motor                         |          |                 |                   |
|   | 120V     | HP              | 5                 |
|   | 240V     | HP              | 10                |
|   | 480V     | HP              | 15                |
|   | 600V     | HP              | 15                |
| for single-phase motor                        |          |                 |                   |
|   | 120V     | HP              | 2                 |
|   | 240V     | HP              | 5                 |
| <b>Ambient conditions</b>                     |          |                 |                   |
| <b>Temperature</b>                            |          |                 |                   |
| Operating temperature                         |          |                 |                   |
|   | min      | °C              | -25               |

|                     |     |    |     |
|---------------------|-----|----|-----|
| Storage temperature | max | °C | +55 |
|                     | min | °C | -40 |
|                     | max | °C | +70 |

**Resistance & Protection**

|                     |      |
|---------------------|------|
| Frontal IP degree   | IP65 |
| Terminals IP degree | IP20 |

**Dimensions**

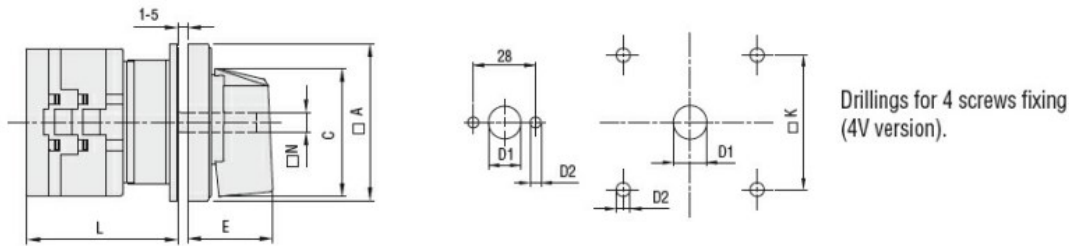

| Series | Dimensions |      |     |     |      |    |    | L Number of elements |      |    |      |    |      |     |       |     |       |     |       |
|--------|------------|------|-----|-----|------|----|----|----------------------|------|----|------|----|------|-----|-------|-----|-------|-----|-------|
|        | □A         | C    | ØD1 | ØD2 | E    | □K | □N | 1                    | 2    | 3  | 4    | 5  | 6    | 7   | 8     | 9   | 10    | 11  | 12    |
| GX16   | 48         | 39.5 | 12  | 5   | 26.5 | 36 | 6  | 43                   | 51.5 | 60 | 68.5 | 77 | 85.5 | 94  | 102.5 | 111 | 119.5 | 128 | 136.5 |
| GX20   | 48         | 39.5 | 12  | 5   | 26.5 | 36 | 6  | 43                   | 51.5 | 60 | 68.5 | 77 | 85.5 | 94  | 102.5 | 111 | 119.5 | 128 | 136.5 |
| GX32   | 65         | 53   | 14  | 5   | 34.5 | 48 | 7  | 51                   | 63   | 75 | 85   | 99 | 111  | 123 | 135   | 147 | 159   | 171 | 183   |
| GX40   | 65         | 53   | 14  | 5   | 34.5 | 48 | 7  | 51                   | 63   | 75 | 85   | 99 | 111  | 123 | 135   | 147 | 159   | 171 | 183   |

**Wiring diagrams**

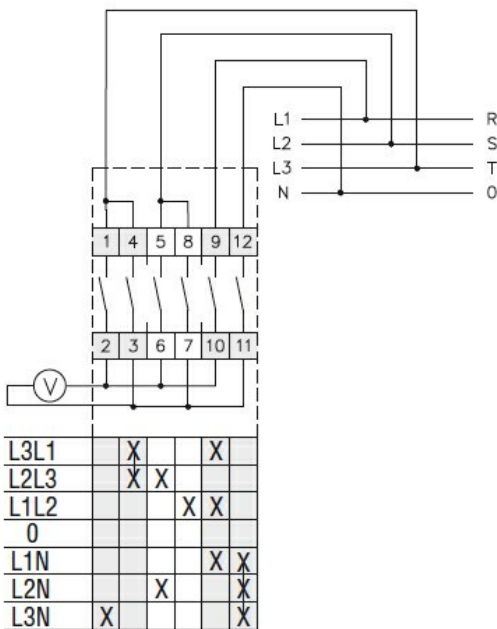

**Certifications and compliance**

**Compliance**

|                     |
|---------------------|
| CSA C22.2 n° 14     |
| IEC/EN/BS 60947-1   |
| IEC/EN/BS 60947-3   |
| IEC/EN/BS 60947-5-1 |
| IEC/EN/BS 61058-1   |
| UL60947-4-1         |

**Certificates**

cULus

---

EAC

ETIM classification

ETIM 8.0

EC001029 -  
Selector switch,  
complete