

INSTRUCTIONS CM656B

© Panduit Corp. 2013, 2014

Equipment Rail Installation

- Install [4] Equipment Rail Mounting Brackets to Equipment Rails with [3] Counter-sunk Torx screws per bracket (use T25 Torx bit)
- Ensure that counter-sinks of brackets are oriented to match heads of counter-sunk screws

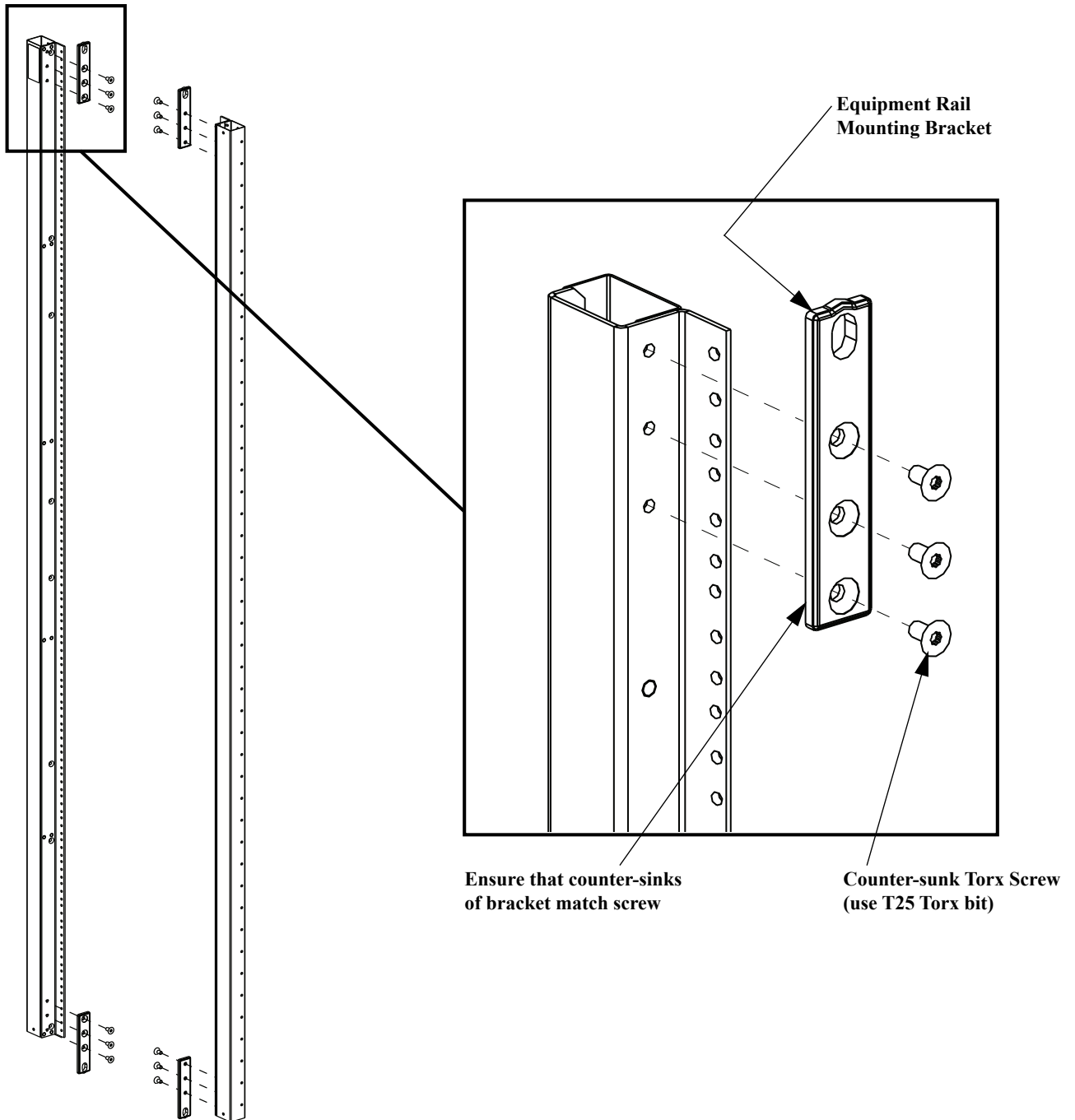

Equipment Rail Installation

- Locate desired Equipment Rail position
- Insert [2] Equipment Rail Mount Nuts through slots of Front-to-Back Beam (top and bottom locations)
- Fasten [2] M10 Hex Screws to E-Rail Mount Nuts at top and bottom of Equipment Rail
- Tighten M10 Hex Head Screw to 30.0 +/- 5.0 N-m [22.1 +/- 3.7 Ft-lbs]

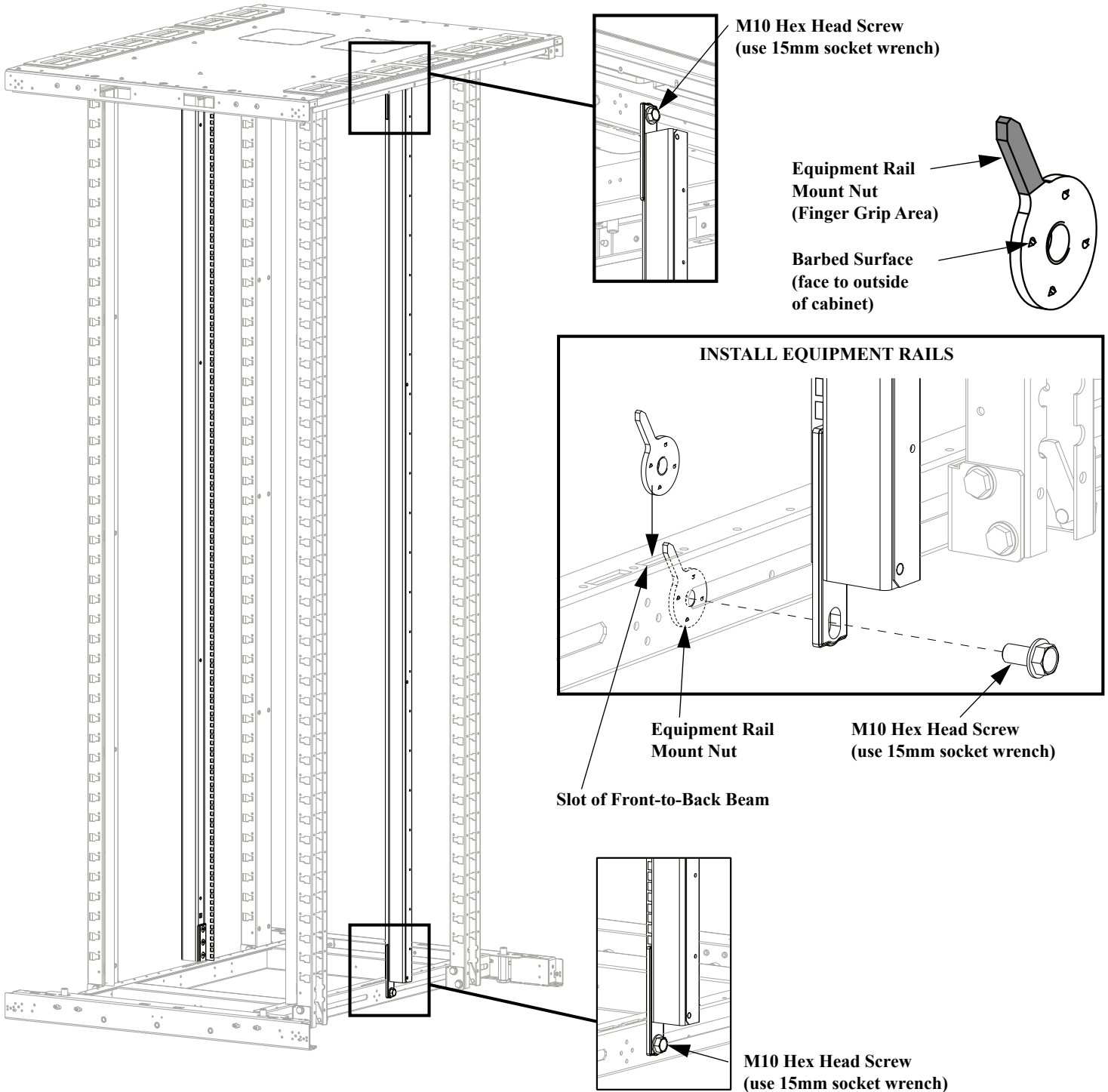

For Instructions in Local Languages
and Technical Support:

www.panduit.com/resources/install_maintain.asp

PANDUIT
www.panduit.com

E-mail:
techsupport@panduit.com
Phone:
866-405-6654