

DOWNLIGHT TUTTI

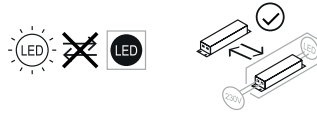

Classe II avec son alimentation
Safety class II connected with the driver



Caractéristiques techniques / Características técnicas / Características técnicas / Caratteristiche tecniche

Modèle-Référence / Modelo-Referencia / Modello-Riferimento / Modelo-Referência	BL000054 / 55
Tension nominale / Tensión nominal / Tensione nominale / Tensão nominal	30-42VDC 50Hz
Puissance nominale / Potencia nominal / Potenza nominale / Potência nominal	12W (11W EPREL)
Type-Longueur de câble / Tipo-Longitud del cable / Tipo-Lunghezza del cavo /	Boitier de connexion / connecting box
Indice de protection / Grado de protección / Indice di protezione / Grau de protecção	IP 44 / IK 04
Dimensions / Dimensiones / Dimensioni / Dimensões	Diam 180mm ht 63mm
Lampes LED / Lámparas LED / Lampade LED / Lâmpadas LED	LED SMD
Recouvrable / can be cover or not	recouvrable uniquement isolant rouleau Mâ M1 hors alimentation
Flux lumineux nominal / Flujo luminoso nominal / Flusso luminoso nominale / Fluxo luminoso nominal	3000K 1149lm 4000K 1570lm 5700K 1572lm
Durée de vie nominale / Vida útil nominal / Durata di vita nominale / Tempo de vida nominal	≥ 50000 h (L70 @ 25°C) *
Cycles de commutation / Ciclos de conmutación / Cicli di accensione / Ciclos de comutação	
Température de couleur / Temperatura de color / Temperatura di colore / Temperatura de cor	3000K, 4000K, 5700K
Indice de rendu des couleurs / Índice de rendimento de color / Índice di resa del colore / Índice de restituição das cores	≥ 80 Ra
Angle de faisceau nominal / Ángulo del haz luminoso nominal / Angolo del fascio nominale / Ângulo nominal do feixe	Narrow ERP 90° (60°)
Facteur de puissance / Factor de potencia / Fattore di potenza / Fator de potência	> 0,9

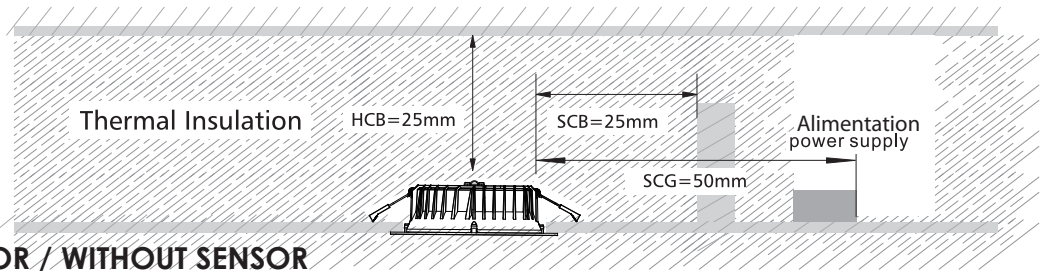
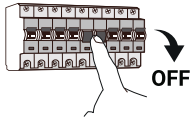

VERSION SANS SENSOR / WITHOUT SENSOR

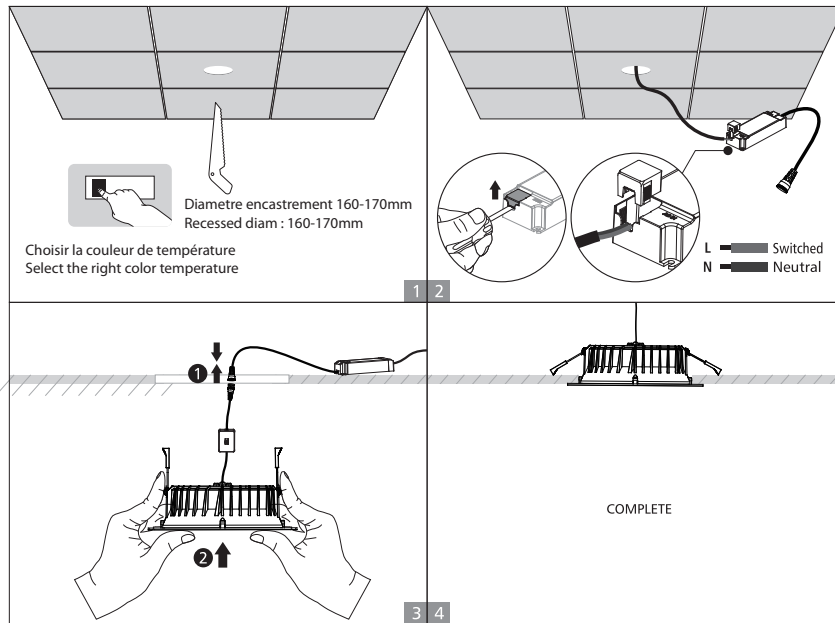

FR

EMBALLAGES A SEPARER
ET A DEPOSER DANS LE
BAC DE TRI



Points de collecte sur www.quefairedemesdechets.fr



FR

Cet appareil,
ses accessoires
et piles
se recyclent



Points de collecte sur www.quefairedemesdechets.fr



L'installation doit être réalisée par un professionnel qualifié
Veuillez couper l'alimentation générale afin d'éviter les risques d'électrocutions
Veuillez vous assurer de la bonne tension du réseau
Ne pas être à moins de 0.3m de tout objet inflammable ou sensible à la chaleur



Terminal block not included, installation and maintenance must be performed by qualified person
Please make sure to turn the power off before installation
Please make sure the lamp is working with the correct input voltage
The minimum distance from lighted objects to luminaires shall be kept at least 0.3m

VERSION AVEC SENSOR / WITH SENSOR

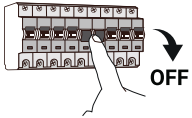

Diametre encastrement 160-170mm
Recessed diam : 160-170mm

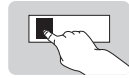

Choisir la couleur de température
Select the right color temperature



Régler le détecteur
Set the sensor

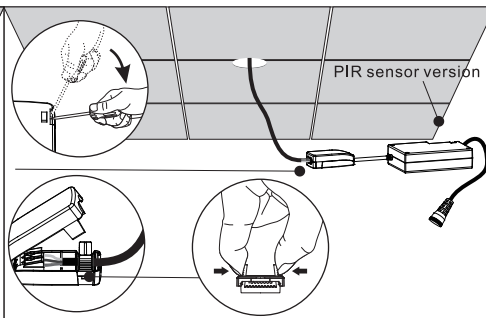

L — Live
N — Neutral
L' — (ON/OFF controlled by sensor)

Wire diameter: 0.5-2.5mm²
Wire stripping length: 8-10mm

1 2

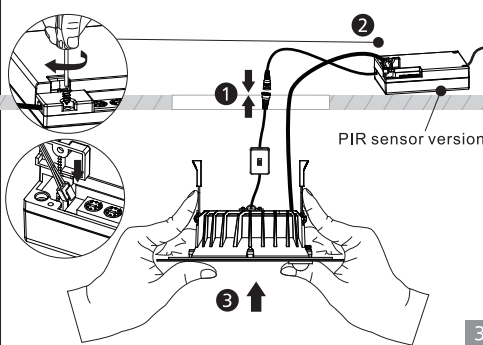

3 4

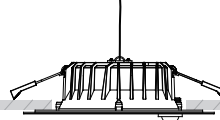

COMPLETE

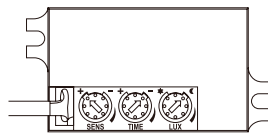

reglages usine, factory settings

Detection Area	Hold Time	Daylight Sensor
100%	10S	10lux

Sensibilité / Detaction area :
Max 6m Mini 2m

Temporisation / Hold time:
10sec à /to 7mn

Capteur lumiere / Daylight sensor :
10lux à / to 2000lux

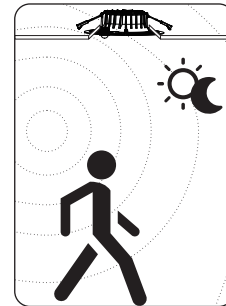

Sensor

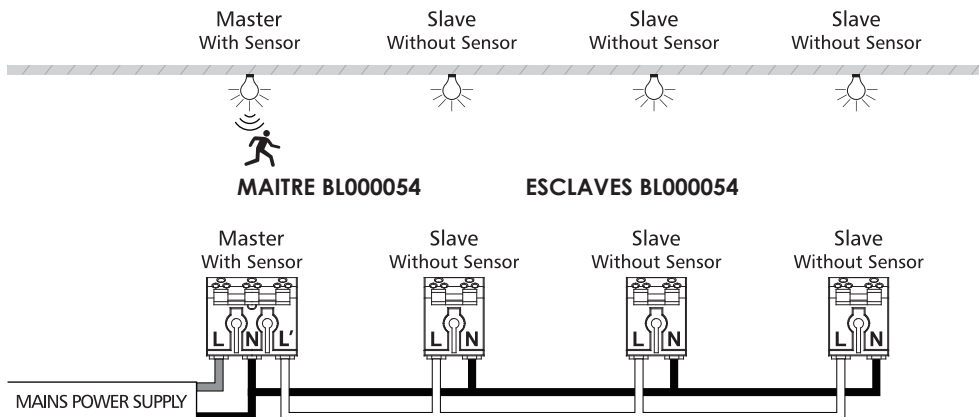

Maitre esclave : installation sur un detecteur : 100W (avec version détecteur compris)

L = Live
N = Neutral
L' = (ON/OFF controlled by sensor)



The total wattage of master and slaves are limited (max.100W)

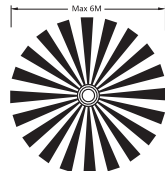
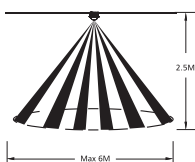

reglages usine, factory settings

Detection Area	Hold Time	Daylight Sensor
100%	10S	10lux