

MATRIX DYNAMIQUE ACTIF CGLine+

Bloc autonome d'éclairage de sécurité / Self-contained luminaire
+ Web-Controller CGLine+

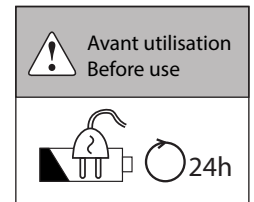

1

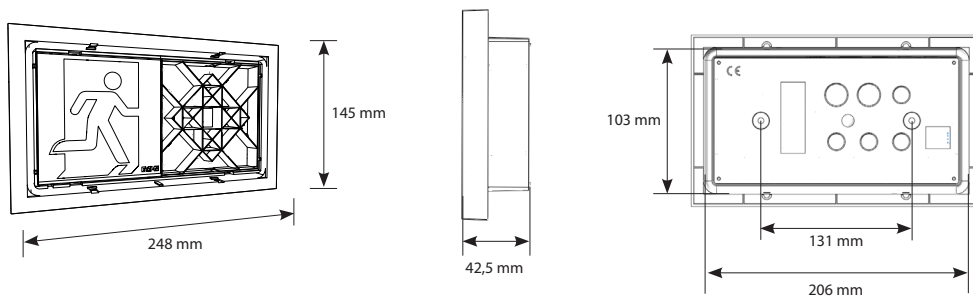
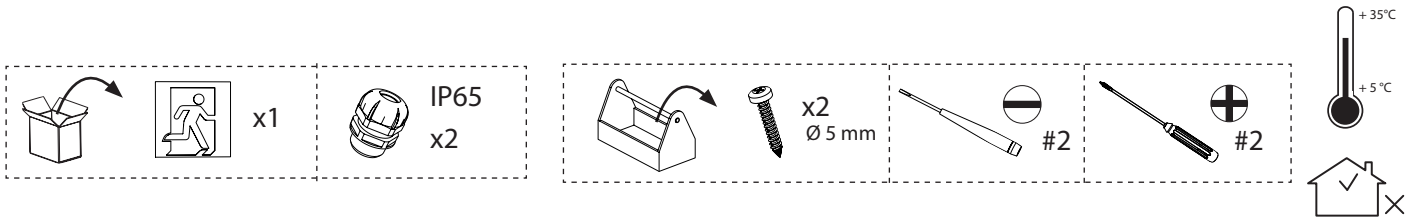

a

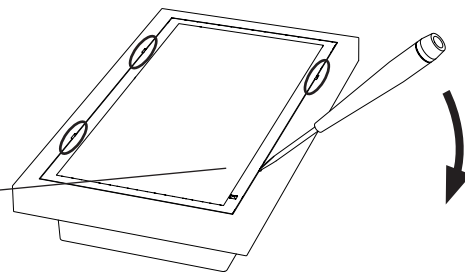
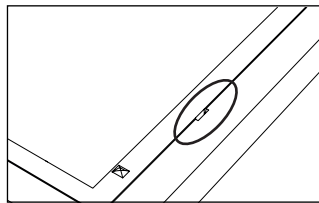

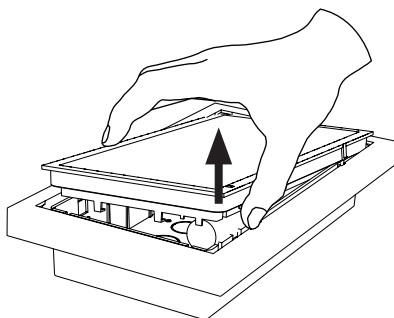

b

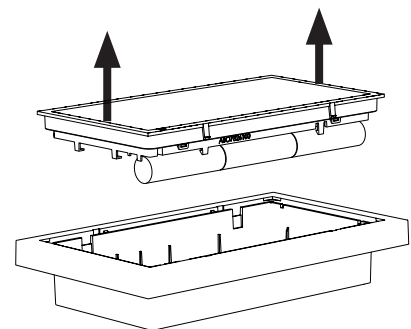

c



2

- ⚠  Ø 20 : Secteur / Mains
-  Ø 15 : Câblage communication / Communication wiring

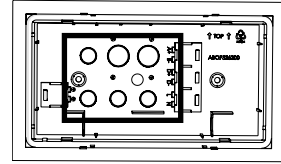
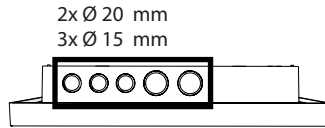

2x Ø 20 mm
4x Ø 15 mm



a

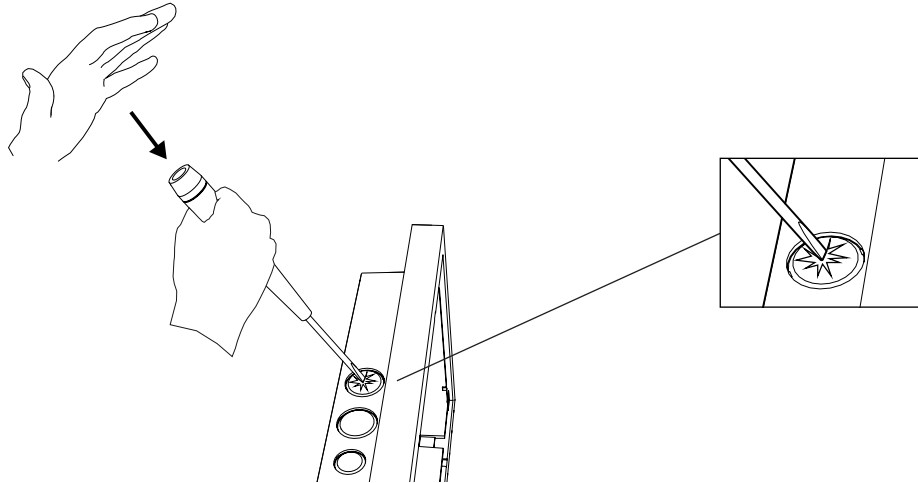

b

IP42 

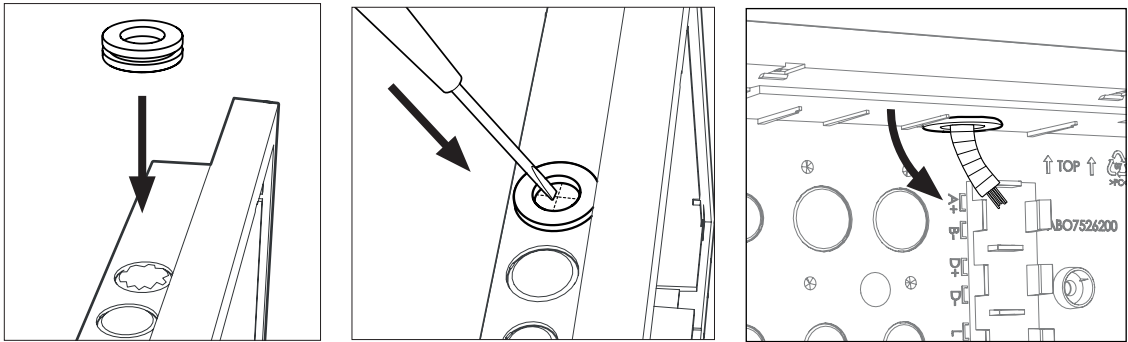

IP65 

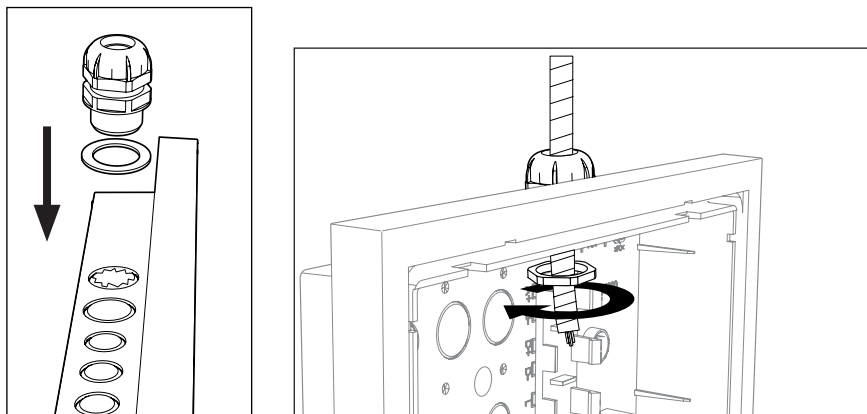

C



Pour la version IP65, vérifier que les rondelles fibres sont correctement installées.
For IP65 variant, make sure the fiber washers are properly installed.

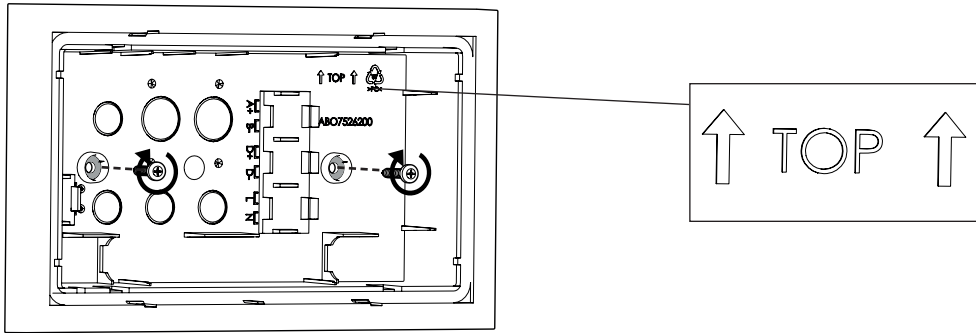

3

Fil souple ou rigide / Rigid or flexible wire
 $0,5 < S < 2,5 \text{ mm}^2$

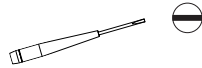

Si fil rigide/ If rigid wire
 $1,5 < S < 2,5 \text{ mm}^2$



Entrée de câble

In

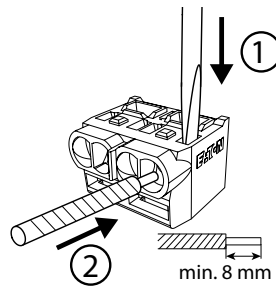

Sortie de câble

Out

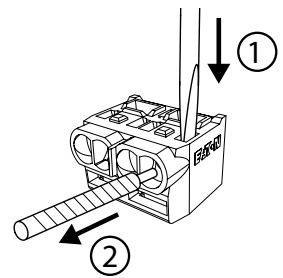

a

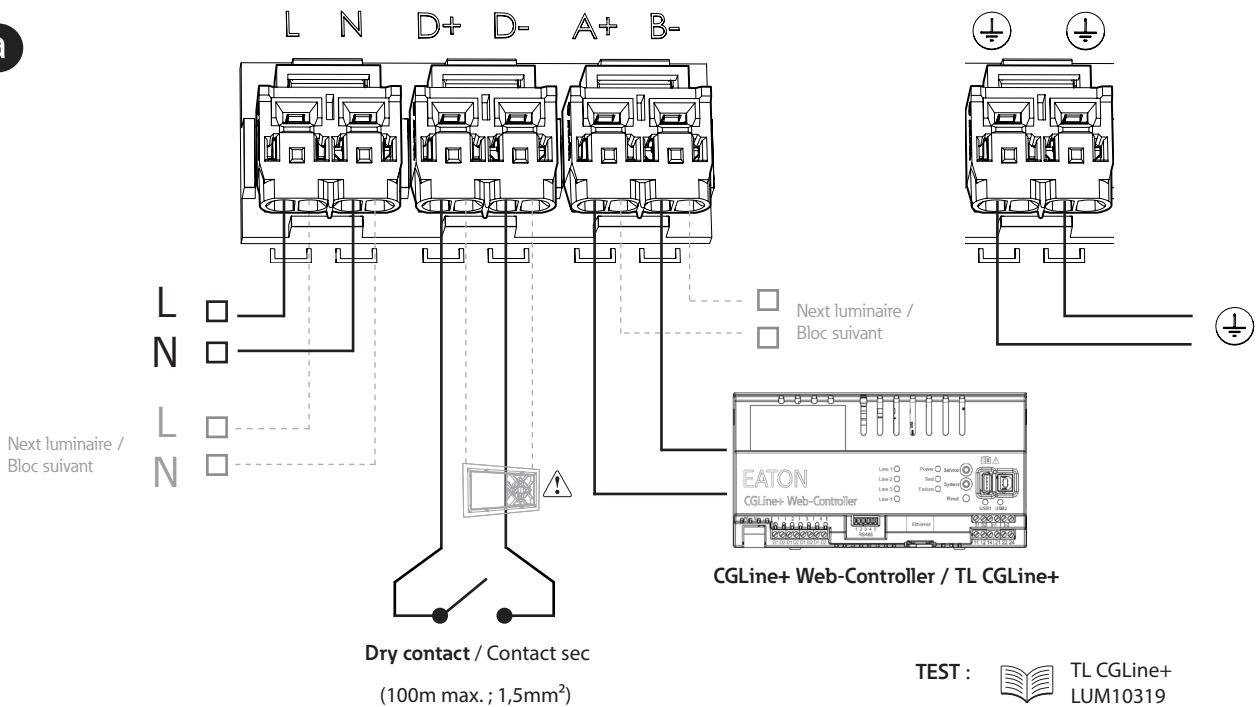

TEST : TL CGLine+ LUM10319

CGLine+ Web-Controller 40071361055

Polarité / Polarity

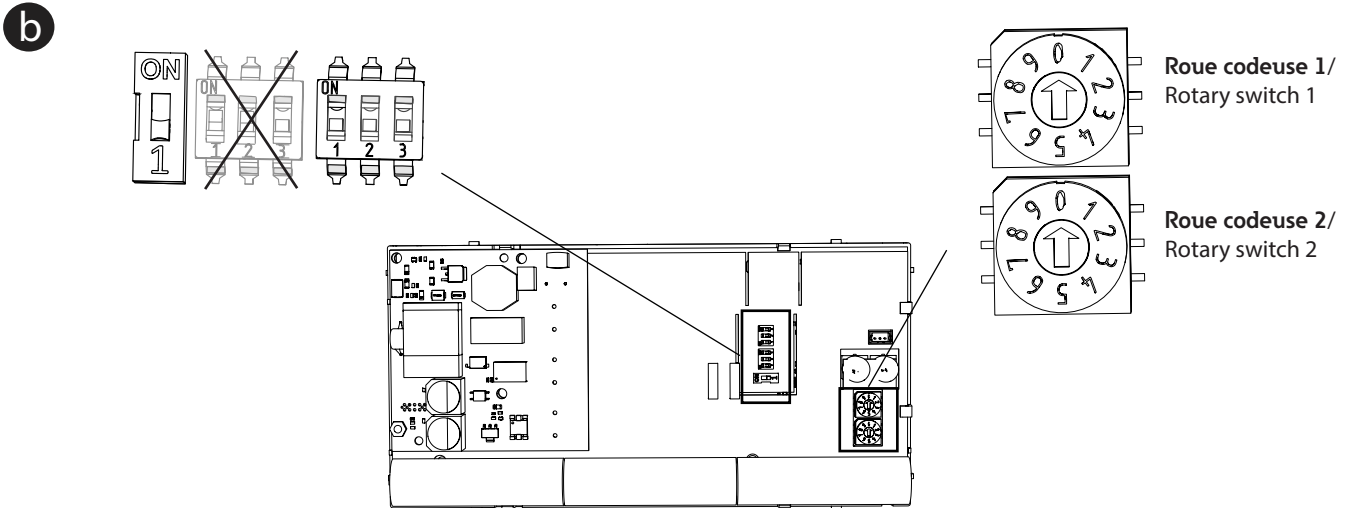

Tests :

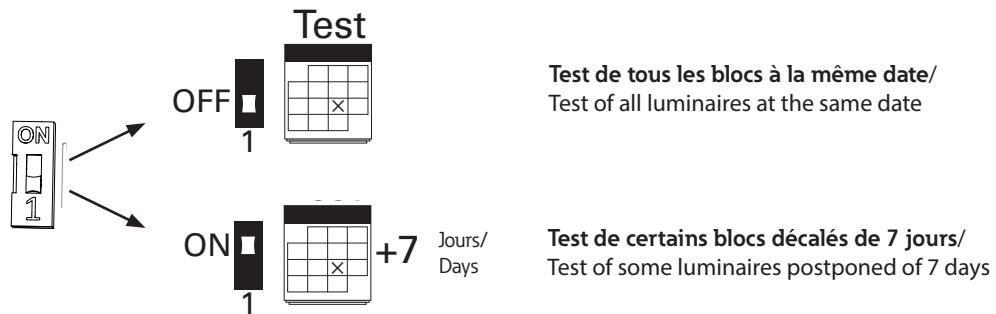

c



Roue codeuse 1 : Affichage par défaut /
Rotary switch 1 : Default signaling

0	1	2	3	4	5
■	←	→	↓	↑	×



Roue codeuse 2 : Affichage lorsque les contacts secs sont fermés
Rotary switch 2 : Signaling when dry contact closed

0	1	2	3	4	5	6	7	8	9
■	←	→	↑	↓	×	←	→	↑	↓

d Réinitialisation
Reset

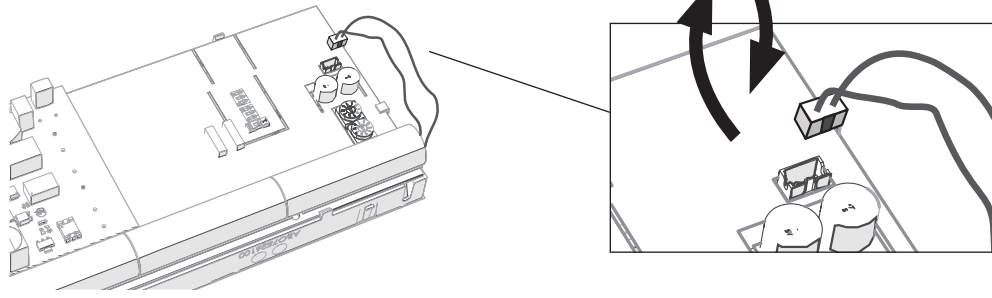

e

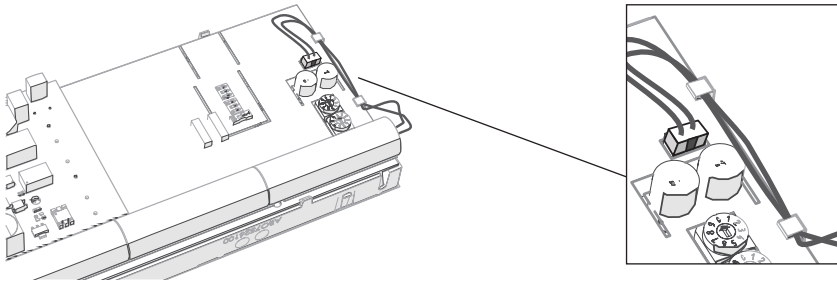

f

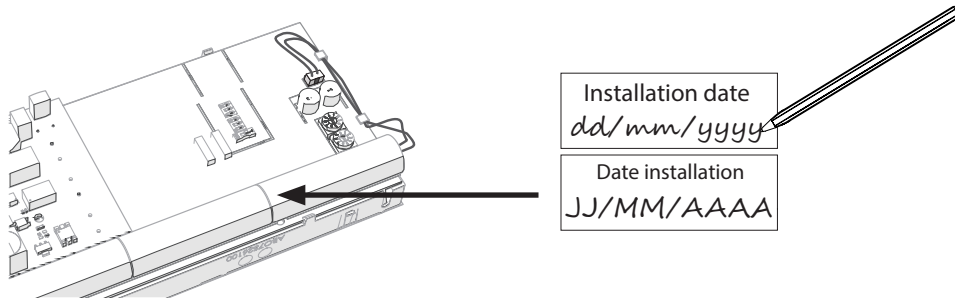

4

a

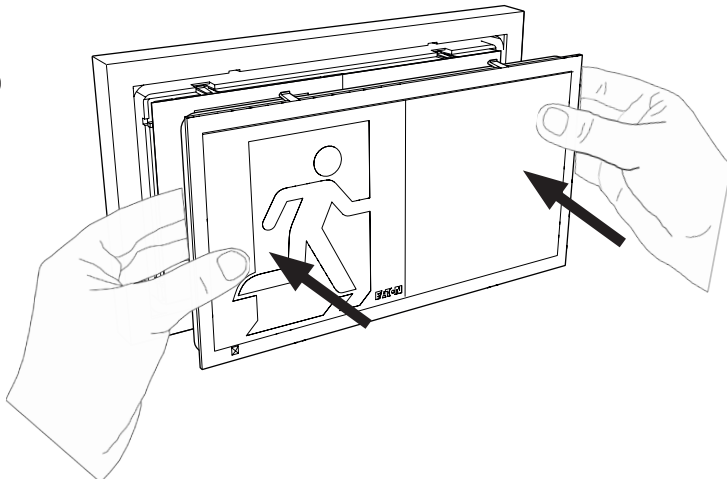

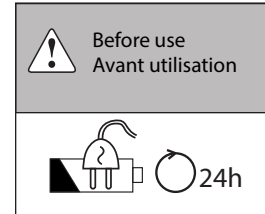
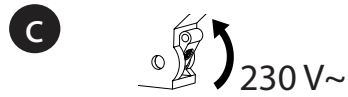
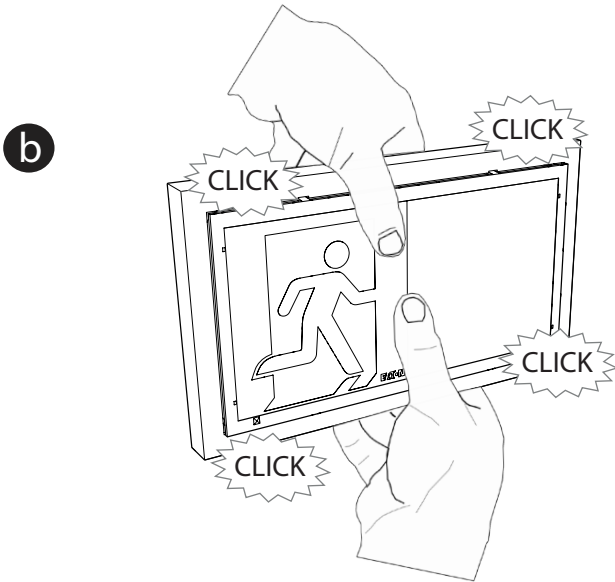

5 Utilisation / Operation

5.1. Voyant / Indicator

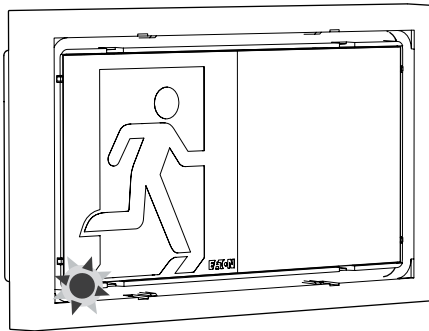

Vert / Green			OK
Vert / Green			Test
Vert & Jaune / Green & yellow))) com
Jaune / Yellow		2 s	
Jaune / Yellow		0,5 s	

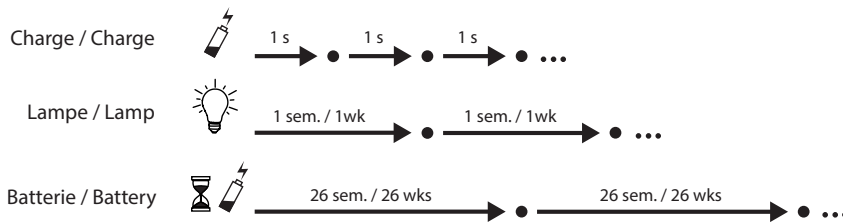

Si absence de web-controller ou défaut de la communication avec le web-controller

If no web-controller or communication fault with the web-controller/

5.2. Test

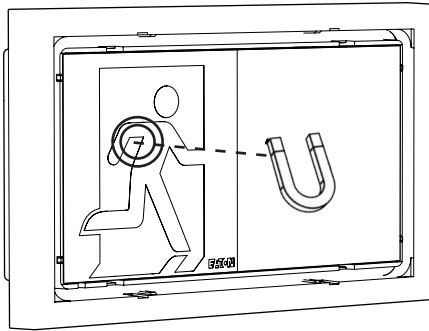

 Ref. 40071352379
F - 1600g

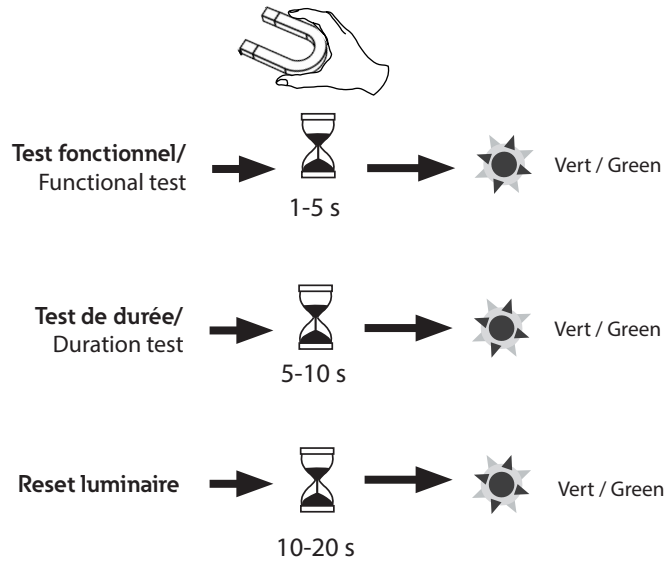



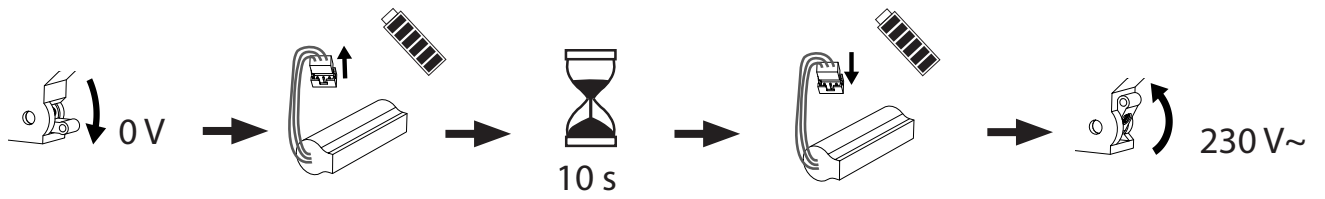



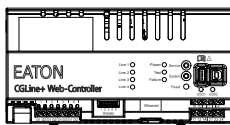

6 Initialisation de l'intervalle des tests et configuration / Initialization of test interval and product configuration

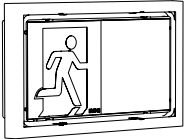

OR CGLine+ web-controller / TL CGLine+



 Voir manuel / See manual
CGLine+ Web-Controller 40071361055
TL CGLine+ LUM10319

								
Matrix Dynamique Actif CGLine+	LUM17200DA	IP42 / IK07	Pack batterie Battery pack	1 h	500 cd/m ²	230 V ~ / 50-60 Hz 14W - 500cd/m ²	EN60598.1 EN60598.2.22 EN1838/ISO30061 EN62034	
	LUM17201DA	IP65 / IK07	3.6 V / 3.3 Ah Li-Ion		62 x LED 2.6V 5mA 38 x LED 3V 30mA 38 x LED 2V 10mA			



Remplaçable
Replaceable



NEXI-BAT3

Si l'autonomie est insuffisante, changer la batterie.
If the battery duration is insufficient, replace the battery.



Non remplaçable
Not replaceable



DEEE: Contactez votre revendeur
WEEE: Contact your local dealer.

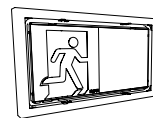

Powering Business Worldwide

Eaton
Cooper Sécurité SAS
PEER II - Rue Beethoven - BP10184
63204 RIOM CEDEX FRANCE
Phone: +33 (0) 825 826 212
www.cooperfrance.com
www.eaton.com

© 2018 Eaton
ZNO2043800 A - 05/2018
All rights reserved.
Tous droits réservés

