

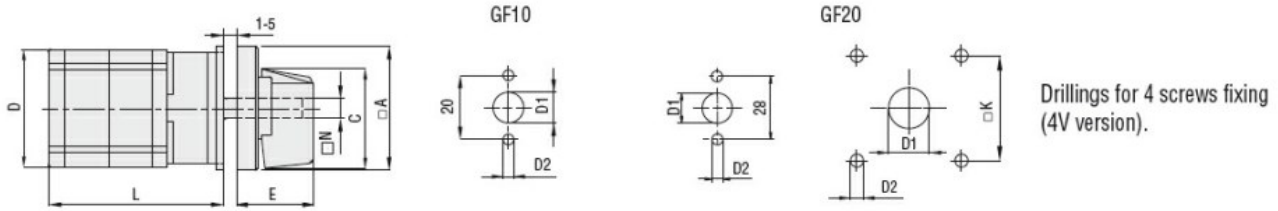

Product designation				Rotary cam switches
Product type designation				GF10
<b>General characteristics</b>				
Switching diagram				03 - ON/OFF spring return switch 3 poles
N° of elements				2
Mounting form				U - Front mounting with black handle
<b>Contact characteristics</b>				
Rated insulation voltage $U_i$	IEC/EN	V	480	
	UL/CSA	V	240	
Rated impulse withstand voltage $U_{imp}$		kV	4	
Conventional free air thermal current $I_{th}$	IEC/EN	A	10	
	UL/CSA	A	10	
Rated operational voltage		V	480	
Rated operational impulse voltage		kV	4	
Maximum fuse size for short-circuit protection $I_n$ (gG)	10kA	A	16	
Rated short time current $I_{cw}$	1s	A	250	
Conductivity				10/5 mA/V
Operational current $I_e$ IEC/EN	AC1/AC21A			A 10
	AC15			
	110V	A	5	
	220/230V	A	3	
	380/400V	A	2	
Rated operational power in AC	Three-phase AC-3			
	220/230V	kW	1.5	
	380/440V	kW	2.2	
Single-phase AC-3	110V	kW	0.3	
	220/230V	kW	0.55	
	380/440V	kW	0.75	
Three-phase AC23A	220/230V	kW	1.8	
	380/440V	kW	3	
Single-phase AC23A	110V	kW	0.7	

	220/230V	kW	0.75
	380/440V	kW	1.1
<b>Rated operational current in DC</b>			
DC21A			
	48V	A	10
	60V	A	7
	110V	A	2
	220V	A	0.7
	440V	A	0.2
<b>DC13</b>			
	24V	A	3
	48V	A	3
	60V	A	2
	110V	A	1
	220V	A	0.3
	440V	A	0.1
<b>Power dissipation</b>		W	0.4
<b>Mechanical features</b>			
<b>Terminals screw</b>			2.5M
<b>Tightening torque for terminals max</b>		Nm	0.4
<b>Conductor size</b>			
AWG - Rigid cable			
	min	AWG	20
	Max	AWG	14
AWG - Flexible cable			
	min	AWG	20
	Max	AWG	14
Conductor size (IEC) - Flexible cable			
	min	mm <sup>2</sup>	0.5
	Max	mm <sup>2</sup>	1.5
Conductor size (IEC) - Rigid cable			
	min	mm <sup>2</sup>	0.5
	Max	mm <sup>2</sup>	1.5
<b>Mechanical life</b>		cycles	1x10 <sup>6</sup>
<b>UL technical data</b>			
<b>Motor power for direct-on-line control</b>			
for three-phase motor			
	240V	HP	2
for single-phase motor			
	240V	HP	0.75
<b>Ambient conditions</b>			
<b>Temperature</b>			
Operating temperature			
	min	°C	-25
	max	°C	+55
Storage temperature			
	min	°C	-40
	max	°C	+70
<b>Resistance &amp; Protection</b>			
<b>Frontal IP degree</b>			IP40
<b>Terminals IP degree</b>			IP20
<b>Dimensions</b>			



Series	Dimensions								L Number of elements											
	□A	C	D	∅D1	∅D2	E	□K	N	1	2	3	4	5	6	7	8	9	10	11	12
GF10	30	24	29	9	3.2	18.5	-	∅5	40	52	64	76	88	100	112	124	-	-	-	-
GF20	48	39.5	36	12	5	26.5	36	□6	44	57.5	71	84.5	98	111.5	125	138.5	152	165.5	179	192.5

### Wiring diagrams

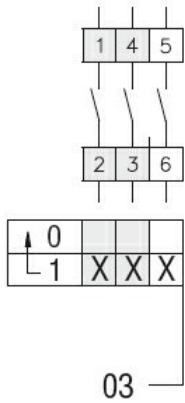

### Certifications and compliance

#### Compliance

CSA C22.2 n° 14  
IEC/EN/BS 60947-1  
IEC/EN/BS 60947-3  
IEC/EN/BS 60947-5-1  
UL60947-4-1

#### Certificates

cULus  
EAC

### ETIM classification

ETIM 8.0

EC001029 -  
Selector switch,  
complete