

THIS COPY IS PROVIDED ON A RESTRICTED BASIS AND IS NOT TO BE USED IN ANY WAY DETRIMENTAL TO THE INTERESTS OF PANDUIT CORP.

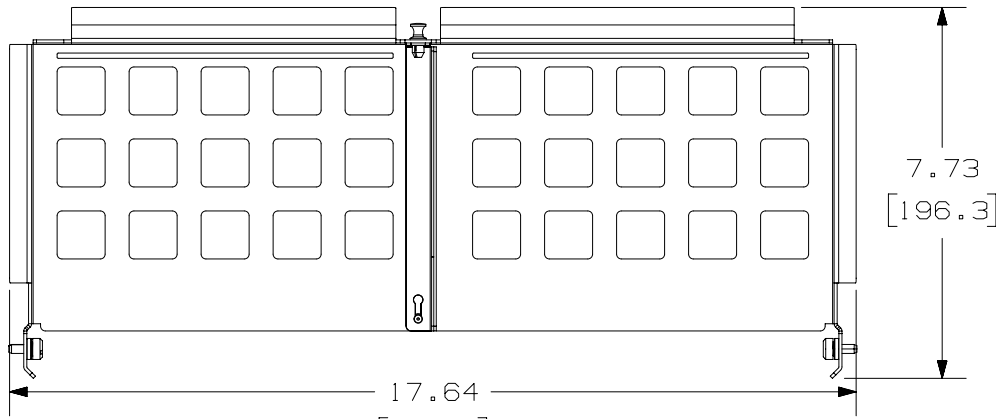

TOP VIEW

NOTES:

1. FLEX-PLATE1UPR AND FLEX-PLATE1UPRW ARE COMPATIBLE WITH 1RU HD FLEX PATCH PANELS FLEX1UPN04**, FLEX1UPN06**, AND FLEX1UPN12**
2. DIMENSIONS IN [] ARE METRIC.
3. ALL MATERIALS AND COMPONENTS USED MEET THE MATERIAL RESTRICTIONS OF RoHS (EUROPEAN DIRECTIVE 2011/65/EU ON THE RESTRICTION OF HAZARDOUS SUBSTANCES) AS PROPOSED BY THE RoHS TECHNICAL ADAPTATION COMMITTEE.
4. WEIGHT: 4 LBS.
5. INCLUDES QUICK-RELEASE DIVIDER WALL TO PREVENT FURCATION TANGLING.
6. TOOLLESS MOUNT TO REAR OF HD FLEX PATCH PANELS.

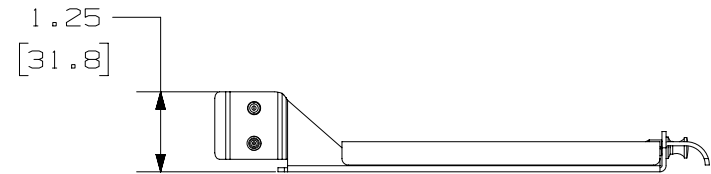

LEFT SIDE VIEW

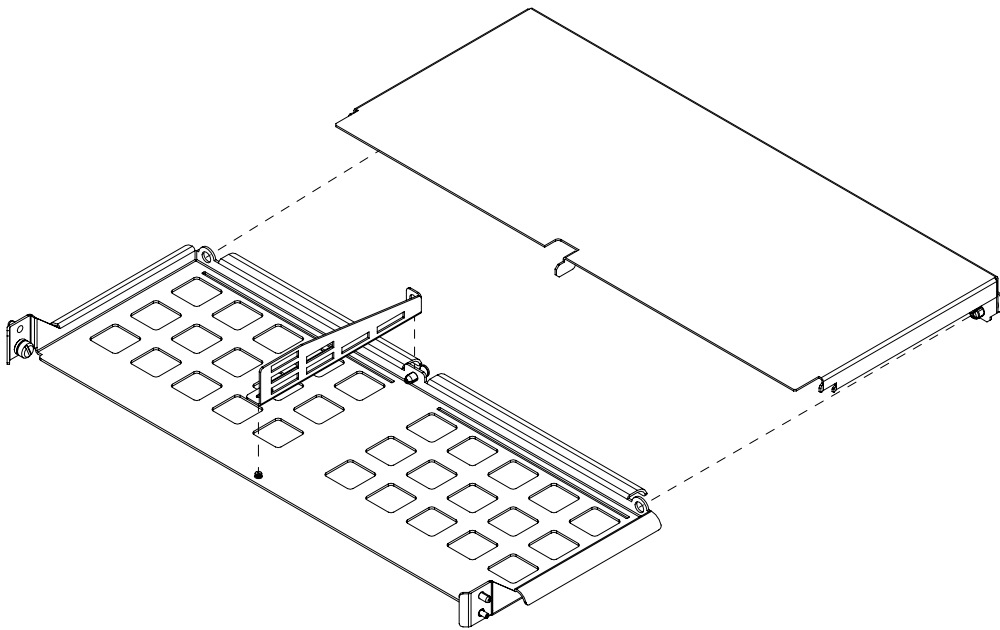

ISO VIEW

PART NUMBER

SHEET 1:
FLEX-PLATE1UPR AND FLEX-PLATE1UPRW

SHEET 2:
FLEX-PLATE2UPR AND FLEX-PLATE2UPRW

SHEET 3:
FLEX-PLATE4UPR AND FLEX-PLATE4UPRW

TITLE
HD FLEX PATCH PANEL REAR COVERS (1RU, 2RU, 4RU)

CUSTOMER DRAWING

ITEM REVISION NAME
00077EPC/00

DATASET FILE NAME
00077EPC_DC/00A

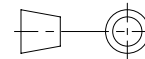

THIRD ANGLE
PROJECTION



MATERIAL
GALVANNEALED STEEL

DRAWING NUMBER
00077EPC-DC

00A	08-02-18	SAT	BJBE	AW	INITIAL RELEASE	00077ECC-DC
REV	DATE	BY	CHK	APR	DESCRIPTION	ECN

DRAWN BY SAT	DATE 07/31/18	CHK BJBE	SCALE NONE	SHEET 1 OF 3	SIZE A
-----------------	------------------	-------------	---------------	--------------	-----------

THIS COPY IS PROVIDED ON A RESTRICTED BASIS AND IS NOT TO BE USED IN ANY WAY DETRIMENTAL TO THE INTERESTS OF PANDUIT CORP.

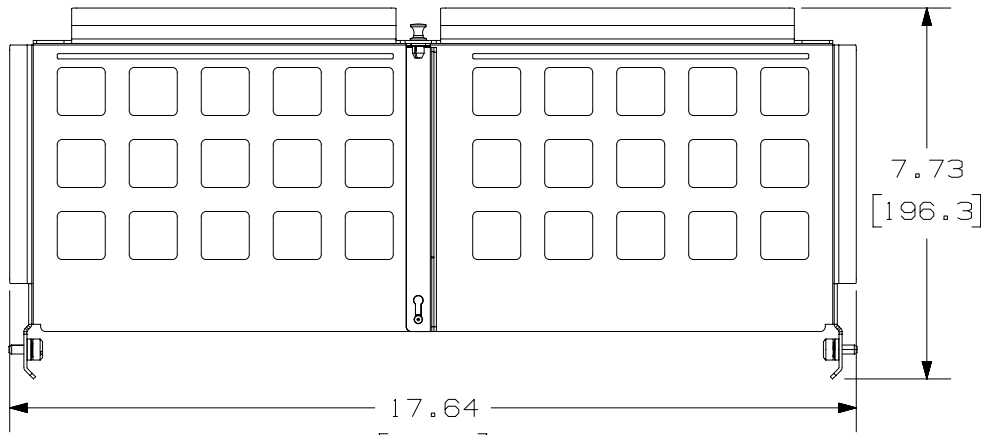

TOP VIEW

NOTES:

1. FLEX-PLATE2UPR AND FLEX-PLATE2UPRW ARE COMPATIBLE WITH 2RU HD FLEX PATCH PANELS FLEX2UPN04**, FLEX2UPN06**, AND FLEX2UPN12**
2. DIMENSIONS IN () ARE METRIC.
3. ALL MATERIALS AND COMPONENTS USED MEET THE MATERIAL RESTRICTIONS OF RoHS (EUROPEAN DIRECTIVE 2011/65/EU ON THE RESTRICTION OF HAZARDOUS SUBSTANCES) AS PROPOSED BY THE RoHS TECHNICAL ADAPTATION COMMITTEE.
4. WEIGHT: 4.75 LBS.
5. INCLUDES QUICK-RELEASE DIVIDER WALL TO PREVENT FURCATION TANGLING.
6. TOOLLESS MOUNT TO REAR OF HD FLEX PATCH PANELS.

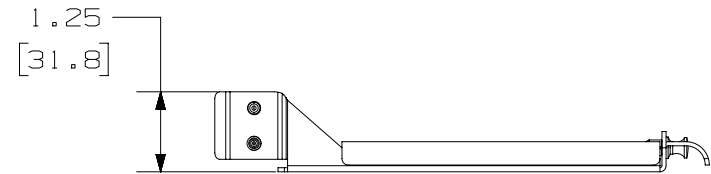

LEFT SIDE VIEW

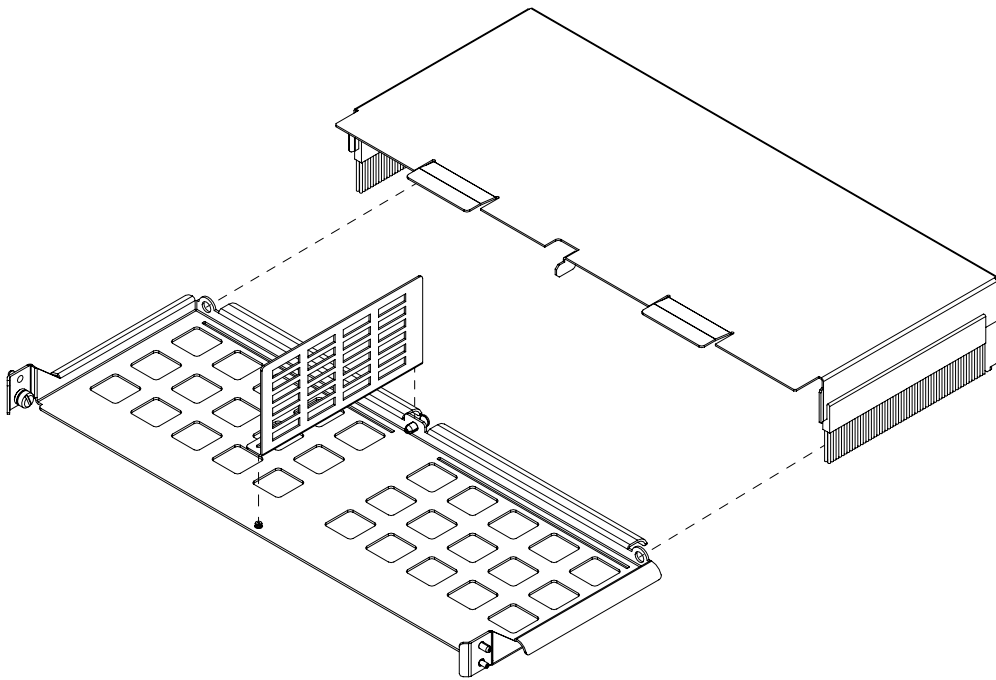

ISO VIEW

PART NUMBER												
<p>SHEET 1: FLEX-PLATE1UPR AND FLEX-PLATE1UPRW</p> <p>SHEET 2: FLEX-PLATE2UPR AND FLEX-PLATE2UPRW</p> <p>SHEET 3: FLEX-PLATE4UPR AND FLEX-PLATE4UPRW</p>												
TITLE												
<p>HD FLEX PATCH PANEL REAR COVERS (1RU, 2RU, 4RU)</p> <p>CUSTOMER DRAWING</p>												
ITEM REVISION NAME												
00077EPC/00												
DATASET FILE NAME												
00077EPC_DC/00A												
					THIRD ANGLE PROJECTION							
MATERIAL												
GALVANNEALED STEEL												
DRAWING NUMBER												
00077EPC-DC												
REV	DATE	BY	CHK	APR	DESCRIPTION	ECN	DRAWN BY	DATE	CHK	SCALE	SHEET 2 OF 3	SIZE
							SAT	07/31/18	BJBE	NONE		A

A-SIZE CUSTOMER

THIS COPY IS PROVIDED ON A RESTRICTED BASIS AND IS NOT TO BE USED IN ANY WAY DETRIMENTAL TO THE INTERESTS OF PANDUIT CORP.

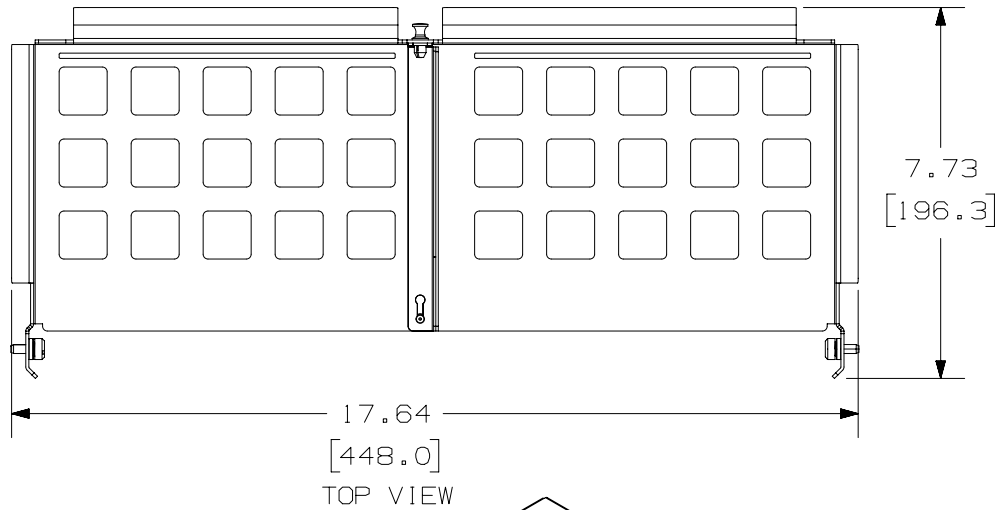

NOTES:

1. FLEX-PLATE4UPR AND FLEX-PLATE4UPRW ARE COMPATIBLE WITH 4RU HD FLEX PATCH PANELS FLEX4UPN04**, FLEX4UPN06**, AND FLEX4UPN12**
2. DIMENSIONS IN () ARE METRIC.
3. ALL MATERIALS AND COMPONENTS USED MEET THE MATERIAL RESTRICTIONS OF RoHS (EUROPEAN DIRECTIVE 2011/65/EU ON THE RESTRICTION OF HAZARDOUS SUBSTANCES) AS PROPOSED BY THE RoHS TECHNICAL ADAPTATION COMMITTEE.
4. WEIGHT: 6.00 LBS.
5. INCLUDES QUICK-RELEASE DIVIDER WALL TO PREVENT FURCATION TANGLING.
6. TOOLLESS MOUNT TO REAR OF HD FLEX PATCH PANELS.

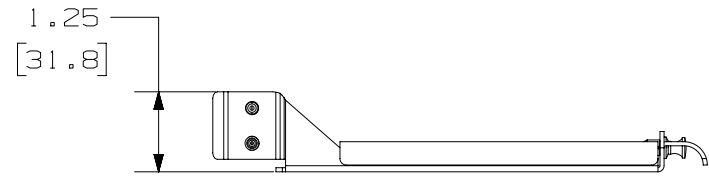

LEFT SIDE VIEW

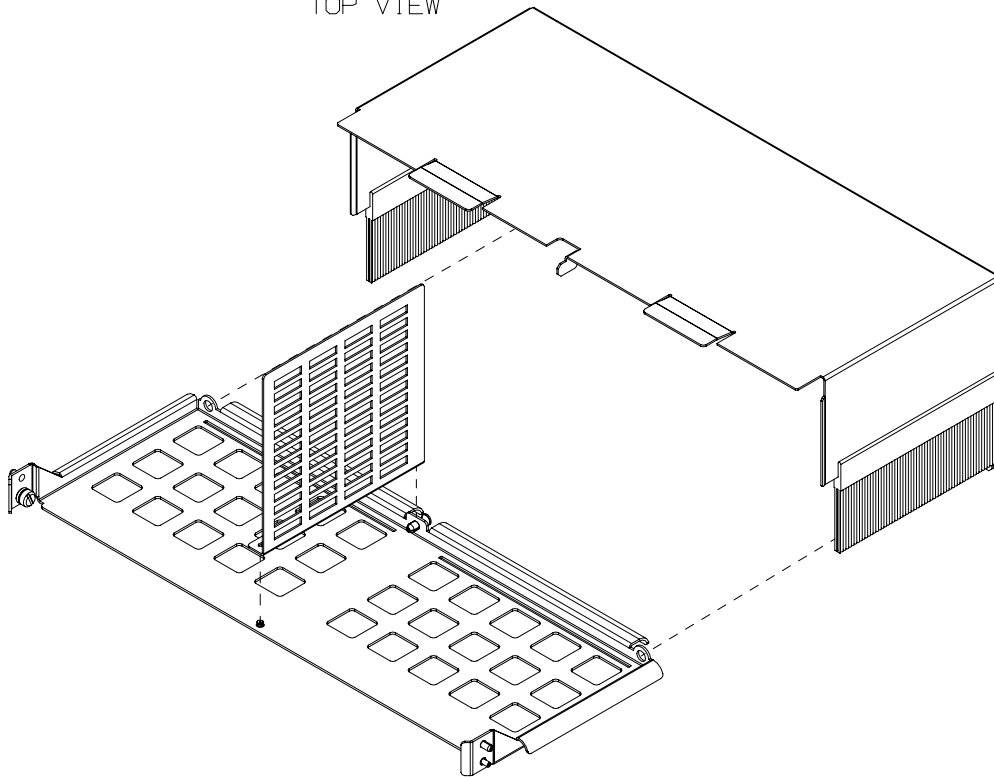

PART NUMBER

SHEET 1:
FLEX-PLATE1UPR AND FLEX-PLATE1UPRW
SHEET 2:
FLEX-PLATE2UPR AND FLEX-PLATE2UPRW
SHEET 3:
FLEX-PLATE4UPR AND FLEX-PLATE4UPRW

TITLE
HD FLEX PATCH PANEL REAR COVERS (1RU, 2RU, 4RU)
CUSTOMER DRAWING

ITEM REVISION NAME
00077EPC/00

DATASET FILE NAME
00077EPC_DC/00A

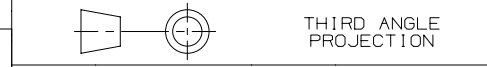

MATERIAL
GALVANNEALED STEEL



DRAWING NUMBER
00077EPC-DC

DRAWN BY: SAT
DATE: 07/31/18
CHK: BJB
SCALE: NONE

SHEET 3 OF 3
SIZE: A

A-SIZE CUSTOMER

REV	DATE	BY	CHK	APR	DESCRIPTION	ECN