

LED SPOT

SMARTLINE SMD



SMARTLINE SMD – RECESSED MOUNTED LED SPOT

As the perfect replacement for traditional halogen spotlights, these LEDSpots with an SMD LED are available with a round or square frame and are ideal for use in furnitures, shelves and false ceilings.

A LEDSpot with rounded front part that clearly sets it apart from any other spotlights.

The elegant, simple design with rounded front part makes it perfect for creating the right lighting atmosphere. This LEDSpot differs clearly from any other spotlights.

Typical applications

- Furniture lighting
- Residential Lighting
- Retail lighting

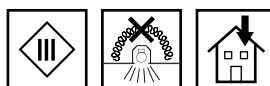

SmartLine SMD

- **CONSTANT-CURRENT OR VOLTAGE-DRIVEN**
- **DEGREE OF PROTECTION: IP40**
- **FIXATION: SNAP-IN CLIPS OR SPRINGS FOR MANY DIFFERENT APPLICATIONS AND WALL THICKNESSES**
- **5 YEARS GUARANTEE**
- **MADE IN ITALY**



SmartLine 700 mA

Complete LEDSpot equipped with optics, heat sink, leads and metal frame

Technical notes

Metal frame, round or square

For cut-out: Ø 56 mm

LEDSpot with one LED and with thermoplastic heat sink

Optics beam angle: 40°

Colour accuracy initially: 3 SDCM

CRI R_a: 80

Leads: Cu tinned, stranded conductors AWG22,
PVC-insulation, length: 250 mm

Use of external LED constant-current drivers

Snap-in clips or springs for easy installation
for luminaire sheets (type LCH-002 and -008)
for ceilings (type LCH-004 and -009)

Degree of protection: IP40

Allowed ambient temperature: 0 to 40 °C

Allowed storage temperature: -30 to 60 °C

Lumen maintenance L70/B50:

50,000 hrs. (t_c/t_p = 70 °C)

Max. operating temperature at t_c point: 85 °C

Weight: 55 g

Packaging unit:

45 pcs. (type LCH-002 and -008)

40 pcs. (type LCH-004 and -009)

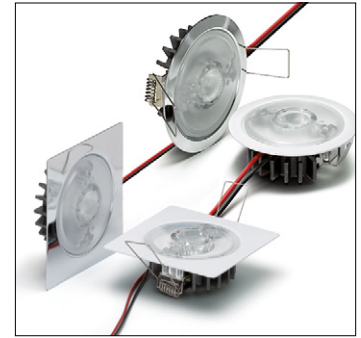

LCH-002

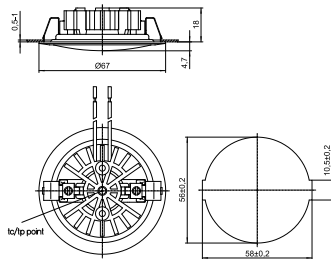

LCH-004

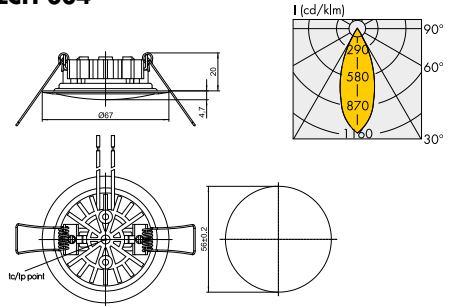

LCH-008

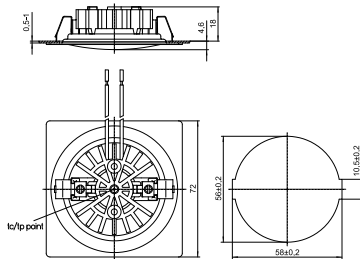

LCH-009

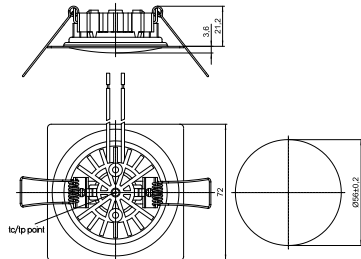

Type	Description	LEDSpot version		Colour	Correlated colour temperature K	Luminous flux (lm) and typical voltage (U _{typ.}) and power consumption (P _{el})*			Light intensity at max. current Candela	Frame shape		Energy efficiency at max. current
		for luminaire sheets	ceilings			350 mA typ.	500 mA typ.	700 mA typ.		round	square	
All types	Smart 219 3000K	A	C	warm white	3000	P _{el} = 0.98 W U _{typ.} = 2.8 V	P _{el} = 1.45 W U _{typ.} = 2.9 V	P _{el} = 2.1 W U _{typ.} = 3.0 V	240	round	square	A++
All types	Smart 219 4500K	B	D	neutral white	4500	140	190	250	255	round	square	A++

Emission data at t_j = 85 °C | * Production tolerance of luminous flux, voltage and power consumption: ±7% | Further colour temperatures on request

Frame colour	For luminaire sheets (LCH-002 and LCH-008)				For ceilings (LCH-004 and LCH-009)			
	Ref. No.	Ref. No.	Ref. No.	Ref. No.	Ref. No.	Ref. No.	Ref. No.	Ref. No.
silver	A (warm white)	B (neutral white)	C (warm white)	D (neutral white)	A (warm white)	B (neutral white)	C (warm white)	D (neutral white)
	round	square	round	square	round	square	round	square
silver mat	561778	561781	561783	561786	561788	561791	561794	561797
white	561779	—	561809	—	561789	—	561795	—
	561780	561782	561785	561787	561790	561792	561796	561798

Silver brushed or further colours on request

The values contained in this data sheet can change due to technical innovations. Any such changes will be made without separate notification.

LEDSpot SmartLine SMD – Furniture and Residential Lighting

LED driver

You will find more information about our LED drivers on our website: www.vossloh-schwabe.com

Capacity range W	Output current DC mA	Output voltage DC V	Ref. No.	Version	Current setting	Dimming	Max. service life time (hrs.)	Dimensions: mm (LxVxH)
700 mA								
5.6	700	2.8–8	186348	EasyLine	—	—	50,000	81.6x42.5x23
17.5	700	2–25	186681	ComfortLine	—	—	100,000	128x37x28
350 mA								
8.75	350	2–25	186519	ComfortLine	—	—	100,000	65x30.7x21.5
11	350	2–32	186679	ComfortLine	—	—	100,000	128x37x28

Please ensure you choose the correct LED driver for the module in question and that the respective output parameters (current, voltage, wattage) are correct.

SmartLine 12 V DC

Complete LEDSpot equipped with optics, heat sink, leads and metal frame

Technical notes

CA system control
 Round frame: metal, silver
 For cut-out: Ø 56 mm
 LEDSpot with one LED and with thermoplastic heat sink
 Optics beam angle: 36°
 CRI R_a: 80
 Leads: Cu tinned, stranded conductors AWG22,
 PVC-insulation, length: 250 mm
 Use of external LED constant-voltage converter
 Snap-in clips for easy installation
 Degree of protection: IP40
 Allowed ambient temperature: 0 to 40 °C
 Allowed storage temperature: -30 to 60 °C
 Lumen maintenance L70/B50:
 50,000 hrs. (t_c/t_p = 70 °C)
 Max. operating temperature at t_c point: 80 °C
 Weight: 55 g
 Packaging unit: 45 pcs.

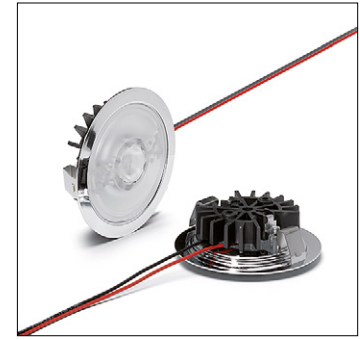

LCH-051

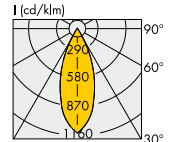
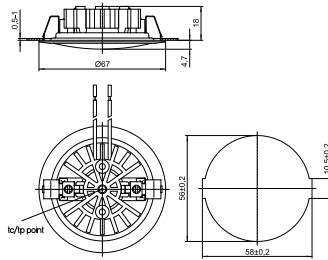

Type	Description	Ref. No.	Colour	Correlated colour temperature K	Max. power consumption W	Typ. luminous flux* lm	Typ. CRI R _a	Beam angle °	Light intensity Candela	Energy efficiency
------	-------------	----------	--------	---------------------------------	--------------------------	------------------------	-------------------------	--------------	-------------------------	-------------------

SmartLine 12 V DC

LCH051	Smart Wi 12 V	569249	warm white	3000	2	155	80	36	280	A++
LCH051	Smart Wi 12 V	568262	neutral white	4000	2	160	80	36	280	A++

Emission data at t_i = 85 °C | * Measurement tolerance of luminous flux, voltage, power consumption: ± 7% | Further colour temperatures and frame colours on request

LED converters

You will find more information about our LED converter on our website: www.vossloh-schwabe.com

Capacity range W	Mains voltage 50–60 Hz V ±10 %	Output current A	Ref. No.	Version	Max. service life time hrs.	Service life time at °C	Connection	Dimensions LxWxH mm
------------------	--------------------------------	------------------	----------	---------	-----------------------------	-------------------------	------------	---------------------

12 V

6	220–240	0–0.5	186412	EasyLine	50,000	55	Preassembled leads	81.6x42.5x23
12	220–240	0–1	186204	ComfortLine	100,000	65	Screw terminals	103.5x36x22
20	220–240	0–1.68	186620	EasyLine	50,000	65	Screw terminals	123x45x19
60	220–240	0–5	186621	EasyLine	50,000	70 / 80	Screw terminals	180x52x30
75	220–240	0–6.25	186622	EasyLine	50,000	75	Screw terminals	180x52x30
100	220–240	0–8.4	186623	EasyLine	50,000	70 / 80	Screw terminals	300x40x30

Please ensure you choose the correct LED driver for the module in question and that the respective output parameters (current, voltage, wattage) are correct.

The values contained in this data sheet can change due to technical innovations. Any such changes will be made without separate notification.

Surface Kit with Mounted LEDspot

Metal frame to use LEDspot IPLine, SmartLine, StartLine or Flatline as surface mounting spots
 Two single pole terminals for electrical connection inside the kit (frame + spot)
 Fixation by self tapping screws
 Packaging unit: 90 pcs.

Ref. No.: 554845 Frame colour: white

Ref. No.: 554843 Frame colour: silver

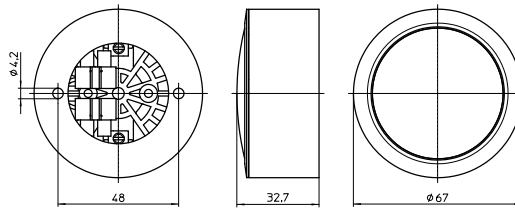
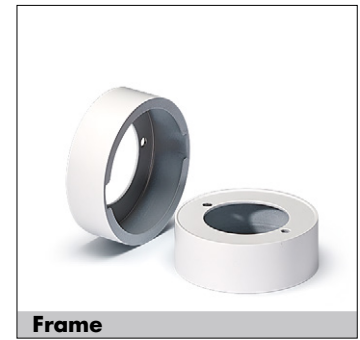

SmartLine SMD – Installation Instruction

General safety information

- VS product may only be installed and commissioned by authorised and fully qualified staff.
- These instructions must be carefully read before installing and commissioning the system, as this is the only way to ensure safe and correct handling.
- An external driver for max. 700 mA or an external converter 12 V DC is required.
- Before any work is carried out on the equipment, it must be disconnected from the mains.
- All valid safety and accident-prevention regulations must be observed.
- The products should never be inexpertly opened. Repairs may only be undertaken by the manufacturer.
- Dimming: The dimming characteristics of the installed driver have to be observed.
- The photo biological safety of the LED modules is classified into risk groups in accordance with EN 62471: 2008 and IEC TR 62778: risk group 1.

See drawing and cut out for each product on previous pages

Built-in

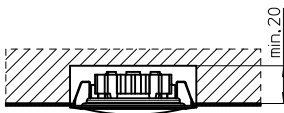

Correct position

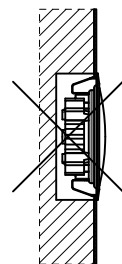
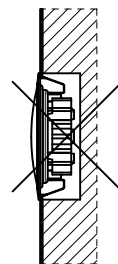
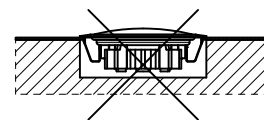
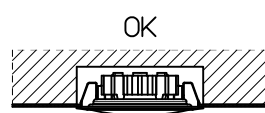

The values contained in this data sheet can change due to technical innovations. Any such changes will be made without separate notification.

All VS LED Spots at a glance

Tiny

LEDSpot with optics, leads and metal frame
 For cut-out: Ø 26 mm
 Beam angle: 36°
 Lumen output: max. 140 lm
 Versions: CC, CV, Kit



StartLine

LEDSpot with optics, heat sink, leads and frame
 For cut-out: Ø 56 mm
 Beam angle: 30°, 36°, 38°
 Lumen output: max. 250 lm
 Versions: CC, CV



EffectLine

LEDSpot with optics, heat sink, leads and metal frame
 For cut-out: Ø 37 mm
 Beam angle: 10°, 16°, 28° or 38°
 Lumen output: max. 250 lm
 Versions: CC

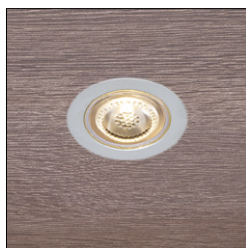

IPLine

LEDSpot IP54 with optics, heat sink, leads and metal frame
 For cut-out: Ø 56 mm
 Beam angle: 40°
 Lumen output: max. 330 lm
 Versions: CC



FlatLine

LEDSpot with optics, leads and metal frame
 For cut-out: Ø 56 mm
 Beam angle: 60°, 70°
 Lumen output: max. 270 lm
 Versions: CC, CV, TW, Kit



DisLine

LEDSpot with optics, heat sink, leads and metal frame
 For cut-out: Ø 56 mm
 Beam angle: 45°, 55°
 Lumen output: max. 220 lm
 Versionen CC



SmartLine COB

LEDSpot with optics, heat sink, leads and metal frame
 For cut-out: Ø 56 mm
 Beam angle: 40°
 Lumen output: max. 330 lm
 Versions: CC



SoftLine

LEDSpot with heat sink, leads and metal frame
 For cut-out: Ø 56 mm
 Beam angle: 90°
 Lumen output: max. 225 lm
 Versions: CV



SmartLine SMD

LEDSpot with optics, heat sink, leads and metal frame
 For cut-out: Ø 56 mm
 Beam angle: 36°, 40°
 Lumen output: max. 250 lm
 Versions: CC, CV



Revo

LEDSpot with optics and frame
 For cut-out: 67.5x25x5 mm
 Beam angle: 60°, 70°
 Lumen output: max. 255 lm
 Versions: CC, CV, TW

