

B2/15

GU4 MIROIR DICHROIQUE FERME - VERRE CLAIR - MR 11 - Ø 35 x 38 MM
Dichroic mirror - Closed - Clear glass lens

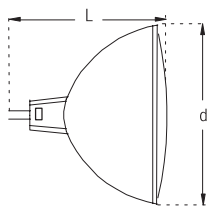

CODE STOCK PART NUMBER	RÉFÉRENCE	CODE ANSI	VOLTS	WATTS	ANGLE BEAM	CANDELA CD	DURÉE DE VIE AC LIFE
---------------------------	-----------	--------------	-------	-------	---------------	---------------	-------------------------

BLUE LINE



132491	H 68064 F	FTA	12	12	7°	5 760	2 000
131492	H 68052 F	FTB	12	20	10°	4 950	2 000
131494	H 68051 F	FTC	12	20	17°	1 584	2 000
131270	H 68062 F	FTD	12	20	30°	540	2 000
131272	H 68065 F	FTE	12	35	10°	8 100	2 000
131274	H 68066 F	FTF	12	35	20°	2 700	2 000
131276	H 68067 F	FTH	12	35	30°	1 240	2 000
131359	H 68084 F		24	10	30°		2 000
131493	H 68082 F		24	20	30°	500	2 000
132492	H 68083 F		24	35	30°	1 200	2 000

BRILLANCE



131264	H 68062 FC	FTD	12	20	30°		
131273	H 68067 FC	TFH	12	35	30°		

OSRAM DECOSTAR



131280	H 44888 WFL		12	10	38°	300	2 000
132337	H 44890 WFL	FTD	12	20	38°	500	2 000
131275	H 44892 WFL	FTH	12	35	38°	900	2 000

B2/16

GU4 MIROIR DICHROIQUE FERME - VERRE COLORE- MR 11 - Ø 35 x 38 MM
Dichroic mirror - Closed - colored glass

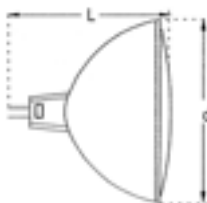

CODE STOCK PART NUMBER	RÉFÉRENCE	VOLTS	WATTS	ANGLE BEAM	DURÉE DE VIE AC LIFE	COULEUR COLOR
---------------------------	-----------	-------	-------	---------------	-------------------------	------------------

132493	H 68052 FB	12	20	10°	2 000	BLEU/BLUE
132494	H 68052 FG	12	20	10°	2 000	VERT/GREEN
132495	H 68052 FR	12	20	10°	2 000	ROUGE/RED
132496	H 68052 FY	12	20	10°	2 000	JAUNE/YELLOW
132497	H 68051 FB	12	35	10°	2 000	BLEU/BLUE

