

Chemin de câbles fil
(Mesh tray)

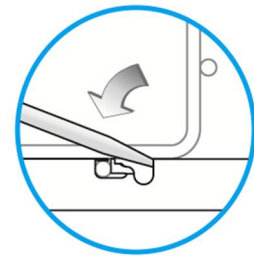

Description	Code	Masse/Weight Kg/p	Ep./Th. mm	H mm	l./w. mm
ZUF 150 U ZM	553147	0,140	1,75	22	145

💡 30 ▶ 105 mm
50 ▶ 600 mm

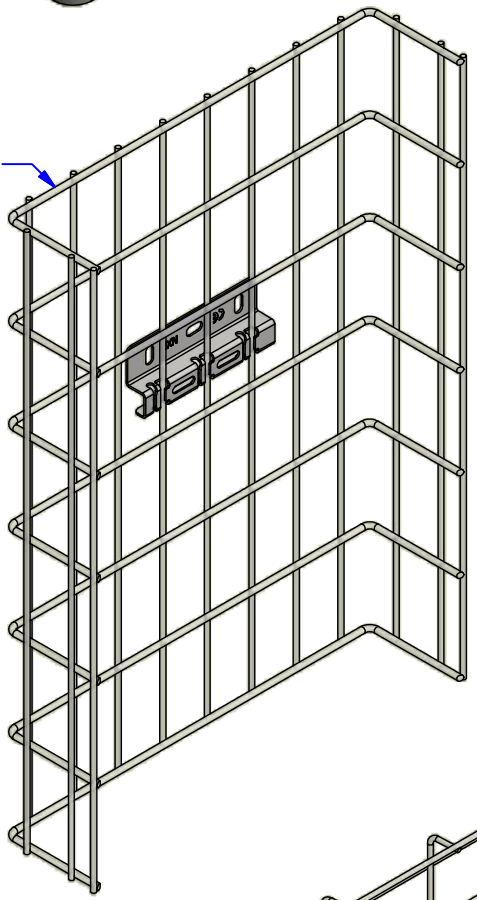

www.niedaxfrance.fr

ZM : High performance coated zinc according to NF A 91102
ZM : Revêtement haute tenue corrosion suivant NF A 91102

ZED FIXATION ZUF 150 U ZM
 ZUF 150U CLIP-ON BRACKET ZM



ASSISTANCE TECHNIQUE
 +33 (0)1 55 95 92 17
 pole.technique@niedax.fr

FT02884

NIEDAX
 France

