

THIS COPY IS PROVIDED ON A RESTRICTED BASIS AND IS NOT TO BE USED IN ANY WAY DETRIMENTAL TO THE INTERESTS OF PANDUIT CORP.

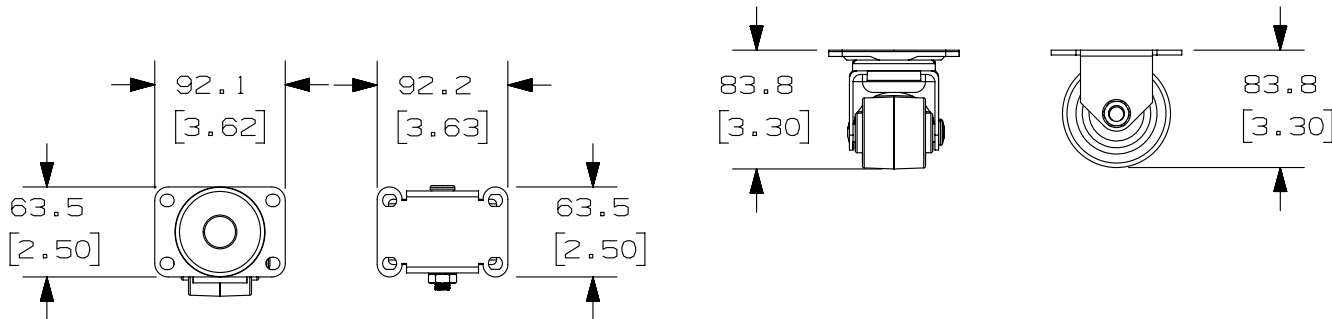

PANDUIT P/N	WEIGHT
SCSTR4	5.5 Kg/EACH 12.1 LBS/EACH

- NOTES:
- VISIT OUR ON-LINE CATALOG AT WWW.PANDUIT.COM FOR A LIST OF CURRENT PARTS APPLICABLE FOR USE WITH THIS PRODUCT.
 - PRIMARY DIMENSIONS ARE IN MILLIMETERS (mm).
 - PARTS SUPPLIED:
 - (2) - FIXED CASTER ASSEMBLIES
 - (2) - SWIVEL CASTER ASSEMBLIES
 - (16) - M8x1.25 NYLON-INSERT LOCK NUT
 - (1) - INSTRUCTION SHEET
 - CASTERS ADD 24mm (1") TO HEIGHT OF CABINET.

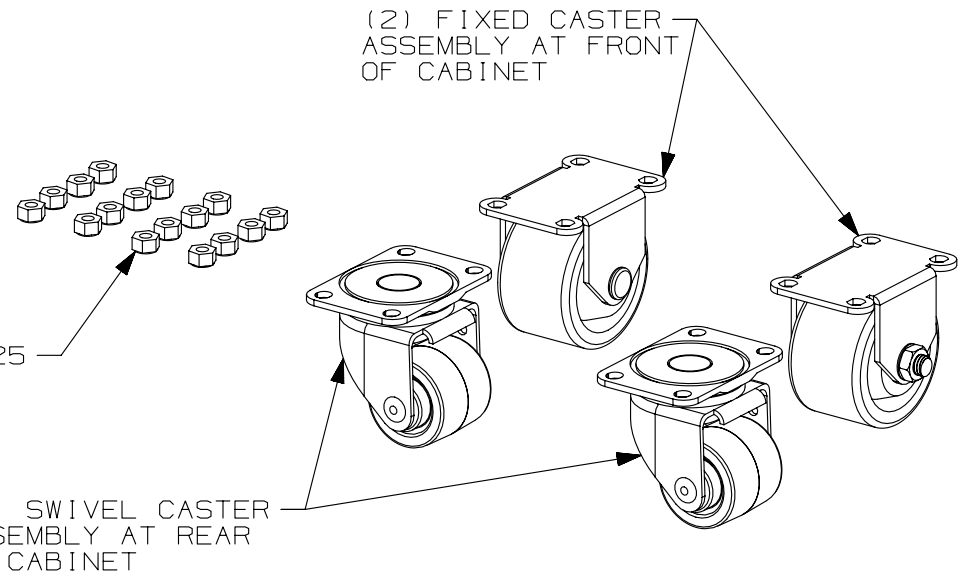

(16) M8 X 1.25
NYLON-INSERT
LOCK NUT

(2) SWIVEL CASTER
ASSEMBLY AT REAR
OF CABINET

REV	DATE	BY	CHK	APR	DESCRIPTION	ECN	TITLE	ITEM REVISION NAME	DATASET FILE NAME	UNLESS OTHERWISE SPECIFIED, DIMENSIONAL TOLERANCES ARE:	MATERIAL/COLOR:	DRAWING NUMBER:	
00A	8-28-13	PBS			RELEASED TO PRODUCTION	12V352AU-DC	S-TYPE CABINET CASTER KIT (SCSTR4) CUSTOMER DRAWING	12V352AU/00.PRT	12V352AU_DC/00A.PRT	INCHES X.X +/- 0.03 X.XX +/- 0.018 X.XXX +/- 0.007	METRIC - MILLIMETER X. +/- 0.8 X.X +/- 0.46 X.XX +/- 0.18	ANGLE +/- 1°	N/A
							CONTROL DRAWING					12V352AU-DC	
							THIRD ANGLE PROJECTION					SHT 1 OF 1	
								SCALE				SIZE	
								NONE				A	