

Part number

# CKSHF 04



Female insert, CKSH series, SQUICH® spring terminal connection without tools, 4 poles + PE, 10 A 400 V 4 kV 3, size "21.21"

| Product description                           |   | Material properties              |  |
|---|---|----------------------------------|--|
| <b>Product type</b>                           | Insert  | <b>Main material</b>             | Polycarbonate (PC)   |
| <b>Series</b>                                 | CKSH  | <b>Other materials</b>           | Contacts: copper alloy   |
| <b>Connection type</b>                        | SQUICH® spring terminal connection without tools  | <b>Colour</b>                    | RAL 7032 grey  |
| <b>Gender</b>                                 | Female  | <b>RoHs conformity</b>           | Compliant with exemption 6(c): copper alloy containing up to 4% lead by weight |
| <b>N. of poles</b>                            | 4 poles +  | <b>China RoHs - EFUP</b>         | 50   |
| <b>Size</b>                                   | Size "21.21"  | <b>REACH SVHC substances</b>     | Yes<br>Lead  |
| Technical data                                |   | Approvals / Standards            |  |
| <b>Current</b>                                | 10 A  | <b>Certifications</b>            | DNV-GL, BV, EAC  |
| <b>Voltage</b>                                | 400 V   | <b>UL</b>                        | ECBT2  |
| <b>Rated impulse withstand voltage</b>        | 4 kV  | <b>cUL</b>                       | ECBT8  |
| <b>Pollution degree</b>                       | 3   | General ordering information     |  |
| <b>Rated voltage according to UL/CSA</b>      | 600 V   | <b>EAN13 code</b>                | 8015747234610  |
| <b>Wire cross-section</b>                     | 0,14 mm <sup>2</sup> - 2,50 mm <sup>2</sup>   | <b>eCl@ss 8.1</b>                | 27440205   |
| <b>AWG size</b>                               | 26 - 14   | <b>ETIM 7.0</b>                  | EC000438   |
| <b>Contact type</b>                           | Turned silver plated  | Packaging Information            |  |
| <b>IP degree of protection</b>                | IP20 without enclosure,<br>IP44/IP66/IP67/IP68/IP69 with enclosure                            | <b>Packaging length</b>          | 200,00 mm  |
| Further technical details                     |   | <b>Packaging height</b>          | 245,00 mm  |
| <b>Characteristics according to EN 61984</b>  | 10A 400V 4kV 3; 10A 690V 4kV 2  | <b>Packaging width</b>           | 146,00 mm  |
| <b>Mating cycles</b>                          | ≥ 500   | <b>Packaging weight</b>          | 3,70 kg  |
| <b>Insulation resistance</b>                  | ≥ 10 GΩ   | <b>Packaging volume</b>          | 7,15 dm <sup>3</sup>   |
| <b>Contact resistance</b>                     | ≤ 3 mΩ  | <b>Packaging description</b>     | Carton box   |
| <b>Weight</b>                                 | 17,00 g   | <b>Packaging quantity</b>        | 200 Pcs  |
| <b>Operating temperature range (min, max)</b> | -40 °C ... +125 °C  | <b>Packaging EAN code</b>        | 8015747234672  |
| <b>Conductors stripping length</b>            | 9...11 mm   | <b>Sub-packaging length</b>      | 116,00 mm  |
| <b>UL 94 flammability rating</b>              | V-0   | <b>Sub-packaging height</b>      | 43,00 mm   |
| <b>Tightening torque for fixing screws</b>    | M3: 0,5 Nm; 4,4 lb.in (Ph1 or 0,8 x 5,5 mm)   | <b>Sub-packaging width</b>       | 180,00 mm  |
|   |   | <b>Sub-packaging weight</b>      | 0,74 kg  |
|   |   | <b>Sub-packaging volume</b>      | 0,90 dm <sup>3</sup>   |
|   |   | <b>Sub-packaging description</b> | Carton tray  |
|   |   | <b>Sub-packaging quantity</b>    | 40 Pcs   |
|   |   | <b>Sub-packaging EAN barcode</b> | 8015747234689  |

Part number

# CKSHF 04



## Catalogue drawings

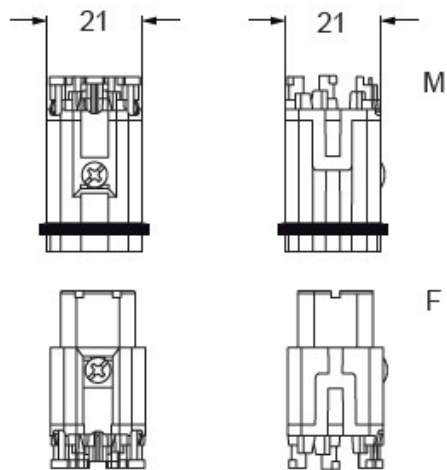

contacts side (front view)



## Derating curves

CKSH 04 poles connector inserts  
Maximum current load derating diagram

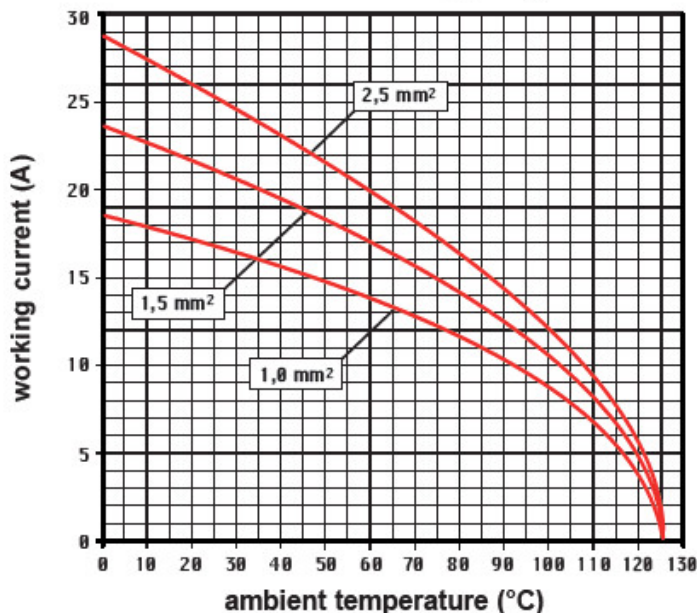

## Notes

Dimensions shown in mm are not binding and may be changed without notice.

### California Proposition 65 Information



### WARNING

This product can expose you to lead and its compounds, known to the State of California to cause cancer and/or reproductive toxicity. For more information go to [www.P65Warnings.ca.gov](http://www.P65Warnings.ca.gov).

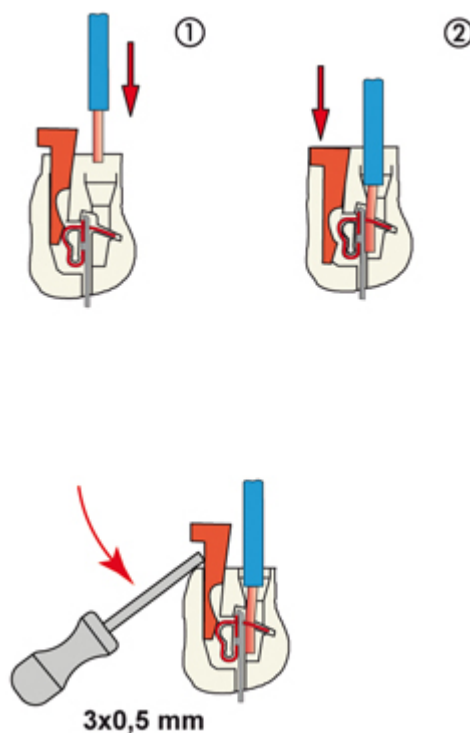

Reopening

---