

P31 - CPC - COUDE 90D  
P31 - CPC - FLAT BEND 90D

Référence(s) : **485373/74/75/76/77/78/79/80/81**  
Items(s) :



50 mm



50 -> 600 mm

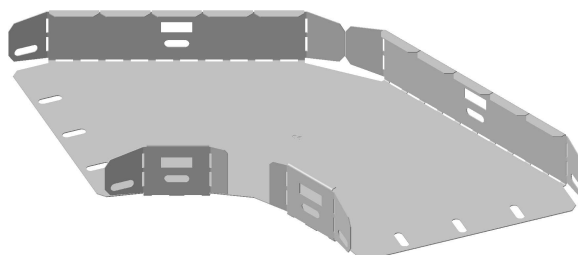

### 1. GAMME/RANGE

P31 - CPC COUDE 90D H50 Zn-Mg

P31 - CPC FLAT BEND 90D H50 Zn-Mg

Designation Description	Code	Poids Weight (Kg)	Épaisseur Thickness (mm)	Matière Raw Material	Norme matière Standard Raw Material	Finition Coating	Norme Finition Standard Coating	Section (mm <sup>2</sup> )
P31-CPC COUDE 90D 50X50 ZM P31-CPC FLAT BEND 90D 50X50 ZM	485374	218	0,8	DX51D+ZM310 A-C	EN 10346	Zn-Mg	EN 10346	2450
P31-CPC COUDE 90D 50X75 ZM P31-CPC FLAT BEND 90D 50X75 ZM	485375	286	0,8	DX51D+ZM310 A-C	EN 10346	Zn-Mg	EN 10346	3758
P31-CPC COUDE 90D 50X100 ZM P31-CPC FLAT BEND 90D 50X100 ZM	485376	351	0,8	DX51D+ZM310 A-C	EN 10346	Zn-Mg	EN 10346	4874
P31-CPC COUDE 90D 50X150 ZM P31-CPC FLAT BEND 90D 50X150 ZM	485377	504	0,8	DX51D+ZM310 A-C	EN 10346	Zn-Mg	EN 10346	7299
P31-CPC COUDE 90D 50X200 ZM P31-CPC FLAT BEND 90D 50X200 ZM	485378	682	0,8	DX51D+ZM310 A-C	EN 10346	Zn-Mg	EN 10346	9724
P31-CPC COUDE 90D 50X300 ZM P31-CPC FLAT BEND 90D 50X300 ZM	485379	1091	0,8	DX51D+ZM310 A-C	EN 10346	Zn-Mg	EN 10346	14573
P31-CPC COUDE 90D 50X400 ZM P31-CPC FLAT BEND 90D 50X400 ZM	485380	1606	0,8	DX51D+ZM310 A-C	EN 10346	Zn-Mg	EN 10346	19423
P31-CPC COUDE 90D 50X500 ZM P31-CPC FLAT BEND 90D 50X500 ZM	485381	2204	0,8	DX51D+ZM310 A-C	EN 10346	Zn-Mg	EN 10346	24270
P31-CPC COUDE 90D 50X600 ZM P31-CPC FLAT BEND 90D 50X600 ZM	485382	2872	0,8	DX51D+ZM310 A-C	EN 10346	Zn-Mg	EN 10346	29112

Classe de résistance contre la corrosion 8 (IEC 61537)  
Corrosion resistance classification 8 (IEC 61537)

**P31 - CPC - COUDE 90D**  
**P31 - CPC - FLAT BEND 90D**

 Reference(s) : **485373/74/75/76/77/78/79/80/81**  
 Items(s) :

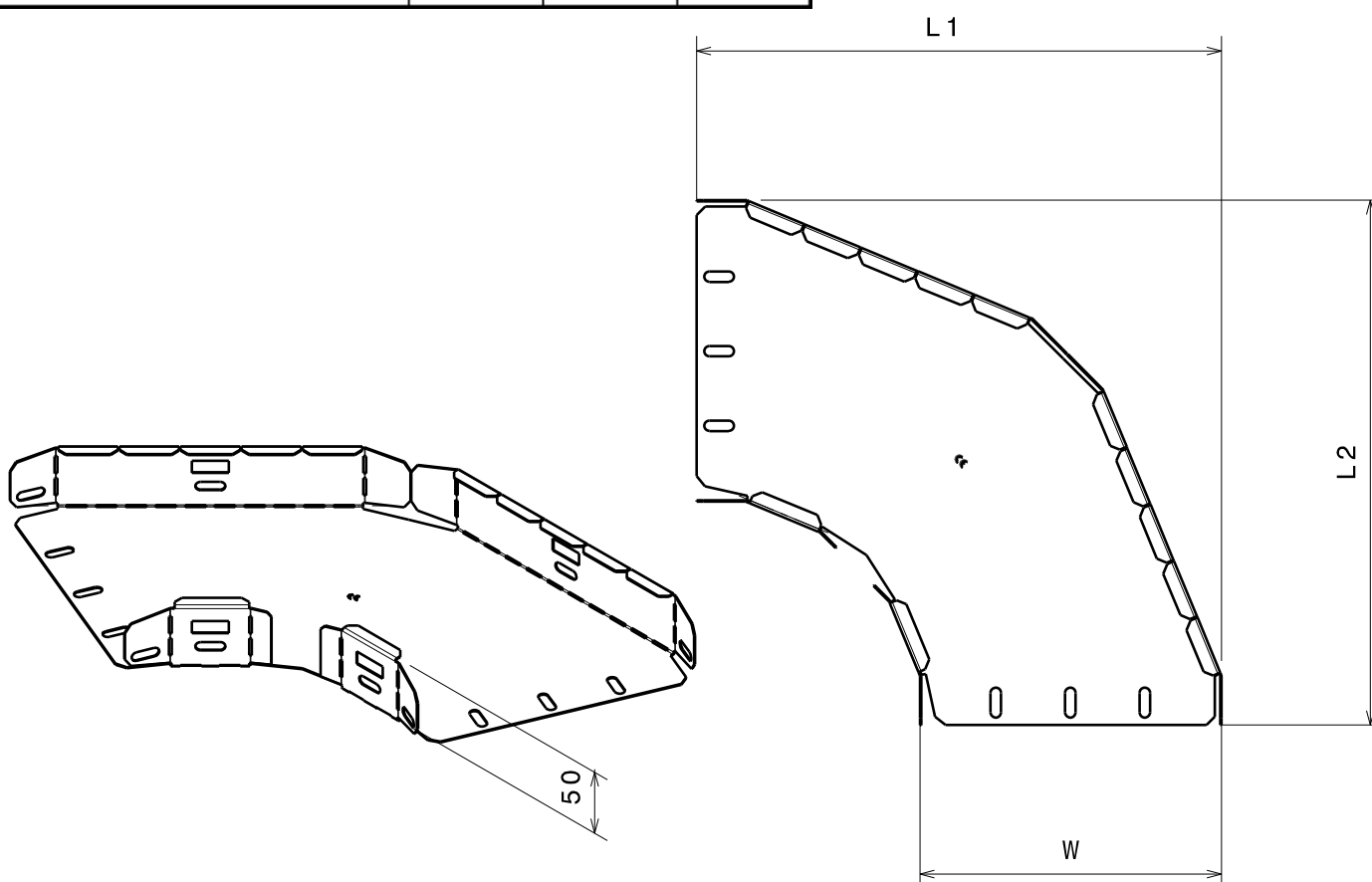

**2. DIMENSIONS(mm)**

Designation Description	Largeur Width ( W mm)	L1 (mm)	L2 (mm)
P31-CPC COUDE 90D 50X50 SLIDE-IN P31-CPC FLAT BEND 90D 50X50	52,1	202,1	202,1
P31-CPC COUDE 90D 50X75 SLIDE-IN P31-CPC FLAT BEND 90D 50X75	79,1	229,1	229,1
P31-CPC COUDE 90D 50X100 SLIDE-IN P31-CPC FLAT BEND 90D 50X100	102,1	252,1	252,1
P31-CPC COUDE 90D 50X150 SLIDE-IN P31-CPC FLAT BEND 90D 50X150	152,1	302,1	302,1
P31-CPC COUDE 90D 50X200 SLIDE-IN P31-CPC FLAT BEND 90D 50X200	202,1	352,1	352,1
P31-CPC COUDE 90D 50X300 SLIDE-IN P31-CPC FLAT BEND 90D 50X300	302,1	452,1	452,1
P31-CPC COUDE 90D 50X400 SLIDE-IN P31-CPC FLAT BEND 90D 50X400	402,1	552,1	552,1
P31-CPC COUDE 90D 50X500 SLIDE-IN P31-CPC FLAT BEND 90D 50X500	502,1	652,1	652,1
P31-CPC COUDE 90D 50X600 SLIDE-IN P31-CPC FLAT BEND 90D 50X600	602,1	752,1	752,1



P31 - CPC - COUDE 90D  
P31 - CPC - FLAT BEND 90D

Reference(s) : **485373/74/75/76/77/78/79/80/81**  
Items(s) :

	M6		11 Nm
	M6		

Reference(s): 341895 (PG)  
Item(s): 346895 (AISI 316L)

	50 -> 600 mm
--	--------------

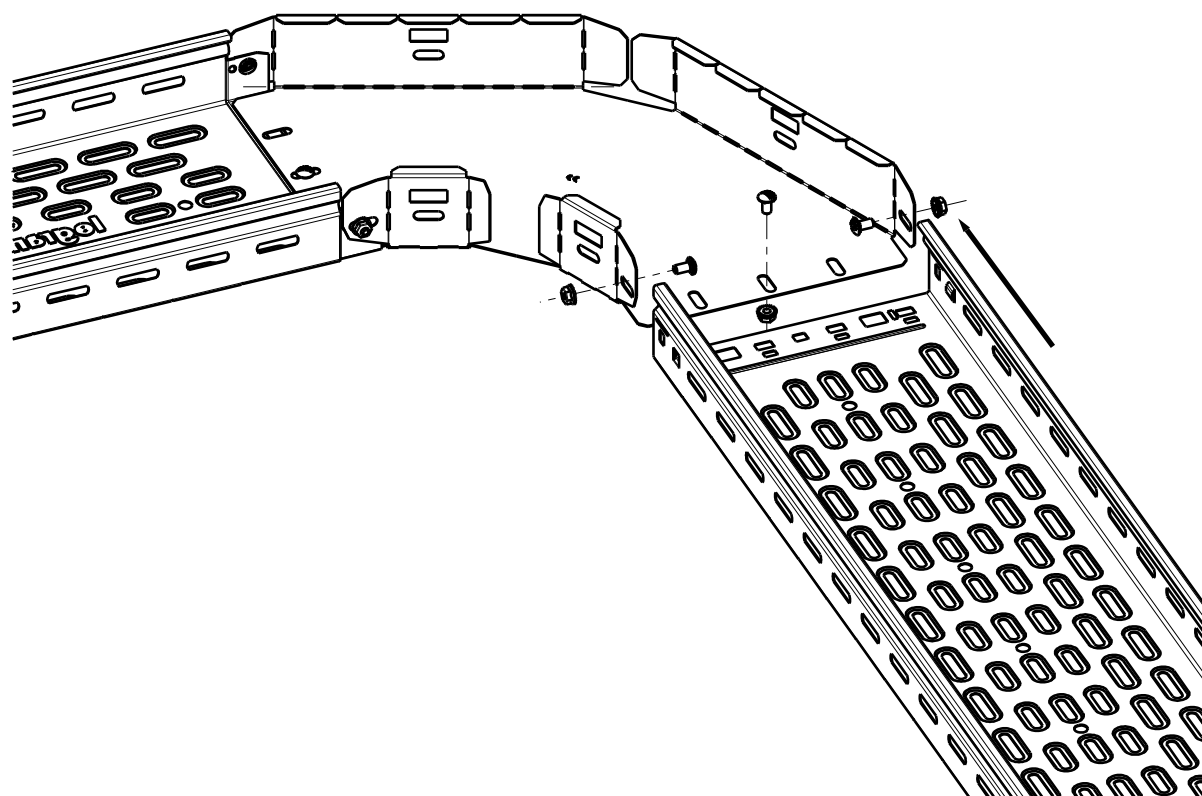

**P31 - CPC COUDE FLEX.IR/OR 90D**  
**P31 - CPC FLEXIBLE FB IR/OR 90D**

 Référence(s) : **485234/35/36/37/38/39/40/41/42**  
 Items(s) :

50 mm

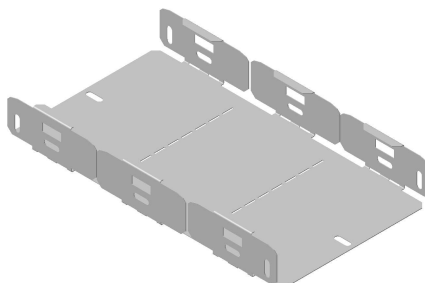

50 -&gt; 600 mm

**1. GAMME/RANGE**
**P31 - CPC DERIVATION H60 ZM**  
**P31 - CPC BRANCH H60 ZM**

Designation Description	Code	Poids Weight (Kg)	Épaisseur Thickness (mm)	Matière Raw Material	Norme matière Standard Raw Material	Finition Coating	Norme Finition Standard Coating	Section (mm <sup>2</sup> )
P31-CPC DERIVATION 60X75 ZM P31-CPC BRANCH 60X75 ZM	485415	2,8	0,8	DX51D+ZM310 A-C	EN 10346	Zn+Mg	EN 10346	4539
P31-CPC DERIVATION 60X100 ZM P31-CPC BRANCH 60X100 ZM	485416	3,0	0,8	DX51D+ZM310 A-C	EN 10346	Zn+Mg	EN 10346	6469
P31-CPC DERIVATION 60X150 ZM P31-CPC BRANCH 60X150 ZM	485417	3,6	0,8	DX51D+ZM310 A-C	EN 10346	Zn+Mg	EN 10346	8809
P31-CPC DERIVATION 60X200 ZM P31-CPC BRANCH 60X200 ZM	485418	4,2	0,8	DX51D+ZM310 A-C	EN 10346	Zn+Mg	EN 10346	11781
P31-CPC DERIVATION 60X300 ZM P31-CPC BRANCH 60X300 ZM	485419	5,3	0,8	DX51D+ZM310 A-C	EN 10346	Zn+Mg	EN 10346	17584
P31-CPC DERIVATION 60X400 ZM P31-CPC BRANCH 60X400 ZM	485420	6,5	0,8	DX51D+ZM310 A-C	EN 10346	Zn+Mg	EN 10346	23435
P31-CPC DERIVATION 60X500 ZM P31-CPC BRANCH 60X500 ZM	485421	7,7	0,8	DX51D+ZM310 A-C	EN 10346	Zn+Mg	EN 10346	29285
P31-CPC DERIVATION 60X600 ZM P31-CPC BRANCH 60X600 ZM	485422	8,8	0,8	DX51D+ZM310 A-C	EN 10346	Zn+Mg	EN 10346	35135

 Classe de résistance contre la corrosion 3 (IEC 61537)  
 Corrosion resistance classification 3 (IEC 61537)

Designation Description	Largeur Width (W mm)	L1 (mm)

**P31 - CPC COUDE FLEX.IR/OR 90D**  
**P31 - CPC FLEXIBLE FB IR/OR 90D**

 Référence(s) : **485234/35/36/37/38/39/40/41/42**  
 Items(s) :

**2. DIMENSIONS (mm)**

Designation Description	Largeur Width ( W mm)
P31-CPC COUDE FLEX IR/OR 90D 50X75 ZM <i>P31-CPC FLEXIBLE IR/OR 90D 50X75 ZM</i>	54,4
P31-CPC COUDE FLEX IR/OR 90D 50X75 ZM <i>P31-CPC FLEXIBLE IR/OR 90D 50X75 ZM</i>	81,4
P31-CPC COUDE FLEX IR/OR 90D 50X100 ZM <i>P31-CPC FLEXIBLE IR/OR 90D 50X100 ZM</i>	104,4
P31-CPC COUDE FLEX IR/OR 90D 50X150 ZM <i>P31-CPC FLEXIBLE IR/OR 90D 50X150 ZM</i>	154,4
P31-CPC COUDE FLEX IR/OR 90D 50X200 ZM <i>P31-CPC FLEXIBLE IR/OR 90D 50X200 ZM</i>	204,4
P31-CPC COUDE FLEX IR/OR 90D 50X300 ZM <i>P31-CPC FLEXIBLE IR/OR 90D 50X300 ZM</i>	304,4
P31-CPC COUDE FLEX IR/OR 90D 50X400 ZM <i>P31-CPC FLEXIBLE IR/OR 90D 50X400 ZM</i>	404,4
P31-CPC COUDE FLEX IR/OR 90D 50X500 ZM <i>P31-CPC FLEXIBLE IR/OR 90D 50X500 ZM</i>	504,4
P31-CPC COUDE FLEX IR/OR 90D 50X600 ZM <i>P31-CPC FLEXIBLE IR/OR 90D 50X600 ZM</i>	604,4

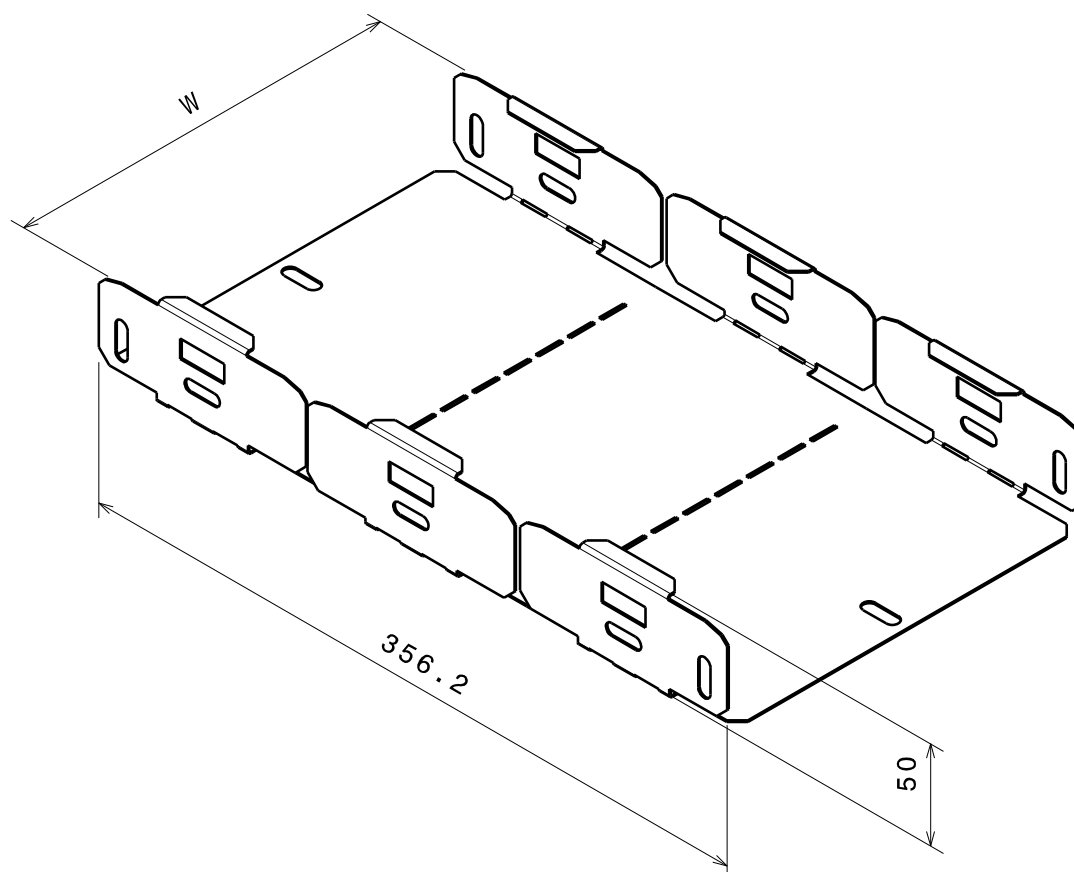

P31 - CPC COUDE FLEX.IR/OR 90D  
P31 - CPC FLEXIBLE FB IR/OR 90D

Référence(s) : 485234/35/36/37/38/39/40/41/42  
Items(s) :

	M6		11 Nm
	M6		

Référence(s) : 341895 (PG)  
Item(s) : 346895 (AISI 316L)

50 -> 600 mm

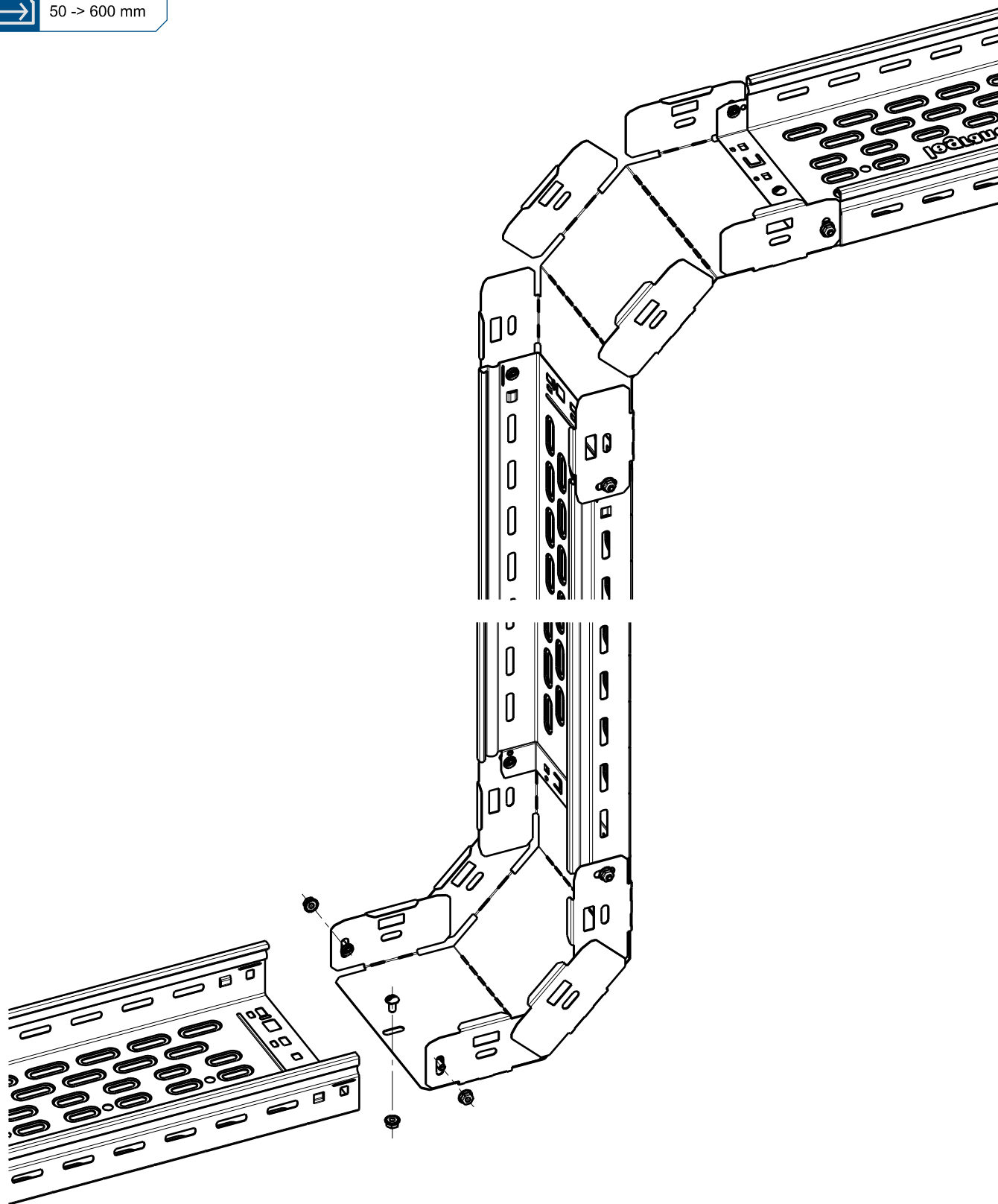

P31 - CPC - DERIVATION  
P31 - CPC - BRANCH

Référence(s) : **485382/83/84/85/86/87/88/89/90**  
Items(s) :



50 mm



50 -> 600 mm

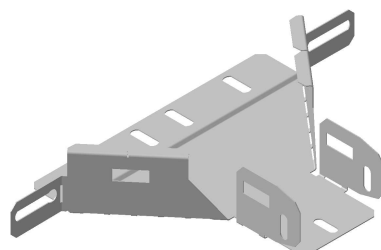

### 1. GAMME/RANGE

P31 - CPC DERIVATION H60 Zn-Mg  
P31 - CPC BRANCH H60 Zn-Mg

Designation Description	Code	Poids Weight (Kg)	Épaisseur Thickness (mm)	Matière Raw Material	Norme matière Standard Raw Material	Finition Coating	Norme Finition Standard Coating	Section (mm <sup>2</sup> )
P31-CPC DERIVATION 50X50 ZM P31-CPC BRANCH 50X50 ZM	485382	2,3	0,8	DX51D+ZM310 A-C	EN 10346	Zn-Mg	EN 10346	2450
P31-CPC DERIVATION 50X75 ZM P31-CPC BRANCH 50X75 ZM	485383	2,6	0,8	DX51D+ZM310 A-C	EN 10346	Zn-Mg	EN 10346	3758
P31-CPC DERIVATION 50X100 ZM P31-CPC BRANCH 50X100 ZM	485384	2,8	0,8	DX51D+ZM310 A-C	EN 10346	Zn-Mg	EN 10346	4874
P31-CPC DERIVATION 50X150 ZM P31-CPC BRANCH 50X150 ZM	485385	3,4	0,8	DX51D+ZM310 A-C	EN 10346	Zn-Mg	EN 10346	7299
P31-CPC DERIVATION 50X200 ZM P31-CPC BRANCH 50X200 ZM	485386	4,0	0,8	DX51D+ZM310 A-C	EN 10346	Zn-Mg	EN 10346	9724
P31-CPC DERIVATION 50X300 ZM P31-CPC BRANCH 50X300 ZM	485387	5,1	0,8	DX51D+ZM310 A-C	EN 10346	Zn-Mg	EN 10346	14573
P31-CPC DERIVATION 50X400 ZM P31-CPC BRANCH 50X400 ZM	485388	6,3	0,8	DX51D+ZM310 A-C	EN 10346	Zn-Mg	EN 10346	19423
P31-CPC DERIVATION 50X500 ZM P31-CPC BRANCH 50X500 ZM	485389	7,4	0,8	DX51D+ZM310 A-C	EN 10346	Zn-Mg	EN 10346	24270
P31-CPC DERIVATION 50X600 ZM P31-CPC BRANCH 50X600 ZM	485390	8,6	0,8	DX51D+ZM310 A-C	EN 10346	Zn-Mg	EN 10346	29112

Classe de résistance contre la corrosion 8 (IEC 61537)  
Corrosion resistance classification 8 (IEC 61537)



**P31 - CPC - DERIVATION**  
**P31 - CPC - BRANCH**

Référence(s) : **485382/83/84/85/86/87/88/89/90**  
Items(s) :

**2. DIMENSIONS (mm)**

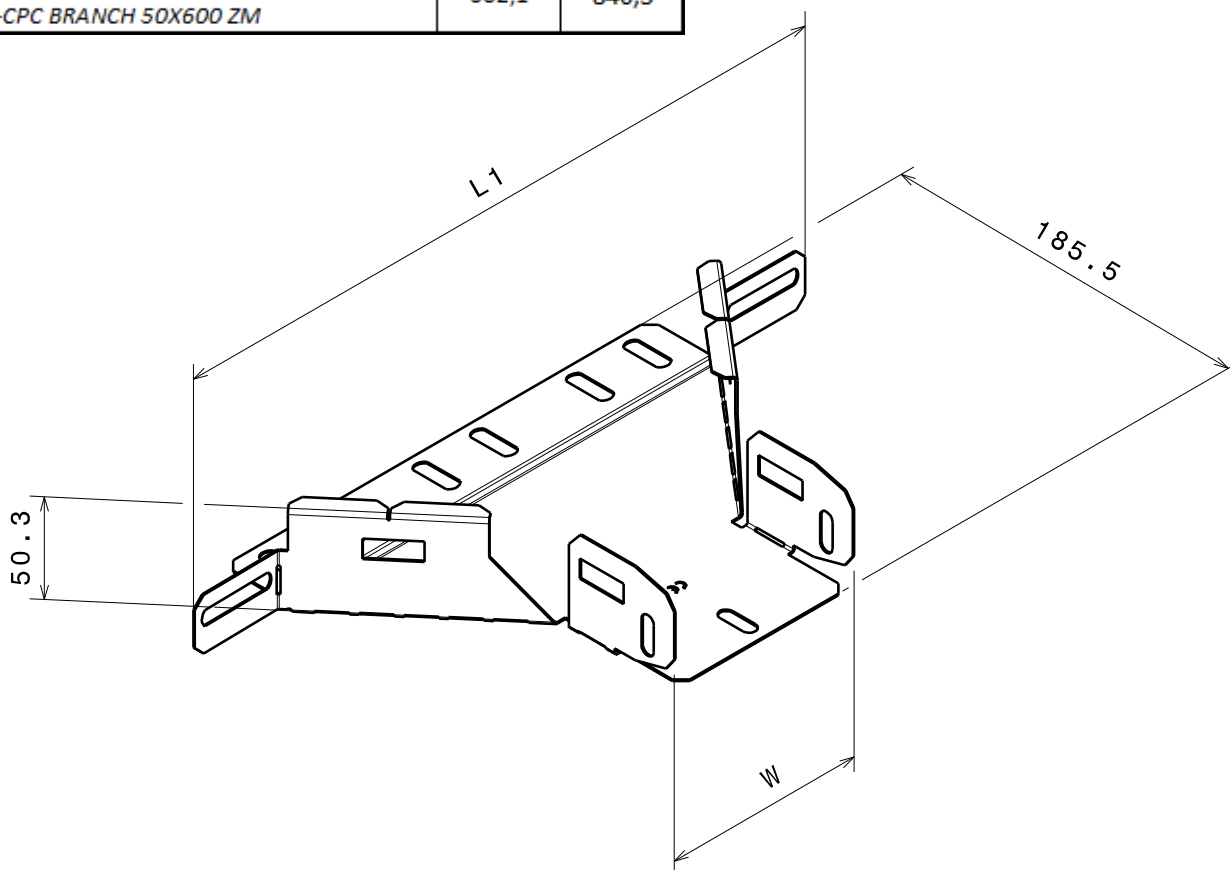

Designation Description	Largeur Width ( W mm)	L1 (mm)
P31-CPC DERIVATION 50X50 ZM P31-CPC BRANCH 50X50 ZM	52,1	296,5
P31-CPC DERIVATION 50X75 ZM P31-CPC BRANCH 50X75 ZM	79,1	323,5
P31-CPC DERIVATION 50X100 ZM P31-CPC BRANCH 50X100 ZM	102,1	346,5
P31-CPC DERIVATION 50X150 ZM P31-CPC BRANCH 50X150 ZM	152,1	396,5
P31-CPC DERIVATION 50X200 ZM P31-CPC BRANCH 50X200 ZM	202,1	446,5
P31-CPC DERIVATION 50X300 ZM P31-CPC BRANCH 50X300 ZM	302,1	546,5
P31-CPC DERIVATION 50X400 ZM P31-CPC BRANCH 50X400 ZM	402,1	646,5
P31-CPC DERIVATION 50X500 ZM P31-CPC BRANCH 50X500 ZM	502,1	746,5
P31-CPC DERIVATION 50X600 ZM P31-CPC BRANCH 50X600 ZM	602,1	846,5





P31 - CPC - DERIVATION  
P31 - CPC - BRANCH

Référence(s) : **485382/83/84/85/86/87/88/89/90**  
Item(s) :

	M6		11 Nm
	M6		

Référence(s) : 341895 (PG)  
Item(s) : 346895 (AISI 316L)

	50 -> 600 mm
--	--------------

