

|   |          |    |      |  |
|---|----------|----|------|--|
| Product designation                                       |          |    |      | Rotary cam switches                        |
| Product type designation                                  |          |    |      | GF10                                       |
| <b>General characteristics</b>                            |          |    |      |  |
| Switching diagram   |          |    |      | 136 - Multi-step<br>0-1-2-3 3 poles        |
| N° of elements  |          |    |      | 5  |
| Mounting form   |          |    |      | U - Front<br>mounting with<br>black handle |
| <b>Contact characteristics</b>                            |          |    |      |  |
| Rated insulation voltage $U_i$                            | IEC/EN   | V  | 480  |  |
|   | UL/CSA   | V  | 240  |  |
| Rated impulse withstand voltage $U_{imp}$                 |          | kV | 4    |  |
| Conventional free air thermal current $I_{th}$            | IEC/EN   | A  | 10   |  |
|   | UL/CSA   | A  | 10   |  |
| Rated operational voltage                                 |          | V  | 480  |  |
| Rated operational impulse voltage                         |          | kV | 4    |  |
| Maximum fuse size for short-circuit protection $I_n$ (gG) | 10kA     | A  | 16   |  |
| Rated short time current $I_{cw}$                         | 1s       | A  | 250  |  |
| Conductivity  |          |    |      | 10/5 mA/V                                  |
| Operational current $I_e$ IEC/EN                          |          |    |      |  |
| AC1/AC21A   |          | A  | 10   |  |
| AC15  | 110V     | A  | 5    |  |
|   | 220/230V | A  | 3    |  |
|   | 380/400V | A  | 2    |  |
| Rated operational power in AC                             |          |    |      |  |
| Three-phase AC-3  | 220/230V | kW | 1.5  |  |
|   | 380/440V | kW | 2.2  |  |
| Single-phase AC-3   | 110V     | kW | 0.3  |  |
|   | 220/230V | kW | 0.55 |  |
|   | 380/440V | kW | 0.75 |  |
| Three-phase AC23A   | 220/230V | kW | 1.8  |  |
|   | 380/440V | kW | 3    |  |
| Single-phase AC23A  | 110V     | kW | 0.7  |  |
|   | 220/230V | kW | 0.75 |  |
|   | 380/440V | kW | 1.1  |  |
| Rated operational current in DC                           |          |    |      |  |
| DC21A   | 48V      | A  | 10   |  |
|   | 60V      | A  | 7    |  |
|   | 110V     | A  | 2    |  |
|   | 220V     | A  | 0.7  |  |

|  |      |                 |                   |
|--|------|-----------------|-------------------|
|  | 440V | A               | 0.2               |
| DC13                                   | 24V  | A               | 3                 |
|  | 48V  | A               | 3                 |
|  | 60V  | A               | 2                 |
|  | 110V | A               | 1                 |
|  | 220V | A               | 0.3               |
|  | 440V | A               | 0.1               |
| Power dissipation                      |      | W               | 0.4               |
| <b>Mechanical features</b>             |      |                 |                   |
| Terminals screw                        |      |                 | 2.5M              |
| Tightening torque for terminals max    |      | Nm              | 0.4               |
| Conductor size                         |      |                 |                   |
| AWG - Rigid cable                      | min  | AWG             | 20                |
|  | Max  | AWG             | 14                |
| AWG - Flexible cable                   | min  | AWG             | 20                |
|  | Max  | AWG             | 14                |
| Conductor size (IEC) - Flexible cable  | min  | mm <sup>2</sup> | 0.5               |
|  | Max  | mm <sup>2</sup> | 1.5               |
| Conductor size (IEC) - Rigid cable     | min  | mm <sup>2</sup> | 0.5               |
|  | Max  | mm <sup>2</sup> | 1.5               |
| Mechanical life                        |      | cycles          | 1x10 <sup>6</sup> |
| <b>UL technical data</b>               |      |                 |                   |
| Motor power for direct-on-line control |      |                 |                   |
| for three-phase motor                  | 240V | HP              | 2                 |
| for single-phase motor                 | 240V | HP              | 0.75              |
| <b>Ambient conditions</b>              |      |                 |                   |
| Temperature                            |      |                 |                   |
| Operating temperature                  | min  | °C              | -25               |
|  | max  | °C              | +55               |
| Storage temperature                    | min  | °C              | -40               |
|  | max  | °C              | +70               |
| <b>Resistance &amp; Protection</b>     |      |                 |                   |
| Frontal IP degree                      |      |                 | IP40              |
| Terminals IP degree                    |      |                 | IP20              |
| <b>Dimensions</b>                      |      |                 |                   |

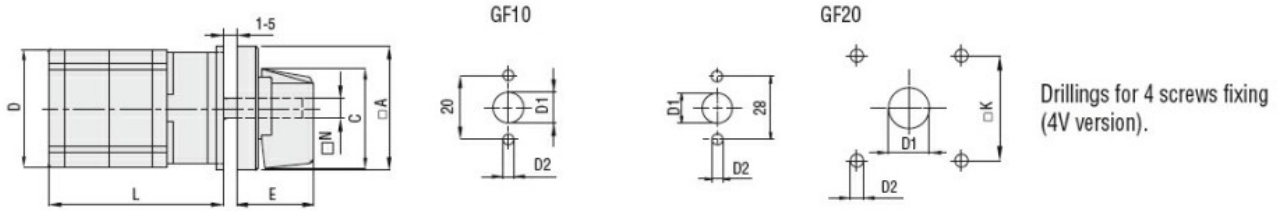

| Series | Dimensions |      |    |     |     |      |    |    | L Number of elements |      |    |      |    |       |     |       |     |       |     |       |
|--------|------------|------|----|-----|-----|------|----|----|----------------------|------|----|------|----|-------|-----|-------|-----|-------|-----|-------|
|        | □A         | C    | D  | ∅D1 | ∅D2 | E    | □K | N  | 1                    | 2    | 3  | 4    | 5  | 6     | 7   | 8     | 9   | 10    | 11  | 12    |
| GF10   | 30         | 24   | 29 | 9   | 3.2 | 18.5 | -  | ∅5 | 40                   | 52   | 64 | 76   | 88 | 100   | 112 | 124   | -   | -     | -   | -     |
| GF20   | 48         | 39.5 | 36 | 12  | 5   | 26.5 | 36 | □6 | 44                   | 57.5 | 71 | 84.5 | 98 | 111.5 | 125 | 138.5 | 152 | 165.5 | 179 | 192.5 |

**Wiring diagrams**

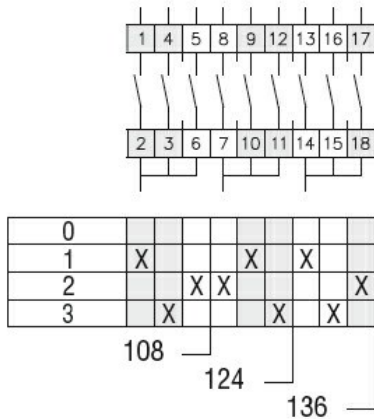

**Certifications and compliance**

**Compliance**

- CSA C22.2 n° 14
- IEC/EN/BS 60947-1
- IEC/EN/BS 60947-3
- IEC/EN/BS 60947-5-1
- UL60947-4-1

**Certificates**

- cULus
- EAC

**ETIM classification**

ETIM 8.0

EC001029 -  
Selector switch,  
complete