

Part number

CZCW 15 L



Cover, W-TYPE series, with 2 pegs, size "49.16", with eyelet

Product description

Product type	Cover
Series	W-TYPE
Closing type	With 2 pegs
Size	Size 49.16
Specification	With eyelet

Technical data

IP degree of protection	IP65
--------------------------------	------

Further technical details

Weight	27,70 g
Operating temperature range (min, max)	-40°C...+125°C

Material properties

Main material	Aluminium die-cast
Other materials	Gasket: FKM
Colour	RAL 9005 black
RoHs conformity	Compliant
China RoHs - EFUP	E
REACH SVHC substances	No

Approvals / Standards

Certifications	DNV, BV
UL	ECBT2
cUL	ECBT8

General ordering information

EAN13 code	8015747043939
eCl@ss 8.1	27440208
ETIM 7.0	EC002314

Packaging Information

Sub-packaging length	118,00 mm
Sub-packaging height	32,00 mm
Sub-packaging width	76,00 mm
Sub-packaging weight	0,14 kg
Sub-packaging volume	0,29 dm ³
Sub-packaging description	Carton tray
Sub-packaging quantity	5 Pcs
Sub-packaging EAN barcode	8015747043946

Part number

CZCW 15 L



Catalogue drawings

CZIWL

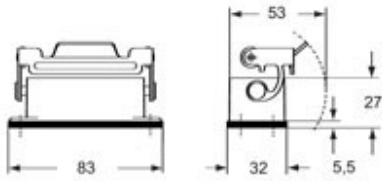

CZPW L MZPW L

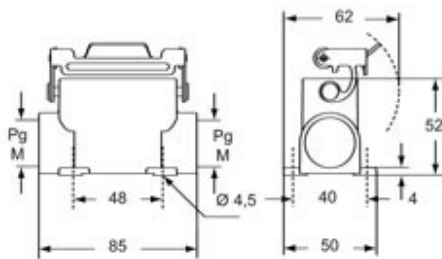

CZCW L



Notes

Cannot be used together with metal coding pins.

Dimensions shown in mm are not binding and may be changed without notice.
