

|   |          |    |      |  |
|---|----------|----|------|--|
| Product designation                                       |          |    |      | Rotary cam switches  |
| Product type designation                                  |          |    |      | GF20   |
| <b>General characteristics</b>                            |          |    |      |  |
| Switching diagram   |          |    |      | 26 - 3-phase motor reversing switch with spring return                             |
| N° of elements  |          |    |      | 3  |
| Mounting form   |          |    |      | U25 - Front mounting with red/yellow handle padlockable in 0 and protection covers |
| <b>Contact characteristics</b>                            |          |    |      |  |
| Rated insulation voltage $U_i$                            | IEC/EN   | V  | 480  |  |
|   | UL/CSA   | V  | 240  |  |
| Rated impulse withstand voltage $U_{imp}$                 |          | kV | 4    |  |
| Conventional free air thermal current $I_{th}$            | IEC/EN   | A  | 20   |  |
|   | UL/CSA   | A  | 15   |  |
| Rated operational voltage                                 |          | V  | 480  |  |
| Rated operational impulse voltage                         |          | kV | 4    |  |
| Maximum fuse size for short-circuit protection $I_n$ (gG) | 10kA     | A  | 20   |  |
|   | 15kA     | A  | 20   |  |
|   | 25kA     | A  | 20   |  |
| Rated short time current $I_{cw}$                         | 1s       | A  | 250  |  |
| Conductivity  |          |    |      | 10/5 mA/V  |
| Operational current $I_e$ IEC/EN                          |          |    |      |  |
| AC1/AC21A   |          | A  | 20   |  |
| AC15  | 110V     | A  | 10   |  |
|   | 220/230V | A  | 8    |  |
|   | 380/400V | A  | 6    |  |
| Rated operational power in AC                             |          |    |      |  |
| Three-phase AC-3  | 220/230V | kW | 3    |  |
|   | 380/440V | kW | 5    |  |
| Single-phase AC-3   | 110V     | kW | 0.5  |  |
|   | 220/230V | kW | 1.5  |  |
|   | 380/440V | kW | 2    |  |
| Three-phase AC23A   | 220/230V | kW | 4    |  |
|   | 380/440V | kW | 7.5  |  |
| Single-phase AC23A  | 110V     | kW | 0.75 |  |
|   | 220/230V | kW | 2    |  |
|   | 380/440V | kW | 2.5  |  |

|  |      |                 |                   |
|--|------|-----------------|-------------------|
| Rated operational current in DC        |      |                 |                   |
| DC21A                                  |      |                 |                   |
|  | 48V  | A               | 20                |
|  | 60V  | A               | 20                |
|  | 110V | A               | 4                 |
|  | 220V | A               | 0.7               |
|  | 440V | A               | 0.2               |
| DC13                                   |      |                 |                   |
|  | 24V  | A               | 6                 |
|  | 48V  | A               | 6                 |
|  | 60V  | A               | 3                 |
|  | 110V | A               | 1                 |
|  | 220V | A               | 0.4               |
|  | 440V | A               | 0.15              |
| Power dissipation                      |      | W               | 0.8               |
| <b>Mechanical features</b>             |      |                 |                   |
| Terminals screw                        |      |                 | M3                |
| Tightening torque for terminals max    |      | Nm              | 0.5               |
| Conductor size                         |      |                 |                   |
| AWG - Rigid cable                      |      |                 |                   |
|  | min  | AWG             | 20                |
|  | Max  | AWG             | 12                |
| AWG - Flexible cable                   |      |                 |                   |
|  | min  | AWG             | 20                |
|  | Max  | AWG             | 12                |
| Conductor size (IEC) - Flexible cable  |      |                 |                   |
|  | min  | mm <sup>2</sup> | 0.5               |
|  | Max  | mm <sup>2</sup> | 2.5               |
| Conductor size (IEC) - Rigid cable     |      |                 |                   |
|  | min  | mm <sup>2</sup> | 0.5               |
|  | Max  | mm <sup>2</sup> | 2.5               |
| Mechanical life                        |      | cycles          | 1x10 <sup>6</sup> |
| <b>UL technical data</b>               |      |                 |                   |
| Motor power for direct-on-line control |      |                 |                   |
| for three-phase motor                  |      |                 |                   |
|  | 240V | HP              | 3                 |
| for single-phase motor                 |      |                 |                   |
|  | 240V | HP              | 1                 |
| <b>Ambient conditions</b>              |      |                 |                   |
| Temperature                            |      |                 |                   |
| Operating temperature                  |      |                 |                   |
|  | min  | °C              | -25               |
|  | max  | °C              | +55               |
| Storage temperature                    |      |                 |                   |
|  | min  | °C              | -40               |
|  | max  | °C              | +70               |
| <b>Resistance &amp; Protection</b>     |      |                 |                   |
| Frontal IP degree                      |      |                 | IP40              |
| Terminals IP degree                    |      |                 | IP20              |
| <b>Dimensions</b>                      |      |                 |                   |

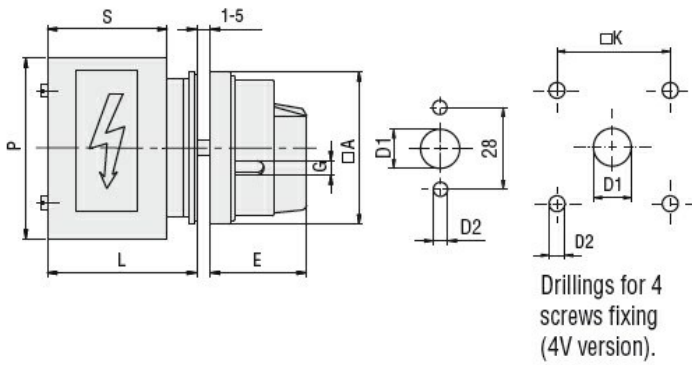

| Series      | Dimensions |    |    |      |   |    | L  |      |        |       |
|-------------|------------|----|----|------|---|----|----|------|--------|-------|
|             | □A         | D1 | D2 | E    | G | □K | 1  | 2    | 3...12 |       |
| <b>GF20</b> | 48         | 12 | 5  | 34.2 | 5 | 36 | 44 | 57.5 | 71     | 192.5 |

**Wiring diagrams**

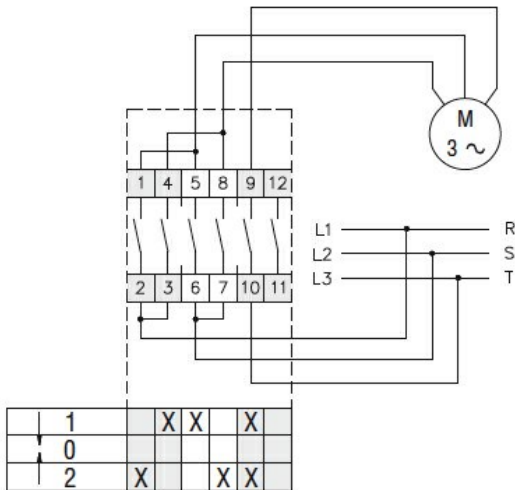

**Certifications and compliance**

**Compliance**

CSA C22.2 n° 14  
IEC/EN/BS 60947-1  
IEC/EN/BS 60947-3  
IEC/EN/BS 60947-5-1  
UL60947-4-1

**Certificates**

cULus  
EAC

**ETIM classification**

ETIM 8.0

EC001029 -  
Selector switch,  
complete