

THIS COPY IS PROVIDED ON A RESTRICTED BASIS AND IS NOT TO BE USED IN ANY WAY DETRIMENTAL TO THE INTERESTS OF PANDUIT CORP.

PANDUIT P/N	WEIGHT
WMPVCMB	.23 LB/EACH 104 g/EACH

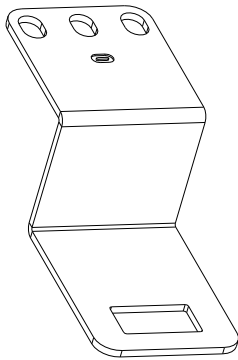
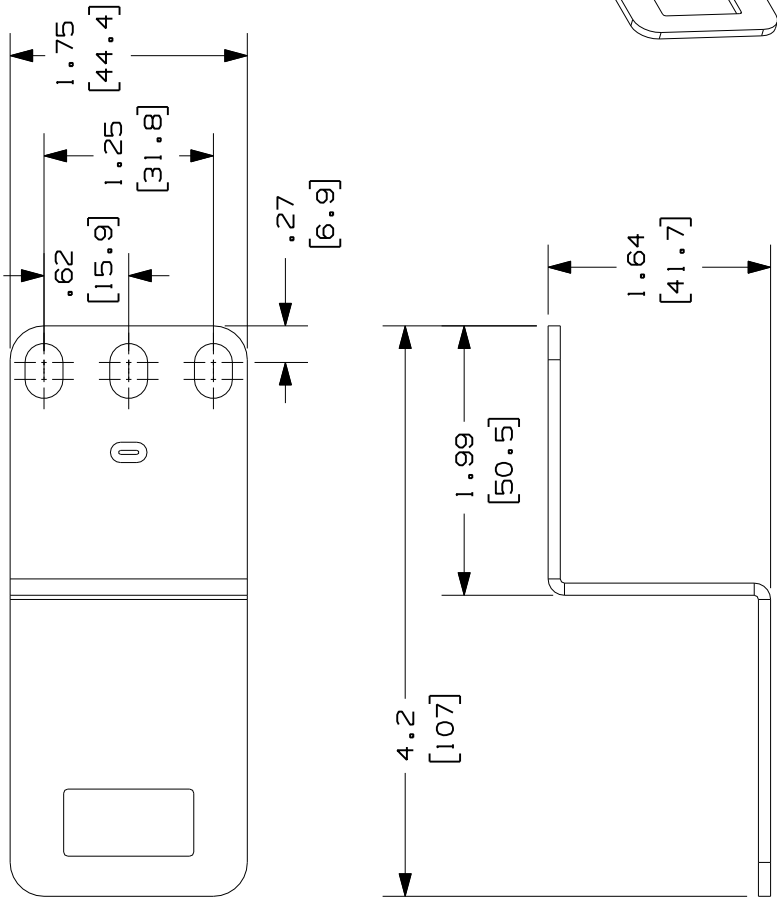

- NOTES:
- VISIT OUR ON-LINE CATALOG AT WWW.PANDUIT.COM FOR A CURRENT LIST OF PRODUCTS APPLICABLE FOR USE WITH THIS PART.
 - COMPONENTS:
 - 4 - BRACKETS
 - 8 - #12-24 X 1/2" SCREWS
 - 8 - #10-32 X 1/2" SCREWS
 - 8 - M6 X 15mm SCREWS
 - DIMENSIONS IN PARENTHESIS ARE METRIC.
 - THE CENTER BRACKET KIT ALLOWS THE USER TO FULLY SECURE NETRUNNER BETWEEN TWO RACKS.

MODEL FILENAME		V10475BA_WMPVCMB_01.PRT	
CAD FILENAME/LAYERS		V10475BA_DC_01A.PRT	
PANDUIT			
NETRUNNER CANADIAN RACK MOUNTING BRACKET (WMPVCMB) CUSTOMER DRAWING			
UNLESS OTHERWISE SPECIFIED, DIMENSIONAL TOLERANCES ARE: (.X) ± .03 ANGLES ± 1° (.XX) ± .015		UNLESS OTHERWISE SPECIFIED, ALL DIMENSIONS ARE GIVEN IN INCHES, THIRD ANGLE PROJECTION.	
DRAWN BY	NAGL	MAT'L	NONE
DATE	01-23-07		
CHK'D			
REV	DATE	BY	CHK
00	01-23-07	NAGL	
			RELEASED TO PRODUCTION
			ECN - R
			CUST
			SUP
			OTH
			DESCRIPTION
			10475-02
			STEEL
			DWG
			DRAWING NO.
			10475-02
			SIZE
			A