

Panduit Latching Flat Cable Mounts

- Available in four sizes with a stack height of 0.17 inches (4.3mm) to accommodate different flat cable widths
- Low profile design holds wires, cables, and tubing
- Convenient releasable latch
- Large mounting base for high bonding strength
- For indoor use only
- Material: Nylon 6.6

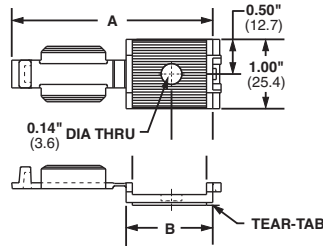

FCM1 and FCM1.2

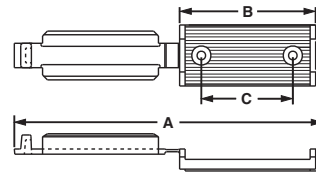

FCM2 and FCM3.25

Part Number	Cable Width		Length A		Width B		Hole Spacing C		Color	Mounting Method	Std. Pkg. Qty.	Std. Ctn. Qty.
	In.	mm	In.	mm	In.	mm	In.	mm				
Adhesive Backed												
FCM1-A-C14	1.05	26.7	2.90	73.7	1.05	26.7	—	—	Gray	Rubber Adhesive	100	500
FCM1.2-A-C14	1.20	30.5	3.16	80.3	1.37	34.8	—	—			100	1000
FCM2-A-C14	2.05	52.1	5.06	128.5	2.22	56.4	1.53	38.9	Gray	Rubber Adhesive	100	500
FCM3.25-A-L14	3.38	85.9	7.30	185.4	3.38	85.9	1.50	38.1			50	500

Screw Mounted												
FCM1-S6-C14	1.05	26.7	2.90	73.7	1.05	26.7	—	—	Gray	#6 (M3) Screw	100	1000
FCM1.2-S6-C14	1.20	30.5	3.16	80.3	1.37	34.8	—	—				
FCM2-S6-C14	2.05	52.1	5.06	128.5	2.22	56.4	1.53	38.9	Gray	#6 (M3) Screw	50	500
FCM3.25-S6-L14	3.38	85.9	7.30	185.4	3.38	85.9	1.50	38.1				

Panduit Latching Flat Cable Holders

- Low profile design holds wires, cables, and tubing
- Convenient releasable latch
- Large mounting base for high bonding strength
- For indoor use only
- See also Flat Cable Mounting System on Page B2.23
- Material: Nylon 6.6

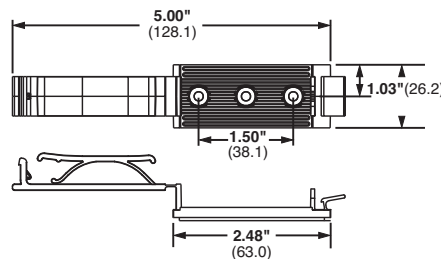

Part Number	Length		Cable Width		Color	Mounting Method	Std. Pkg. Qty.	Std. Ctn. Qty.
	In.	mm	In.	mm				
Adhesive Backed								
FCH2-A-C14	2.48	63.0	2.06	50.8	Gray	Rubber Adhesive	100	500
FCH2-S6-C14	2.48	63.0	2.06	50.8	Gray	#6 (M3) Screw		

See also Flat Cable Mounting System on Page B2.23.