

Part number

# JMPP 24.25



Surface mounting housing, JEI®-P series, with 2 levers, M25 cable entry, size 104.27

Product description		Material properties	
<b>Product type</b>	Surface mounting housing	<b>Other materials</b>	Lever: Polyamide (PA) Gasket: NBR
<b>Series</b>	JEI®-P	<b>Colour</b>	RAL 7040 grey
<b>Closing type</b>	With 2 levers	<b>Approvals / Standards</b>	
<b>Size</b>	Size 104.27	<b>Certifications</b>	DNV, BV
<b>Cable entry</b>	With cable entry M25	<b>UL</b>	ECBT2
Technical data		General ordering information	
<b>IP degree of protection</b>	IP65	<b>EAN13 code</b>	8015747100922
Further technical details		Packaging Information	
<b>Weight</b>	354,00 g	<b>Packaging length</b>	475,00 mm
<b>Operating temperature range (min, max)</b>	-40°C...+125°C	<b>Packaging height</b>	180,00 mm
		<b>Packaging width</b>	200,00 mm
		<b>Packaging weight</b>	3,86 kg
		<b>Packaging volume</b>	17,10 dm <sup>3</sup>
		<b>Packaging description</b>	Carton box
		<b>Packaging quantity</b>	10 Pcs
		<b>Packaging EAN code</b>	8015747250023
		<b>Sub-packaging weight</b>	1,93 kg
		<b>Sub-packaging description</b>	Plastic packaging
		<b>Sub-packaging quantity</b>	5 Pcs
		<b>Sub-packaging EAN barcode</b>	8015747100946

Part number

# JMPP 24.25



## Catalogue drawings

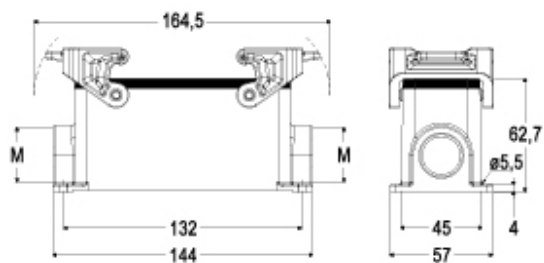

## Notes

Dimensions shown in mm are not binding and may be changed without notice.

---