

THIS COPY IS PROVIDED ON A RESTRICTED BASIS AND IS NOT TO BE USED IN ANY WAY DETRIMENTAL TO THE INTERESTS OF PANDUIT CORP.

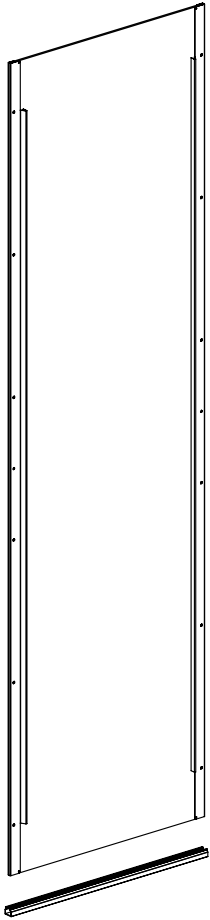

PANDUIT P/N	DESCRIPTION	COLOR	WEIGHT
CUFBPR4206HBB1	NET-CONTAIN UAC FULL BLANKING PANEL 42RU HIGH X 600mm WIDE	BLACK	4.45 Kg/EACH [9.8 LBS/EACH]
CUFBPR4206HBW1	NET-CONTAIN UAC FULL BLANKING PANEL 42RU HIGH X 600mm WIDE	WHITE	4.45 Kg/EACH [9.8 LBS/EACH]
CUFBPR4506HBB1	NET-CONTAIN UAC FULL BLANKING PANEL 45RU HIGH X 600mm WIDE	BLACK	4.81 Kg/EACH [10.6 LBS/EACH]
CUFBPR4506HBW1	NET-CONTAIN UAC FULL BLANKING PANEL 45RU HIGH X 600mm WIDE	WHITE	4.81 Kg/EACH [10.6 LBS/EACH]
CUFBPR4806HBB1	NET-CONTAIN UAC FULL BLANKING PANEL 48RU HIGH X 600mm WIDE	BLACK	5.17 Kg/EACH [11.4 LBS/EACH]
CUFBPR4806HBW1	NET-CONTAIN UAC FULL BLANKING PANEL 48RU HIGH X 600mm WIDE	WHITE	5.17 Kg/EACH [11.4 LBS/EACH]
CUFBPR5206HBB1	NET-CONTAIN UAC FULL BLANKING PANEL 52RU HIGH X 600mm WIDE	BLACK	5.58 Kg/EACH [12.3 LBS/EACH]
CUFBPR5206HBW1	NET-CONTAIN UAC FULL BLANKING PANEL 52RU HIGH X 600mm WIDE	WHITE	5.58 Kg/EACH [12.3 LBS/EACH]

- VISIT OUR ON-LINE CATALOG AT WWW.PANDUIT.COM FOR A LIST OF CURRENT PARTS APPLICABLE FOR USE WITH THIS PRODUCT.
- PARTS SUPPLIED:
 - 1- FULL HEIGHT BLANKING PANEL
 - 1- LOWER GUIDE
 - 1- INSTRUCTION SHEET
- PRIMARY DIMENSIONS ARE IN MILLIMETERS.

						TITLE (CUFBPR**06HB**) NET-CONTAIN UAC FULL BLANKING PANEL						
						CUSTOMER DRAWING						
						ITEM REVISION NAME 12V359SP/00		PANDUIT				
						DATASET FILE NAME 12V359SP_DC/00A						
								MATERIAL: N/A				
00A 5-29-14 PBS PATR SGI RELEASED TO PRODUCTION						12V359SP-DC		DRAWING NUMBER: 12V359SP-DC				
REV	DATE	BY	CHK	APR	DESCRIPTION	ECN	DRAWN BY PBS	DATE 5-29-14	CHK PATR	SCALE NONE	SHT 1 OF 2	SIZE A

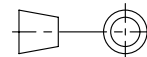

THIRD ANGLE PROJECTION

D10100DA/16

THIS COPY IS PROVIDED ON A RESTRICTED BASIS AND IS NOT TO BE USED IN ANY WAY DETRIMENTAL TO THE INTERESTS OF PANDUIT CORP.

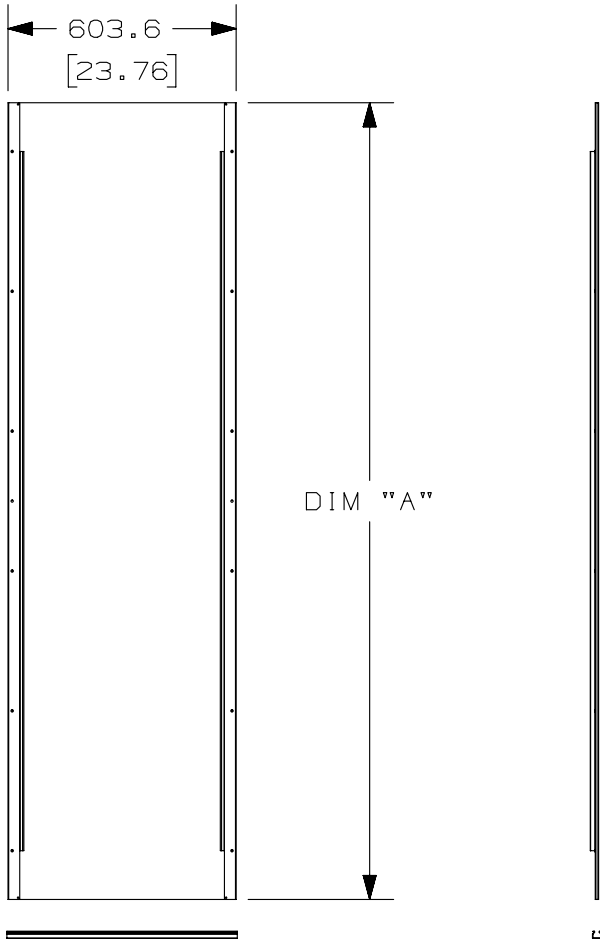

PANDUIT P/N	SIZE	DIM "A"
CUFBPR4206HB**	42RU	2108.0 [82.99]
CUFBPR4506HB**	45RU	2241.3 [88.24]
CUFBPR4806HB**	48RU	2374.6 [93.49]
CUFBPR5206HB**	52RU	2553.0 [100.51]

NOTE:
 ** DENOTES COLOR - ADD SUFFIX
 "B1" FOR BLACK AND "W1" FOR WHITE

REV	DATE	BY	CHK	APR	DESCRIPTION	ECN
00A	5-29-14	PBS	PATR	SGI	SEE SHEET 1 OF 2 FOR REVISIONS	12V359SP-DC

TITLE (CUFBPR**06HB**) NET-CONTAIN UAC FULL BLANKING PANEL			
CUSTOMER DRAWING			
ITEM REVISION NAME 12V359SP/00		PANDUIT	
DATASET FILE NAME 12V359SP_DC/00A			
DRAWING NUMBER: 12V359SP-DC		MATERIAL: N/A	
DRAWN BY PBS		DATE 5-29-14	
CHK PATR		SCALE NONE	
SHT 2 OF 2		SIZE A	

D10100DA/16