

Part number

TM 1125 CS



Box, TM series, for 1 TM interlocked socket outlet without base box

Product description	
Product type	Box
Series	TM
Size	114 x 255 mm fixing distance, for assembly in single or multiple boxes
Specification	For 1 TM interlocked socket outlet without base box
Technical data	
IP degree of protection	IP66 / IP67
Further technical details	
Weight	330,00 g
Operating temperature range (min, max)	-25°C ... +40°C
IK rating (impact degree of protection)	IK10

Material properties	
Colour	RAL 7012 grey
RoHs conformity	Compliant with exemption 6(c): copper alloy containing up to 4% lead by weight
China RoHs - EFUP	50
REACH SVHC substances	Yes Lead
SCIP number	B0214dad-d2d9-4e91-a5b4-f4c9b4612083
General ordering information	
EAN13 code	8015747089265
Packaging Information	
Packaging weight	3,30 kg
Packaging volume	16,91 dm ³
Packaging description	Carton box
Packaging quantity	10 Pcs
Packaging EAN code	8015747089272
Sub-packaging weight	0,33 kg
Sub-packaging description	Plastic packaging
Sub-packaging quantity	1 Pcs
Sub-packaging EAN barcode	8015747089289

Part number

TM 1125 CS



Catalogue drawings

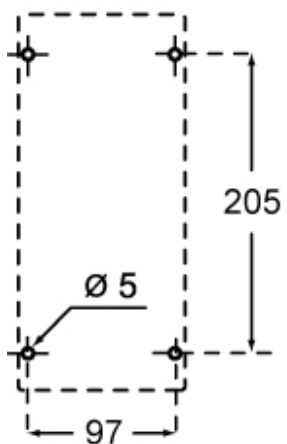
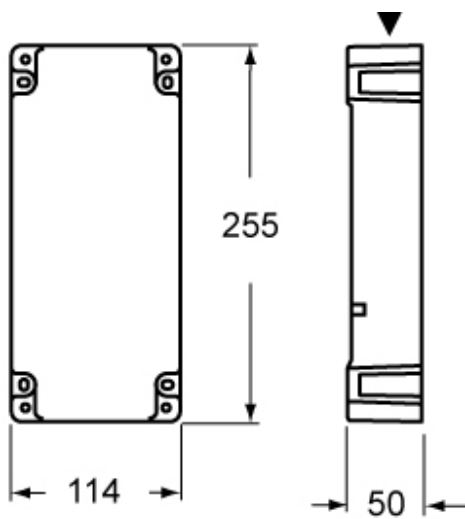

Notes

Dimensions shown in mm are not binding and may be changed without notice.
