

THIS COPY IS PROVIDED ON A RESTRICTED BASIS AND IS NOT TO BE USED IN ANY WAY DETRIMENTAL TO THE INTERESTS OF PANDUIT CORP.

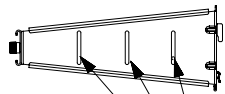

SLOTS FOR TYING OFF BUNDLES OF CABLES (BOTH SIDES)

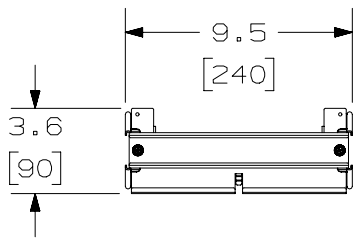
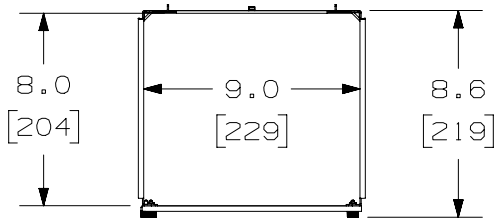
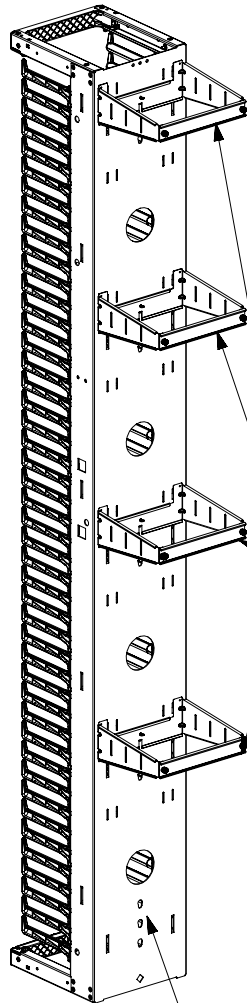

KIT CONTAINS (4) GATE ASSEMBLIES

PR2VF10 (SHOWN) OR PR2VF1096 (SOLD SEPARATELY)

NOTES:

1. VISIT OUR ON-LINE CATALOG AT WWW.PANDUIT.COM FOR A LIST OF CURRENT PARTS APPLICABLE FOR USE WITH THIS PRODUCT.
2. DIMENSIONS IN [] ARE METRIC.
3. ALL MATERIALS AND COMPONENTS USED MEET THE MATERIAL RESTRICTIONS OF RoHS (EUROPEAN DIRECTIVE 2011/65/EU ON THE RESTRICTION OF HAZARDOUS SUBSTANCES) AS PROPOSED BY THE RoHS TECHNICAL ADAPTATION COMMITTEE.
4. PART INCLUDES:
 - (4) 10" GATE ASSEMBLIES, WHICH INCLUDES GATE FRAME AND SWIVEL GATE
 - (4) #6-32 THUMB SCREWS
5. WEIGHT: 5.6 LBS. (2.5Kg) PER KIT

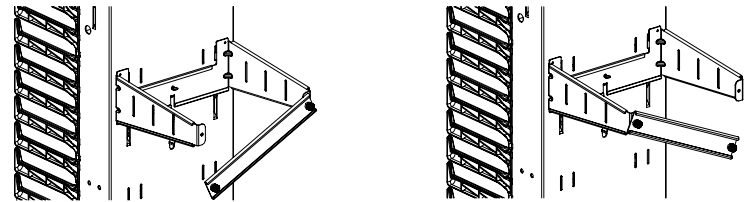

GATE OPENS FROM EITHER SIDE BY LOOSENING EITHER CAPTIVE SCREW

PART NUMBER		PR2VRGSK10		
TITLE		PR2V REAR GATE SYSTEM KIT		
ITEM REVISION NAME		CUSTOMER DRAWING		
DATASET FILE NAME		00422EAF/00		
MATERIAL		STEEL		
DRAWN BY		DATE	CHK	SCALE
BAME		5/14/19	KRKE	NONE
DRAWING NUMBER		00422EAF - DC		
SHEET 1 OF 1		A		

REV	DATE	BY	CHK	APR	DESCRIPTION	ECN
00	5/14/19	BAME	KRKE	JEFK	DRAWING RELEASED	

A-SIZE CUSTOMER