

## TERMINATION INSTRUCTIONS

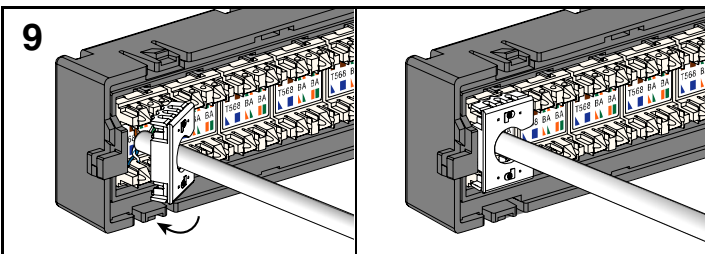
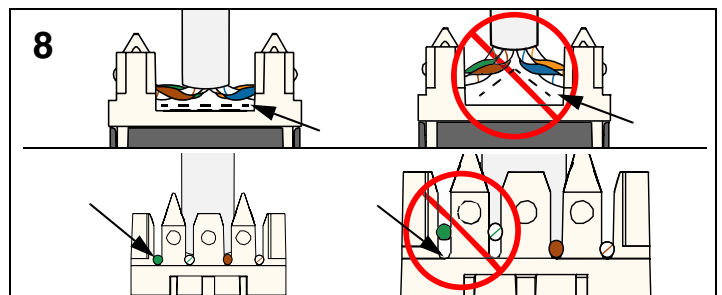
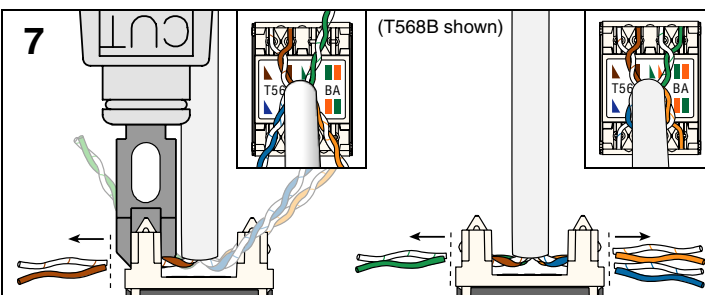
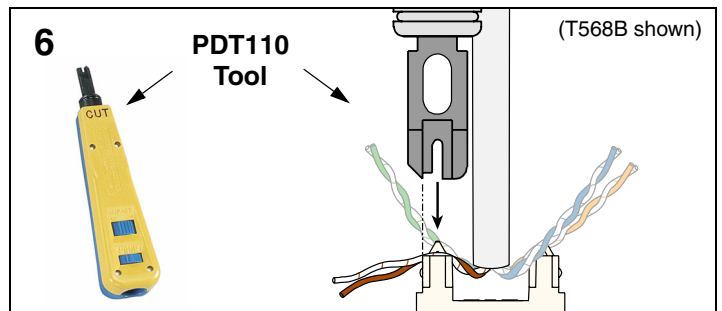
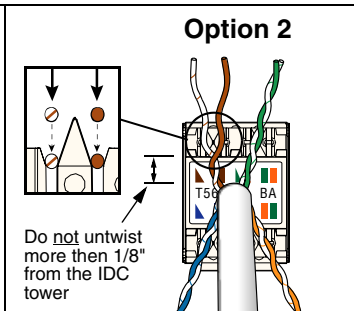
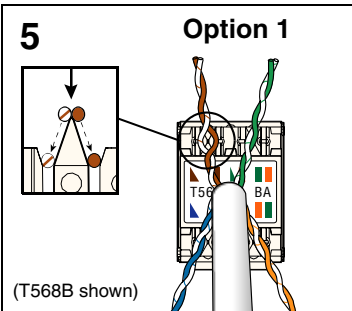
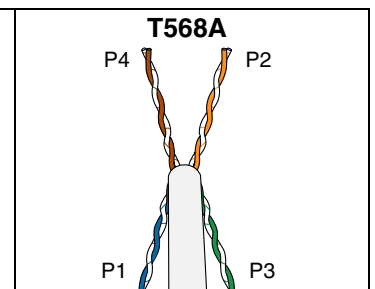
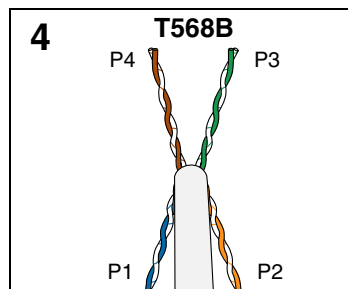
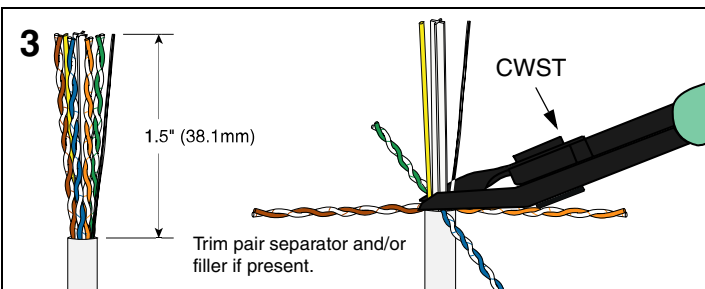

### Notes:

- For specified performance, follow TIA/EIA 568-B installation guidelines.
- Port Modules can terminate PVC or Plenum rated 22-26 AWG solid or stranded IWC cable with 0.048 inch (1.2 mm) maximum insulated conductor outside diameter.
- Port Modules may be re-terminated a minimum of 20 times.
- For technical and performance information, consult **PANDUIT** Technical Support.

As with all Communication Components, the following statements apply:

- Never install communications wiring during a lightning storm.
- Never install communications wiring in wet locations unless the port module is specifically designed for use in wet locations.
- Never touch uninsulated communications wiring or terminals unless the communication line has been disconnected at the network interface.
- Use caution when installing or modifying communication wiring.

For Instructions in Local Languages and Technical Support:

[www.panduit.com/resources/install\\_maintain.asp](http://www.panduit.com/resources/install_maintain.asp)